

2022 ANNUAL MEETING

**SSSR** Society for the  
Scientific Study of Religion



Religious Research  
Association **RRA**

BALTIMORE, MARYLAND | NOVEMBER 11-13, 2022



# RENAISSANCE BALTIMORE HARBORPLACE HOTEL FLOOR PLAN

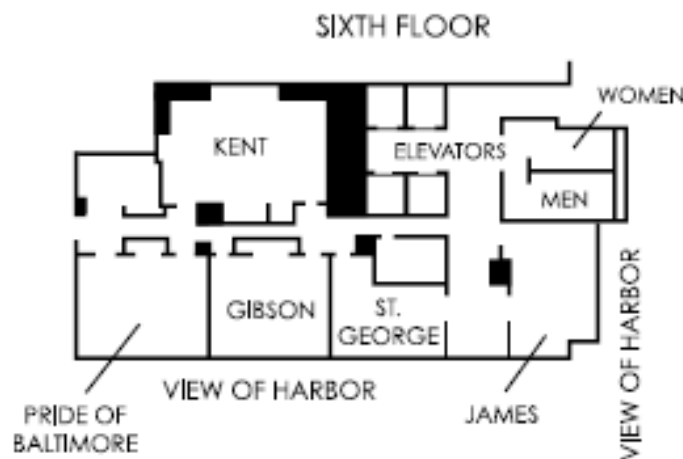
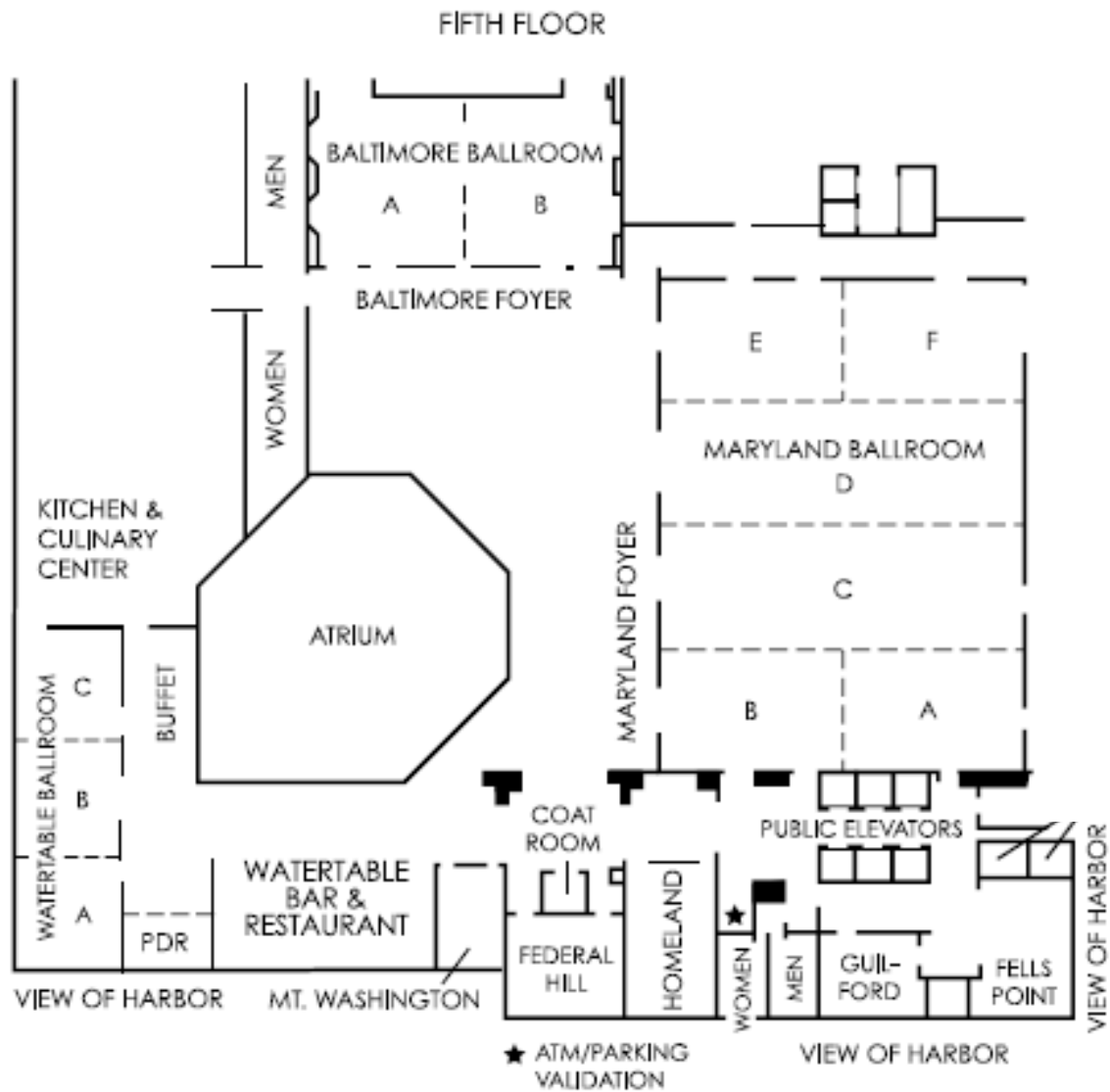



## **SSSR + RRA 2022 PROGRAM SCHEDULE**

SSSR PRESIDENT

**R. Khari Brown**

RRA PRESIDENT

**Melinda Lundquist Denton**

SSSR PROGRAM CHAIRS

**Paul Djupe  
Amy Erica Smith**

RRA PROGRAM CHAIR

**Cory Anderson**

SSSR EXECUTIVE OFFICER

**Karen Hutchison, CAE**

RRA EXECUTIVE OFFICER

**Gina Zurlo**

**@SSSR religion**

**@ReligResearch**

---

**#SSSR\_RRA22**

**Conference WiFi password: SSSR22**

# NOVA RELIGIO

THE JOURNAL OF ALTERNATIVE AND EMERGENT RELIGIONS



*Nova Religio* presents scholarly interpretations and examinations of emergent and alternative religious movements. Original research, perspectives on the study of new religions, literature reviews, and conference updates keep scholars well informed on a wide range of topics including: new religions; new movements within established religious traditions; neo-indigenous, neo-polytheistic and revival movements; ancient wisdom and New Age groups; diasporic religious movements; and marginalized and stigmatized religions.

## Editors:

Marie Dallum, Joseph Laycock,  
Catherine Wessinger, Benjamin E. Zeller  
ISSN: 1092-6690 / eISSN: 1541-8480  
Published: August, November, February, May



UNIVERSITY  
of CALIFORNIA  
PRESS

[online.ucpress.edu/nr](https://online.ucpress.edu/nr)

# PROGRAM OVERVIEW

## THURSDAY, NOVEMBER 10

11:00 am – 5:00 pm	SSSR Council Meeting	Federal Hill
1:00 pm – 5:00 pm	RRA Board of Directors Meeting	Mount Washington
5:30 pm – 7:30 pm	Registration Open	Maryland Foyer D
8:00 pm – 10:00 pm	Welcome Gathering	Ground Floor Café & Bar

## FRIDAY, NOVEMBER 11

7:30 am - 8:30 am	International Scholars Meet and Greet	Homeland
8:00 am – 8:50 am	RRA Business Meeting	Maryland B
8:00 am – 9:00 am	Morning Coffee, Sponsored by RRA	Maryland Foyer
8:30 am – 4:00 pm	Registration Open	Maryland Foyer D
9:00 am – 10:30 am	Paper Session A	
9:30 am – 5:45 pm	Book Exhibit	Maryland D
10:40 am – 12:10 pm	Paper Session B	
12:10 pm – 1:10 pm	Lunch Break	
12:10 pm - 1:10 pm	Mormon Social Sciences Association Meeting	Maryland E
1:10 pm – 2:40 pm	Paper Session C	
2:50 pm – 4:20 pm	Paper Session D	
4:30 pm – 5:30 pm	New Books Reception	Maryland D
4:30 pm – 5:30 pm	Graduate Student Session	Maryland E
6:00 pm – 7:00 pm	RRA Presidential Panel	Maryland C
7:00 pm – 8:00 pm	RRA Reception	Maryland Foyer
8:30 pm – 10:00 pm	Affinity Group and Research Network Meetings	St. George, Fells Point, Gibson, Federal Hill, Pride of Baltimore, Homeland, Guilford, and Kent

## SATURDAY, NOVEMBER 12

8:00 am – 8:50 am	SSSR Business Meeting	Homeland
8:00 am – 9:00 am	Morning Coffee, Sponsored by RRA	Maryland Foyer
8:30 am – 4:00 pm	Registration Open	Maryland Foyer D
9:00 am – 10:30 am	Paper Session E	
9:00 am – 3:00 pm	Book Exhibit	Maryland D
10:40 am – 12:10 pm	Paper Session F	
12:15 pm – 1:10 pm	Networking Lunch	Maryland Foyer
1:15 pm – 2:15 pm	SSSR Presidential Panel	Maryland C
2:20 pm – 3:50 pm	Paper Session G	
4:00 pm – 5:30 pm	Paper Session H	
5:45 pm – 7:00 pm	SSSR Awards & Presidential Address	Maryland C
7:00 pm – 9:00 pm	SSSR Presidential Reception	Maryland Foyer

## SUNDAY, NOVEMBER 13

8:00 am - 9:00 am	Coffee Hour for Interdisciplinary Researchers of Race and Religion	Guilford
8:00 am – 9:00 am	Morning Coffee, Sponsored by RRA	Maryland Foyer
8:30 am – 10:00 am	Registration Open	Maryland Foyer D
9:00 am – 10:30 am	Paper Session I	
10:40 am – 12:10 pm	Paper Session J	

# SSSR STUDENT PAPER AWARD

The SSSR Student Paper Awards recognize the best papers – published and unpublished – scheduled for presentation by students at the Annual Meeting. After students present their papers, they are eligible to apply for these awards, which will be presented at the following year's Annual Meeting. The awards include a plaque and \$500 for the winner of the published paper and \$500 for the winner of the unpublished paper.

**The winners of the 2022 Student Paper Awards will be announced at the SSSR Awards and Presidential Address on Saturday, November 12, 2022 at 5:45 p.m. in Maryland C.**

Nominations may be submitted through the SSSR website ([sssreligion.org](http://sssreligion.org)). Any current member of SSSR may nominate worthy student papers to the Student Paper Awards Committee. Students may also self-nominate.

More information about the Student Paper Award is available on the SSSR website.

## RECENT AWARDEES

- 2021** **Claire Gilliland** (University of North Carolina-Chapel Hill), *"Getting Permission to Break The Rules: Clergy Respond to LGBTQ Exclusion in the United Methodist Church"*
- 2020** **Michael Rotolo** (University of Notre Dame), *"Moral Religiosities: How Morality Structures Religious Understandings During the Transition to Adulthood."*
- 2019** **Laila H. Noureldin** (University of Chicago), *"American v Muslim? Religiosity as a Marker of Fragmented Identification among American Muslims."*
- 2018** **Di Di** (Rice University), *"Navigating Gender Norms: Gender Agency in Buddhist Temples in Mainland China and the US."*
- 2017** Not awarded due to a transition in the timing for the award.
- 2016** **Dane R. Mataic** (Pennsylvania State University), *"Spatial Diffusion of Governmental Restrictions on Religion"*
- 2015** **Grahm Hill** (University of California, Berkeley), *"Reclaiming the Secular: A Charismatic Christian Brotherhood's Interventions on Secularism in Mexico City."*
- 2014** **Landon Schnabel** (Indiana University), *"The Gender Pray Gap."*
- 2013** **Grad Fulton** (Duke University), *"Network Ties and Organizational Action: Explaining Variation in Social Service Provision among Congregations."*
- 2012** **Rachel Ellis** (University of Pennsylvania), *"Marketing to Whom? Desired Members and Jewish Denominational Niches, 1913-1920."*
- 2011** **Katie E. Corcoran, David Pettinicchio, and Blaine Robbins** (University of Washington), *"Religion and the Acceptability of White-Collar Crime: A Cross-National Analysis."*
- 2010** **Christopher A. Bail** (Harvard University), *"Terrified: Social Movements, Emotions, and the Collective Identity of Muslims in the US Media, 2001-2008."*

# FRIDAY

# NOVEMBER 11

8:00 am – 8:50 am	RRA Business Meeting	Maryland B
8:00 am – 9:00 am	Morning Coffee, Sponsored by RRA	Maryland Foyer
8:30 am – 4:00 pm	Registration Open	Maryland Foyer D
9:00 am – 10:30 am	Paper Session A	
9:30 am – 5:45 pm	Book Exhibit	Maryland D
10:40 am – 12:10 pm	Paper Session B	
12:10 pm – 1:10 pm	Lunch Break	
12:10 pm - 1:10 pm	Mormon Social Sciences Association Meeting	Maryland E
1:10 pm – 2:40 pm	Paper Session C	
2:50 pm – 4:20 pm	Paper Session D	
4:30 pm – 5:30 pm	New Books Reception	Maryland D
4:30 pm – 5:30 pm	Graduate Student Session	Maryland E
6:00 pm – 7:00 pm	RRA Presidential Panel	Maryland C
7:00 pm – 8:00 pm	RRA Reception	Maryland Foyer
8:30 pm – 10:00 pm	Affinity Group and Research Network Meetings	St. George, Fells Point, Gibson, Federal Hill, Pride of Baltimore, Homeland, Guilford, and Kent

## RRA BUSINESS MEETING **AGENDA**

Maryland B | Friday, November 11, 8:00 AM – 8:50 AM

### CALL TO ORDER

**PRESIDENT'S REPORT** | Melinda Denton

**TREASURER'S REPORT** | Matt Manion

**EXECUTIVE OFFICER'S REPORT** | Gina Zurlo

### COMMITTEE REPORTS

Awards Committee | Suzie Macaluso

Nominating Committee | Kristina Lizardy-Hajbi

Program Committee | Cory Anderson

Outstanding Applied Research Award Committee | Jennifer McClure

Publication Committee | Mark Killian

— Editor's Report | Kevin Flannelly

— Incoming Editor's Report | Patricia Snell Herzog

### OLD BUSINESS

RRA Virtual Events in 2022

### NEW BUSINESS

Welcoming New President, Elaine Howard Ecklund,  
and Program Chair, Brenton Kalinowski

RRA Virtual Events in 2023

RRR Member Recruitment

### ADJOURNMENT

# FRIDAY, NOVEMBER 11

9:00AM - 10:30AM

## PAPER SESSION A

### **A-1 SSSR: AUTHOR MEETS CRITICS - SITUATING SPIRITUALITY: CONTEXT, PRACTICE, AND POWER**

#### ► Room: Maryland E

ORGANIZER/CONVENER: Evan Stewart, University of Massachusetts Boston  
([evan.stewart@umb.edu](mailto:evan.stewart@umb.edu))

AUTHOR: Brian Steensland, Indiana University-Purdue University Indianapolis (IUPUI) ([bsteens@iupui.edu](mailto:bsteens@iupui.edu))

CO-AUTHOR 1: Jaime Kucinkas, Hamilton College

CO-AUTHOR 2: Anna Sun, Duke University

#### PANELISTS:

Nicolette Manglos-Weber, Boston University ([nmw1@bu.edu](mailto:nmw1@bu.edu))

Jacqui Frost, Purdue University ([jlfrost@purdue.edu](mailto:jlfrost@purdue.edu))

Erin Johnston, Duke University ([erin.johnston035@duke.edu](mailto:erin.johnston035@duke.edu))

Evan Stewart, University of Massachusetts Boston ([evan.stewart@umb.edu](mailto:evan.stewart@umb.edu))

### **A-2 SSSR: CONTINUITIES AND DISCONTINUITIES IN RELIGIOUS TRANSMISSION ACROSS GENERATIONS - PART I**

#### ► Room: Maryland A

ORGANIZER: Roberta Ricucci, University of Turin ([roberta.ricucci@unito.it](mailto:roberta.ricucci@unito.it))

CONVENER: Merril Silverstein, Syracuse University ([merrils@syr.edu](mailto:merrils@syr.edu))

#### ***Faith as a source of strength, but even more as responsibility - Continuities and Discontinuities across three generations in German families***

Christel Gärtner, University of Münster ([cgaertner@uni-muenster.de](mailto:cgaertner@uni-muenster.de))

#### ***Complexities in religious transmission - the case of Finland***

Kati Tervo-Niemelä, University of Eastern Finland ([kati.tervo-niemela@uef.fi](mailto:kati.tervo-niemela@uef.fi))

CO-AUTHOR 1: Jenni Spännäri, University of Eastern Finland

CO-AUTHOR 2: Laura Kallatsa, University of Eastern Finland

#### ***The hidden transmission of religion across generations: Evidence from the U.S.***

Merril Silverstein, Syracuse University ([merrils@syr.edu](mailto:merrils@syr.edu))

CO-AUTHOR 1: Joseph Blankholm, University of California at Santa Barbara

CO-AUTHOR 2: Dusty Hoesly, University of California at Santa Barbara

CO-AUTHOR 3: Maria Brown, Syracuse University

CO-AUTHOR 4: Woosang Hwang, Syracuse University

### **A-3 RRA: PANDEMIC INSIGHTS FROM THE FAITH COMMUNITIES TODAY PARTNERSHIP TEAM 1 (\*CLERGY DAY SESSION)**

#### ► Room: Maryland C

ORGANIZER/CONVENER: Scott Thumma, Hartford Institute for Religion Research  
([sthumma@hartfordinternational.edu](mailto:sthumma@hartfordinternational.edu))

#### ***Trends in the Pandemic Impact on the United Church of Christ***

Erica Dollhopf, Center for Analytics, Research & Development, and Data (CARD) United Church of Christ ([dollhopfe@ucc.org](mailto:dollhopfe@ucc.org))

#### ***Vital or Simply Viable?:***

#### ***Differences that Make Congregations Thrive and Grow***

Petr Cincala, Institute of Church Ministry Andrews University  
([cincala@andrews.edu](mailto:cincala@andrews.edu))

CO-AUTHOR: René Drumm, University of Southern Mississippi

#### ***Hope and Possibility: Insights for The Episcopal Church from FACT and EPIC Survey Data***

Molly James, Deputy Executive Officer of General Convention, The Episcopal Church ([mjames@episcopalchurch.org](mailto:mjames@episcopalchurch.org))

#### ***From Readiness to Recovery: The Role of Congregational Size in Response to the Pandemic.***

Scott Thumma, Hartford Institute for Religion Research  
([sthumma@hartfordinternational.edu](mailto:sthumma@hartfordinternational.edu))

### **A-4 SSSR: RELIGION AND COVID-19: STREET-LEVEL BUREAUCRATS, VACCINE UPTAKE, AND MISINFORMATION**

#### ► Room: St. George

ORGANIZER: Katie Corcoran, West Virginia University  
([kecorcoran@mail.wvu.edu](mailto:kecorcoran@mail.wvu.edu))

#### ***Pathways to immunity: Comparing patterns of excess death across the U.S. and within a closed religious community***

Rachel Stein, West Virginia University ([rachel.stein@mail.wvu.edu](mailto:rachel.stein@mail.wvu.edu))

CO-AUTHOR 1: Corey Colyer, West Virginia University

CO-AUTHOR 2: Annette Mackay, West Virginia University

#### ***Funeral Directors as Street-Level Bureaucrats of COVID-19 Mandates in Plain Communities: A Case Study of Amish Obituaries and Funeral Practices***

Katie Corcoran, West Virginia University ([kecorcoran@mail.wvu.edu](mailto:kecorcoran@mail.wvu.edu))

CO-AUTHOR 1: Rachel Stein, West Virginia University

CO-AUTHOR 2: Annette Mackay, West Virginia University

#### ***'God will protect us': Belief in God/Higher Power's Ability to Intervene and COVID-19 Vaccine Uptake***

Bernard DiGregorio, West Virginia University ([bdigreg@mix.wvu.edu](mailto:bdigreg@mix.wvu.edu))

CO-AUTHOR 1: Katie Corcoran, West Virginia University

CO-AUTHOR 2: Christopher Scheitle, West Virginia University

#### ***'Get All the Sunshine You Can': COVID-19 Misinformation among US Amish and Mennonite Communities***

Rachel Stein, West Virginia University ([rachel.stein@mail.wvu.edu](mailto:rachel.stein@mail.wvu.edu))

CO-AUTHOR 1: Corey Colyer, West Virginia University

CO-AUTHOR 2: Sara Guthrie, West Virginia University



**FRIDAY, NOVEMBER 11**

9:00AM - 10:30AM

**A-5 SSSR: BLACK AMERICANS AND FAITH TRAJECTORIES**

► **Room: Baltimore A**

CONVENER: Meredith Hope, College of Wooster (*mhope@wooster.edu*)

***Religious choices and racial centrality among Black emerging adults***

Meredith Hope, College of Wooster (*mhope@wooster.edu*)

CO-AUTHOR: Ryon Cobb, University of Georgia

***Networks of Black Faith:***

***Early Findings for a Study of Digital Black Religion***

Erika Gault, University of Arizona (*egault@email.arizona.edu*)

***From Incarceration to Imancipation:***

***Blackamerican Muslim Conversion and Reentry***

Laila Noureldin, The University of Chicago (*lhnoureldin@uchicago.edu*)

***Holistic Support for Black Youth through***

***Mental Health and Faith-Based Partnerships***

Janise Parker, William & Mary (*jparker@wm.edu*)

CO-AUTHOR: Natoya Haskins, William & Mary

**A-6 SSSR: APPLIED PHENOMENOLOGY: QUALITATIVE APPROACHES TO THE STUDY OF LIVED EXPERIENCE**

► **Room: Fells Point**

ORGANIZER: Nathan Scarbeck, University of Tennessee at Chattanooga (*zvz318@mocs.utc.edu*)

CONVENER: Ralph Hood, University of Tennessee at Chattanooga

(*ralph-hood@utc.edu*)

***S.I.X. Approaches to Interpersonal Tolerance***

Nathan Scarbeck, University of Tennessee at Chattanooga

(*zvz318@mocs.utc.edu*)

CO-AUTHOR 1: Matthew Durham, University of Tennessee at Chattanooga

CO-AUTHOR 2: Zachary Swanson, Claremont Graduate University

***The Structure of Philosophical Worldviews:***

***New Developments in the Qualitative Study of Worldview Beliefs***

Zachary Swanson, Claremont Graduate University

(*zachary.swanson.16@cnu.edu*)

CO-AUTHOR: Ralph Hood, University of Tennessee at Chattanooga

***Spirituality as a function of Religion? Perspectives on the role of religion across the religious and spiritual dichotomy.***

Christian Ishak, University of Tennessee at Chattanooga

(*gqc355@mocs.utc.edu*)

CO-AUTHOR 1: Zachary Swanson, Claremont Graduate University

CO-AUTHOR 2: Nathan Scarbeck, University of Tennessee at Chattanooga

***Harmony with the Universe: A Qualitative Analysis of the Phenomenology of Harmonious Experiences***

Spencer Baker, University of Tennessee at Chattanooga

(*ygp877@mocs.utc.edu*)

CO-AUTHOR 1: Jonathan Dinsmore, University of Tennessee at Chattanooga

CO-AUTHOR 2: Ralph Hood, University of Tennessee at Chattanooga

**A-7 SSSR: RELIGION AND PUBLIC HEALTH COMPLIANCE DURING THE PANDEMIC 1**

► **Room: Gibson**

CONVENER: Taylor Newton, Lenoir-Rhyne University (*taylor.newton@lr.edu*)

***Examining COVID-19 vaccine hesitancy in Ghana: The role of religion and misinformation***

Hannah Taylor-Abdulai, University of Cape Coast (*hbta30@gmail.com*)

***Do Religious People Adhere More or Less to COVID-19 Measures? Evidence on the Link between Religion and Adherence to Hygiene Rules/Vaccination among Immigrant and Native Youth in Germany***

Lena Arnold, PhD Student at the University of Mannheim; Researcher at the Mannheim Centre for European Social Research (MZES)

(*lena.arnold@mzes.uni-mannheim.de*)

CO-AUTHOR: Jörg Dollmann, Mannheim Centre for European Social Research (MZES), University of Mannheim; German Center for Integration and Migration Research (DeZIM)

***Religious affiliation, trust in faith community leaders and conspiracy suspicions as predictors of coronavirus vaccine hesitancy among UK residents during the COVID-19 pandemic, 2020- 21***

Siobhan McAndrew, Sheffield Methods Institute, University of Sheffield (*s.mcandrew@sheffield.ac.uk*)

CO-AUTHOR 1: Daniel Allington, Kings College London

CO-AUTHOR 2: Vivienne Moxham-Hall, Kings Policy Institute

***"Jesus is my vaccine": Attitudes toward the relationship between religion and science during the pandemic***

Taylor Newton, Lenoir-Rhyne University (*taylor.newton@lr.edu*)

**A-8 RRA: FAULTS OF THE FAITHFUL? RELIGIOUS DO-GOODERS DOING OTHERWISE**

► **Room: Federal Hill**

CONVENER: Cory Anderson, Pennsylvania State University (*cva5449@psu.edu*)

***The Noisy in the Land: Community Planning for the Amish + the Generators, Residential Industries, Truck Traffic, and Farm Animals They Bring***

Cory Anderson, Pennsylvania State University (*dr@coryanderson.org*)

***Tattoos and Religion***

Kevin Dougherty, Baylor University (*kevin\_dougherty@baylor.edu*)

CO-AUTHOR: Jerome Koch, Texas Tech University

***Getting it out there and making a difference! Sharing religious research findings in accessible ways to a broad variety of audiences.***

Lisa Oakley, University of Chester (*l.oakley@chester.ac.uk*)

CO-AUTHOR: Justin Humphreys, Thirtyone: eight

**FRIDAY, NOVEMBER 11**

9:00AM - 10:30AM

***What's in a Geographic Name? The Lack of Places in the Names of the Largest U.S. Megachurches and in the Churches in a Religious Suburb***

Brian Miller, Wheaton College ([brian.miller@wheaton.edu](mailto:brian.miller@wheaton.edu))

**A-9 SSSR: CLICK AND SEE!**

**DIGITAL TECHNOLOGY AND RELIGIOUS LIFE**

► **Room: Baltimore B**

ORGANIZER/CONVENER: Paul McClure, University of Lynchburg ([mcclure\\_pk@lynchburg.edu](mailto:mcclure_pk@lynchburg.edu))

***Undergraduate Digital Media Use and Religiosity at a Christian University***

Daniel Allen, Olivet Nazarene University ([daniel\\_allen1@baylor.edu](mailto:daniel_allen1@baylor.edu))

***Anti-vax Sentiment, Media, and a New Theory of Trust***

Jason Burt, Baylor University ([jason\\_burt1@baylor.edu](mailto:jason_burt1@baylor.edu))

***Religion and Religiosity: Lessons from Facebook Ads***

Pierre Hegy, Adelphi University ([pierre.hegy@gmail.com](mailto:pierre.hegy@gmail.com))

***Screen Time, Social Media, and Religious***

***Commitment among Adolescents***

Paul McClure, University of Lynchburg ([mcclure\\_pk@lynchburg.edu](mailto:mcclure_pk@lynchburg.edu))

CO-AUTHOR 1: Jeremy Uecker, Baylor University

CO-AUTHOR 2: Paul McClure, University of Lynchburg

**A-10 SSSR: FAITH COMMUNITIES MOBILIZING FOR IMMIGRANTS AND REFUGEES: GRASSROOTS PERSPECTIVES**

► **Room: Homeland**

ORGANIZER/CONVENER: Craig Beyerlein, University of Notre Dame ([kbeyer11@nd.edu](mailto:kbeyer11@nd.edu))

PANELISTS:

Fabian Arias, Pastor, St. Peter's Church, NYC ([neuquenedu@aol.com](mailto:neuquenedu@aol.com))

Leo Guardado, Fordham University ([lguardado@fordham.edu](mailto:lguardado@fordham.edu))

Rabbi Elissa Sachs-Kohen, Baltimore Hebrew Congregation ([eskohen@baltimorehebrew.org](mailto:eskohen@baltimorehebrew.org))

Rev. Cat Dodson Goodrich, Faith Presbyterian Baltimore ([catfaithchurchbalt@gmail.com](mailto:catfaithchurchbalt@gmail.com))

**A-11 SSSR: ENVIRONMENTAL POLITICS AND CLIMATE CHANGE**

► **Room: Pride of Baltimore**

CONVENER: Jason Pudlo, East Carolina University ([pudloj22@ecu.edu](mailto:pudloj22@ecu.edu))

***Climate-Based Initiatives at the Local Church Level: A qualitative approach with clergy and lay leaders in Philadelphia and Denver***

Marquisha Scott, University of Denver ([marquisha.scott@du.edu](mailto:marquisha.scott@du.edu))

***Eco-sisters: Gender, Power, and Climate Change Politics within the American Catholic Church***

Sabrina Danielsen, Creighton University ([sabrinadanielsen@creighton.edu](mailto:sabrinadanielsen@creighton.edu))

CO-AUTHOR: Ellie Simmons, Creighton University

***The role of faith in beliefs about climate change***

Joshua Alvarado, Pew Research Center ([jalvarado@pewresearch.org](mailto:jalvarado@pewresearch.org))

CO-AUTHOR: Becka Alper, Pew Research Center

***Clergy, Climate, and Crisis***

Jason Pudlo, East Carolina University ([pudloj22@ecu.edu](mailto:pudloj22@ecu.edu))

**A-12 SSSR: RELIGION, GENDER, AND POWER IN CONTEMPORARY CONTEXT**

► **Room: James**

ORGANIZER/CONVENER: Meredith Whitnah, Westmont College ([mwhitnah@westmont.edu](mailto:mwhitnah@westmont.edu))

***A Retrospective on 'Trailblazing' Female 'Pastors': Gender, Power, and Erasure in the US Catholic Church***

Tricia Bruce, University of Notre Dame ([tbruce@nd.edu](mailto:tbruce@nd.edu))

CO-AUTHOR: Jennifer Sherman, Georgetown University

***Gendered constructions of religious and national belonging among Latinx Evangelical Protestant Immigrants:***

***"Pero ante todo, Cristiana"***

Karen Michalka, University of Mary ([kmichalka@umary.edu](mailto:kmichalka@umary.edu))

***Strong Men and Starfish Stories:***

***Gender in American Antitrafficking Discourse***

Lisa Weaver-Swartz, Asbury University ([lswartz1@alumni.nd.edu](mailto:lswartz1@alumni.nd.edu))

***Evangelical Organizations' Responses to the #ChurchToo Movement***

Meredith Whitnah, Westmont College ([mwhitnah@westmont.edu](mailto:mwhitnah@westmont.edu))

**A-13 RRA: FLOURISHING CONGREGATIONS IN CANADA: CASE STUDY FINDINGS I**

► **Room: Guilford**

ORGANIZER/CONVENER: Joel Thiessen, Ambrose University ([jathiessen@ambrose.edu](mailto:jathiessen@ambrose.edu))

***Flourishing Atlantic Canadian Churches: Preliminary Findings***

Catherine Holtmann, University of New Brunswick ([cathy.holtmann@unb.ca](mailto:cathy.holtmann@unb.ca))

CO-AUTHOR 1: Stephen McMullin, Acadia University

CO-AUTHOR 2: Sam Reimer, Crandall University

***Looking for the Relevant Church of Tomorrow: The Experience of Two Quebec Urban Churches***

Frédéric Dejean, Université du Québec à Montréal ([dejean.frederic@uqam.ca](mailto:dejean.frederic@uqam.ca))

***Flourishing Interculturally: Congregant Differences as Contributors to Congregational Health***

Mark Chapman, Tyndale Seminary ([mchapman@tyndale.ca](mailto:mchapman@tyndale.ca))

CO-AUTHOR: James Watson, Tyndale Seminary

## BOOKS IN THE Religious Engagement in Democratic Politics SERIES



Nominated for the SSSR's Distinguished Book Award

### Islam, Justice, and Democracy

**SABRI CIFTCI**

Explores the connection between Muslim conceptions of justice and democratic orientations

30% conference discount  
for SSSR 22 attendees  
promo code: TREL22  
offer expires 1/1/2023

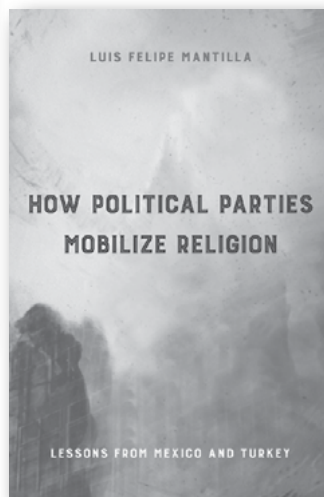

forthcoming 2023

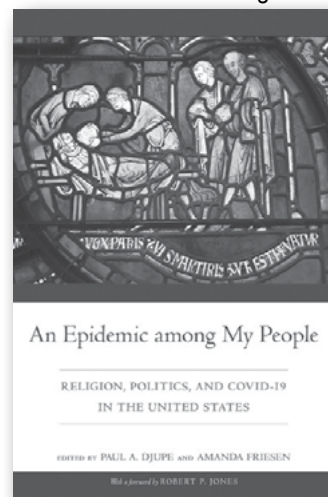

View more titles in the series  
@ **TUPRESS.TEMPLE.EDU**



## BOOK EXHIBIT

9:30 AM – 5:30 PM

Maryland D

# FRIDAY, NOVEMBER 11

10:40AM - 12:10PM

## PAPER SESSION B

### **B-1 SSSR: CONTINUITIES AND DISCONTINUITIES IN RELIGIOUS TRANSMISSION ACROSS GENERATIONS - PART II**

#### ► Room: Maryland A

ORGANIZER: Merrill Silverstein, Syracuse University ([merrills@syr.edu](mailto:merrills@syr.edu))

CONVENER: Kati Tervo-Niemelä, University of Eastern Finland ([kati.tervo-niemela@uef.fi](mailto:kati.tervo-niemela@uef.fi))

#### ***Bucking the Trend: Factors in the Successful Transmission of Religion across Generations in a Secular Canadian Society***

Peter Beyer, University of Ottawa ([pbeyer@uottawa.ca](mailto:pbeyer@uottawa.ca))

#### ***Debating religious socialization in Italy between changes and continuities***

Roberta Ricucci, University of Turin ([roberta.ricucci@unito.it](mailto:roberta.ricucci@unito.it))

CO-AUTHOR 1: Ferruccio Biolcati-Rinaldi, University of Milan

CO-AUTHOR 2: Renzo Carriero, University of Turin

CO-AUTHOR 3: Marcello Cabria, University of Turin

CO-AUTHOR 4: Giulia Marroccoli, University of Turin

CO-AUTHOR 5: Francesco Molteni, University of Turin

CO-AUTHOR 6: Luca Bossi, University of Turin

#### ***The role of grandparents in the transmission of religiosity in Hungary***

Gergely Rosta, Pázmány Péter Catholic University - Budapest Department ([rosta.gergely.laszlo@gmail.com](mailto:rosta.gergely.laszlo@gmail.com))

CO-AUTHOR: Zsuzsanna Szeptelszky, Pázmány Péter Catholic University - Budapest Department

### **B-2 RRA: PANDEMIC INSIGHTS FROM THE FAITH COMMUNITIES TODAY PARTNERSHIP TEAM 2**

#### (\*CLERGY DAY SESSION)

#### ► Room: Maryland C

ORGANIZER/CONVENER: Scott Thumma, Hartford Institute for Religion Research ([sthumma@hartfordinternational.edu](mailto:sthumma@hartfordinternational.edu))

#### ***The "New Traditional" in a Most Traditional Church: How the Pandemic Has Reshaped American Orthodox Christian Churches***

Alexei Krindatch, National Census of Orthodox Christian Churches

([akrindatch@aol.com](mailto:akrindatch@aol.com))

#### ***How Do Trends in Multisite, Church Planting, and Mergers Compare in the FACT 2020 Data?***

Warren Bird, SVP of Research and Equipping Evangelical Council Financial Accountability ([warren@ecfa.org](mailto:warren@ecfa.org))

#### ***Supplementing Budgets and Clergy Employment: A Comparison between Fact and Non-FACT PCUSA congregations 2000 to 2020.***

Susan Barnett, Research Services Presbyterian Church (U.S.A.)

([susan.barnett@pcusa.org](mailto:susan.barnett@pcusa.org))

### **B-3 SSSR: PARISH RESEARCH**

#### ► Room: St. George

ORGANIZER: Pierre Hegy, Adelphi University ([pierre.hegy@gmail.com](mailto:pierre.hegy@gmail.com))

#### ***The informal economy, incompetent leadership, and sexual scandal: A case study of a Catholic monastery in Latin America***

Paul Kasun, Universidad del Rosario, COLOMBIA ([frpaul@utexas.edu](mailto:frpaul@utexas.edu))

#### ***How do mixed institutions affect the transmission of clericalism? Continuing Developments***

Anthony Pogorelc, St. Mary's University, San Antonio ([apogorelc@stmarytx.edu](mailto:apogorelc@stmarytx.edu))

#### ***Between God and the State:***

#### ***How Catholics Make Moral Judgments in Authoritarian China***

Chit Wai John Mok, University of California, Irvine ([cwmok@uci.edu](mailto:cwmok@uci.edu))

#### ***The Mainline Online:***

#### ***Tracking Worship Participation - A Preliminary Analysis***

Christopher Suehr, Catholic University of America ([07suehr@cua.edu](mailto:07suehr@cua.edu))

### **B-4 SSSR: JOURNAL FOR THE SCIENTIFIC STUDY OF RELIGION: PLANS AND PROSPECTS**

#### ► Room: Watertable A

ORGANIZER/CONVENER: Korie Little Edwards, The Ohio State University ([edwards.623@osu.edu](mailto:edwards.623@osu.edu))

#### ***Vision for JSSR Growth and Impact***

Korie Little Edwards, The Ohio State University ([edwards.623@osu.edu](mailto:edwards.623@osu.edu))

#### ***Tricks of the Trade: Improving Publication Success***

Andrea Henderson, University of South Carolina

([akhender@mailbox.sc.edu](mailto:akhender@mailbox.sc.edu))

CO-AUTHOR: Aida Isela Ramos, John Brown University

#### ***A Smooth Ride: Navigating Scholar One and other tips***

Luther Young, The Ohio State University ([young.2734@buckeyemail.osu.edu](mailto:young.2734@buckeyemail.osu.edu))

### **B-5 SSSR: WHITHER THE "BLACK CHURCH"?**

#### ► Room: Baltimore A

CONVENER: Stephanie Boddie, Baylor University ([stephanie\\_boddie@baylor.edu](mailto:stephanie_boddie@baylor.edu))

#### ***Do THE WORK: Toward a Catholic Anti-Racism***

Tia Noelle Pratt, Villanova University ([tia.pratt@villanova.edu](mailto:tia.pratt@villanova.edu))

#### ***W.E.B. DuBois and Contesting "the Black Church"***

Roger Baumann, Hope College ([baumann@hope.edu](mailto:baumann@hope.edu))

**FRIDAY, NOVEMBER 11**

10:40AM - 12:10PM

***Food Charity, Food Justice, and Food Apartheid and the Black Church Food Security Network***

Stephanie Boddie, Baylor University ([stephanie\\_boddie@baylor.edu](mailto:stephanie_boddie@baylor.edu))

***The Role of Faith, Religion, and Spirituality in the BLM movement.***

Andre E. Johnson, University of Memphis ([ajohnsn6@memphis.edu](mailto:ajohnsn6@memphis.edu))

**B-6 SSSR: MUSLIM FAMILIES AND IDENTITY: PERSPECTIVES FROM NORTH AMERICA**

► **Room: Watertable C**

CONVENER: Aamir Jamal, University of Calgary ([aamir.jamal@ucalgary.ca](mailto:aamir.jamal@ucalgary.ca))

***Canadian Muslim Youth Identity: A Scoping Review of Literature***

Aamir Jamal, University of Calgary ([aamir.jamal@ucalgary.ca](mailto:aamir.jamal@ucalgary.ca))

CO-AUTHOR: Swati Dhingra, University of Calgary

***Comparison of Canadian Muslim and non-Muslim parents' voices on violent extremism***

Helal Hossain Dhali, McGill University ([helal.dhali@mail.mcgill.ca](mailto:helal.dhali@mail.mcgill.ca))

CO-AUTHOR 1: Maihemuti Dilimulati, McGill University

CO-AUTHOR 2: Ratna Ghosh, McGill University

***Needle in a Haystack - (Not) Finding Muslim Partnership***

Eman Abdelhadi, University of Chicago ([abdelhadi@uchicago.edu](mailto:abdelhadi@uchicago.edu))

***Stigmatized? American Muslim Advocates Crafting Public Images of Muslim-ness in the U.S.***

Valentina Cantori, University of Southern California ([cantori@usc.edu](mailto:cantori@usc.edu))

**B-7 SSSR: SETTLER COLONIALISM AND THE BOOK OF MORMON**

► **Room: Fells Point**

ORGANIZER/CONVENER: Thomas Murphy, Edmonds College ([thomaswmurphy90@gmail.com](mailto:thomaswmurphy90@gmail.com))

***Who Decides if The Book of Mormon Can be Decolonial?***

Jared Hickman, John Hopkins University ([jhickman@jhu.edu](mailto:jhickman@jhu.edu))

***An Insufficient Canon: The Popol Wuj, the Book of Mormon, and Other Scriptures***

Thomas Murphy, Edmonds College ([thomaswmurphy90@gmail.com](mailto:thomaswmurphy90@gmail.com))

**B-8 SSSR: RELIGION AND PUBLIC HEALTH COMPLIANCE DURING THE PANDEMIC 2**

► **Room: Gibson**

CONVENER: Yaakov Ariel, University of North Carolina ([yariel@email.unc.edu](mailto:yariel@email.unc.edu))

***Orthodox Jews and COVID-19 Vaccination: Lessons for the Future***

Ephraim Shapiro, Ariel University ([eas97@caa.columbia.edu](mailto:eas97@caa.columbia.edu))

CO-AUTHOR 1: Lee Caplan, Morehouse School of Medicine

CO-AUTHOR 2: Mendel Singer, Case Western Reserve University

***The Role of Sociopolitical, Religious, and Personality Factors in Vaccine Uptake and Hesitancy: Implications for Public Health Approaches***

Tess Starman, Howard University ([t.e.starman@icloud.com](mailto:t.e.starman@icloud.com))

CO-AUTHOR 1: Ronald Hopson, Howard University

***Piety, Pandemic, and Struggles:***

***The Reaction of Jewish Orthodox Groups to the Pandemic***

Yaakov Ariel, The University of North Carolina at Chapel Hill

([yariel@email.unc.edu](mailto:yariel@email.unc.edu))

***Did Religious Freedom Exacerbate Covid? A Global Analysis***

Nilay Saiya, Nanyang Technological University ([nilay.saiya@ntu.edu.sg](mailto:nilay.saiya@ntu.edu.sg))

**B-9 SSSR + RRA: EFFECTIVE RESEARCH TECHNIQUES FOR RECONCEPTUALIZING SOCIAL AND RELIGIOUS TRENDS**

► **Room: Federal Hill**

CONVENER: Christine Baker, (Sisters of Charity Foundation of Cleveland)

***Development and Psychometric Evaluation of the Bowen Family Systems Scale for Congregations***

Joseph Stewart-Sicking, Loyola University Maryland

([jastewartsticking@loyola.edu](mailto:jastewartsticking@loyola.edu))

CO-AUTHOR: Barbara Laymon, The Bowen Center

***Understanding and Evaluating Service as Modeled by Sisters: Implications for Sisters, Lay Partners and their Ministries***

Christine Baker, Sisters of Charity Foundation of Cleveland

([cbaker@socfcleveland.org](mailto:cbaker@socfcleveland.org))

CO-AUTHOR: Kathryn Racine, MLC Group

***Open Science using Registered Report format***

Kevin Ladd, Indiana University South Bend ([kladd@iu.edu](mailto:kladd@iu.edu))

CO-AUTHOR 1: Ward Davis, Wheaton College

**B-10 SSSR: WHAT IT MEANS TO BE "NONE OF THE ABOVE"**

► **Room: Baltimore B**

CONVENER: Janelle Wong, University of Maryland ([janellew@umd.edu](mailto:janellew@umd.edu))

***Religious Residue? The Impact of Childhood Affiliation on Religiosity among Nones***

Nadia Beider, Hebrew University ([nadia.beider@mail.huji.ac.il](mailto:nadia.beider@mail.huji.ac.il))

***The role of 'choice' in non-believing older adults' narratives of parenting.***

Joanna Malone, University of York ([joanna.malone@york.ac.uk](mailto:joanna.malone@york.ac.uk))

***Experiences of Discrimination Against Atheists and Joining Organized Secularism***

Nic Frame, Purdue University ([nframe@purdue.edu](mailto:nframe@purdue.edu))

**FRIDAY, NOVEMBER 11**

10:40AM - 12:10PM

***The Role of Race in Political Attitudes Among the Religiously Unidentified***

Janelle Wong, University of Maryland ([janellw@umd.edu](mailto:janellw@umd.edu))

CO-AUTHOR: Je St. Sume, University of Maryland

**B-11 SSSR: CONSTRUCTING AND DECONSTRUCTING EVANGELICALISM**

► **Room: Pride of Baltimore**

CONVENER: Andrew Chalfoun, UCLA ([achalfoun@g.ucla.edu](mailto:achalfoun@g.ucla.edu))

***Scriptural Authority in Interaction:***

***The Case of an Evangelical Call-In Radio Show***

Andrew Chalfoun, UCLA ([achalfoun@g.ucla.edu](mailto:achalfoun@g.ucla.edu))

***Faith Maturity and Personal Devotion:***

***A Longitudinal Study of Protestant Evangelical Youth***

Chang-ho Ji, La Sierra University ([cji@lasierra.edu](mailto:cji@lasierra.edu))

CO-AUTHOR 1: Shirley-Ann Thomas, La Sierra University

CO-AUTHOR 2: Enze Zhang, La Sierra University

***On the Relationship between Evangelicalism and Rural Identity***

James Kirk, University of Notre Dame ([jameskirk.14.14@gmail.com](mailto:jameskirk.14.14@gmail.com))

CO-AUTHOR: Levi Allen, University of Notre Dame

**B-12 SSSR: POLITICS OF RACE, GENDER, AND RELIGION IN EMERGING ADULTHOOD**

► **Room: Homeland**

ORGANIZER/CONVENER: Hannah Evans, Hartford Institute for Religion Research ([hevans@hartfordinternational.edu](mailto:hevans@hartfordinternational.edu))

***Black Christian Millennials at the Nexus of "Unapologetic" & "Unashamed"***

Shaonta Allen, Dartmouth College ([shaonta.allen@dartmouth.edu](mailto:shaonta.allen@dartmouth.edu))

***Understanding Secularization among White Millennials***

Hannah Evans, Hartford Institute for Religion Research

([hevans@hartfordinternational.edu](mailto:hevans@hartfordinternational.edu))

***An Intersectional Analysis of Faith & Feminism***

Amanda Hernandez, Baylor University ([amanda\\_hernandez4@baylor.edu](mailto:amanda_hernandez4@baylor.edu))

**B-13 SSSR: CLERGY HEALTH AND WELL-BEING: INSIGHTS FROM THE CLERGY HEALTH INITIATIVE**

► **Room: Maryland B**

ORGANIZER: Erin Johnston, Duke University ([erin.johnston1@duke.edu](mailto:erin.johnston1@duke.edu))

CONVENER: David Eagle, Duke University ([david.eagle@duke.edu](mailto:david.eagle@duke.edu))

***Evaluating the Levels and Predictors of Clergy Obesity in the United States***

David Eagle, Duke University ([david.eagle@duke.edu](mailto:david.eagle@duke.edu))

CO-AUTHOR: Anna Holleman, Duke University

***Changes in United Methodist Clergy Well-Being Pre- and Post-pandemic: Individual and Aggregate Level Changes from a Panel Study of North Carolina Clergy***

Rae Jean Proeschold-Bell, Duke University ([rae.jean@duke.edu](mailto:rae.jean@duke.edu))

CO-AUTHOR: Logan Tice, Duke University

***Does Ministry Promote Obesity? Examining the Weight Trajectories of United Methodist Clergy***

Josh Gaghan, Duke University ([joshua.gaghan@duke.edu](mailto:joshua.gaghan@duke.edu))

***Pastoring in a Pandemic: Supports Used and Desired by United Methodist Clergy in the Early Period of the COVID-19 Pandemic***

Erin Johnston, Duke University ([erin.johnston1@duke.edu](mailto:erin.johnston1@duke.edu))

CO-AUTHOR: Jennifer Headley, Duke University

**B-14 SSSR CHANGING VALUES AND ORTHODOX CHRISTIANITY IN EASTERN EUROPE**

► **Room: Watertable B**

CONVENER: Laura Olson, Clemson University ([laurao@clemson.edu](mailto:laurao@clemson.edu))

***The Narratives of the Holy and Sovereignty: A Political-theology Reading of the Russian Orthodox Church in the Ukraine War***

Yan Liu, Dr. ([75liu@cua.edu](mailto:75liu@cua.edu))

***Transnational Patriarchal Norms in Russia and the United States***

Andy Bunnell, University of Washington ([abunnell@uw.edu](mailto:abunnell@uw.edu))

***The Serbian Orthodox Church as a Transnational Political Actor: A Case Study of Regime Change in Montenegro***

Dunja Arandjelovic, Clemson University ([arandjelovicd96@gmail.com](mailto:arandjelovicd96@gmail.com))

CO-AUTHOR: Laura Olson, Clemson University

***Patriarchal Loyalties and Western Values among Orthodox Christians in Eastern Europe: A Comparative Analysis***

Laura Olson, Clemson University ([laurao@clemson.edu](mailto:laurao@clemson.edu))

CO-AUTHOR 1: Dunja Arandjelovic, Clemson University

CO-AUTHOR 2: Marko Vekovic, University of Belgrade

**B-15 RRA: FLOURISHING CONGREGATIONS IN CANADA: CASE STUDY FINDINGS II**

► **Room: Guilford**

ORGANIZER: Joel Thiessen, Ambrose University ([jathiessen@ambrose.edu](mailto:jathiessen@ambrose.edu))

CONVENER: Catherine Holtmann, University of New Brunswick

([cathy.holtmann@unb.ca](mailto:cathy.holtmann@unb.ca))

***Repertoires of Resilience: An Additional Domain of Flourishing?***

Katie Steeves, Trinity Western University ([katie.steeves@twu.ca](mailto:katie.steeves@twu.ca))

CO-AUTHOR 1: Jason Burt, Trinity Western University

CO-AUTHOR 2: Michael Wilkinson, Trinity Western University

***Volunteering in Congregations:***

***Organizational Strain and Resilience in a Pandemic***

Joel Thiessen, Ambrose University ([jathiessen@ambrose.edu](mailto:jathiessen@ambrose.edu))

**FRIDAY, NOVEMBER 11**

10:40AM - 12:10PM

***Spiritual Formation of Congregants:***

***What Does Spiritual Growth Look Like in a Pandemic Time?***

Arch Wong, Ambrose University ([awong@ambrose.edu](mailto:awong@ambrose.edu))

**B-16 SSSR: AUTHOR MEETS CRITICS - GOD, GRADES,  
AND GRADUATION: RELIGION'S SURPRISING IMPACT ON  
ACADEMIC SUCCESS**

► **Room: Maryland E**

ORGANIZER/CONVENER: Rhys Williams, Sociology, Loyola University Chicago  
([rwilliams7@luc.edu](mailto:rwilliams7@luc.edu))

AUTHOR: Ilana Horwitz, Jewish Studies and Sociology, Tulane Univ.  
([ihorwitz@tulane.edu](mailto:ihorwitz@tulane.edu))

PANELISTS:

Richard Pitt, Sociology-University of California, San Diego ([rpitt@ucsd.edu](mailto:rpitt@ucsd.edu))

Tim Clydesdale, Sociology, The College of New Jersey ([clydesda@tcnj.edu](mailto:clydesda@tcnj.edu))

Carol Ann MacGregor, St. Jerome's - University of Waterloo

([carolann.macgregor@uwaterloo.ca](mailto:carolann.macgregor@uwaterloo.ca))

Rhys Williams, Loyola University Chicago ([rwilliams7@luc.edu](mailto:rwilliams7@luc.edu))

**MORMON SOCIAL SCIENCE ASSOCIATION MEETING**

Friday, November 11 | 12:10 PM - 1:10 PM | Maryland E

**LUNCH BREAK**

12:10 - 1:10 PM

# FRIDAY, NOVEMBER 11

1:10PM - 2:40PM

PAPER SESSION C

## **C-1 RRA: THE 2020 U.S. RELIGION CENSUS: EXPANDING TRADITIONAL UNDERSTANDINGS OF U.S. RELIGIOSITY**

### ► Room: Maryland C

ORGANIZER: Clifford Grammich, U. S. Religion Census  
([usreligioncensus@gmail.com](mailto:usreligioncensus@gmail.com))

#### ***The U.S. Religion Census: Efforts to Expand***

Rich Houseal, Church of the Nazarene Research Center  
([rhouseal@nazarene.org](mailto:rhouseal@nazarene.org))

CO-AUTHOR: Clifford Grammich, U.S. Religion Census

#### ***My Religious Tradition's Buffet of Gelatinous Fare: The Art of Bounding and Enumerating 100+ Conservative and Plain Anabaptist "Groups"***

Cory Anderson, Amish and Plain Anabaptist Studies Association  
([editor@amishstudies.org](mailto:editor@amishstudies.org))

#### ***Orthodox Christian Churches in the USA: What Happened between 2010 and 2020?***

Alexei Krindatch, National Census of Orthodox Christian Churches  
([akrindatch@aol.com](mailto:akrindatch@aol.com))

## **C-2 SSSR: RESOURCES AND INTERVENTION PROGRAMS FOR CHRISTIAN CLERGY DURING TIMES OF PANDEMIC AND RACIAL STRIFE**

### ► Room: St. George

ORGANIZER: Rae Jean Proeschold-Bell, Duke University ([rae.jean@duke.edu](mailto:rae.jean@duke.edu))  
CONVENER: Logan Tice, Duke University ([logan.tice@duke.edu](mailto:logan.tice@duke.edu))

#### ***When the truth does not set free: Christian responses to Wrongful Convictions***

Michal Meulenberg, Fuller Theological Seminary  
([michal.meulenberg@gmail.com](mailto:michal.meulenberg@gmail.com))

#### ***The Selah study: 3 stress-management interventions for clergy***

Rae Jean Proeschold-Bell, Duke University ([rae.jean@duke.edu](mailto:rae.jean@duke.edu))  
CO-AUTHOR 1: David Eagle, Duke University  
CO-AUTHOR 2: Jia Yao, Duke University

#### ***Thriving in Ministry***

Jacqueline Madison-McCreary, Lott Carey Foreign Mission Society  
([jemm2@comcast.net](mailto:jemm2@comcast.net))

CO-AUTHOR: David Emmanuel Goatley, Duke Divinity School

#### ***Funding Care for Clergy: Sources of Funding and Distribution of Resources in the Field of Clergy Caregiving***

Rev. Dr. Thad Austin, Duke Divinity School ([taustin@duke.edu](mailto:taustin@duke.edu))  
CO-AUTHOR: Dr. Katherine Comeau, Duke Divinity School

## **C-3 SSSR: PROFESSIONAL DEVELOPMENT PANEL: PUBLISHING ARTICLES**

### ► Room: Watertable A

ORGANIZER/CONVENER: Esther Chan, University of Wisconsin-Milwaukee  
([chane@uwm.edu](mailto:chane@uwm.edu))

#### PARTICIPANTS:

Korie Edwards, Ohio State University ([edwards.623@osu.edu](mailto:edwards.623@osu.edu))

Joseph Baker, East Tennessee State University ([bakerjo@mail.etsu.edu](mailto:bakerjo@mail.etsu.edu))

Timothy O'Brien, University of Wisconsin-Milwaukee ([obrien34@uwm.edu](mailto:obrien34@uwm.edu))

Jacqui Frost, Purdue University ([jifrost@purdue.edu](mailto:jifrost@purdue.edu))

## **C-4 SSSR: RACE, RELIGION, AND ELECTIONS**

### ► Room: Baltimore A

CONVENER: Prema Kurien, Syracuse University ([pkurien@syr.edu](mailto:pkurien@syr.edu))

#### ***Latino Protestants in America and Their Politics: Statistical Evidence from the 2016 and 2020 Presidential Elections***

Gerardo Martí, Davidson College ([gemarti@davidson.edu](mailto:gemarti@davidson.edu))  
CO-AUTHOR: Brandon C. Martinez, Providence College

#### ***Social Location and Religious, Racial, and Political Group Threats***

Jerry Park, Baylor University ([jerry\\_park@baylor.edu](mailto:jerry_park@baylor.edu))  
CO-AUTHOR: Timothy Lauve-Moon, Baylor University

#### ***Evangelicalism and Racial Politics among US Latina/os***

Kenneth Vaughan, University of Central Oklahoma  
([kenneth.r.vaughan@uconn.edu](mailto:kenneth.r.vaughan@uconn.edu))  
CO-AUTHOR: Christopher Pieper, Baylor University

#### ***Race, Religion and South Asian American Voters in the 2020 U.S. Elections***

Prema Kurien, Syracuse University ([pkurien@syr.edu](mailto:pkurien@syr.edu))

## **C-5 SSSR: THE CHANGING CATHOLIC CHURCH**

### ► Room: Watertable C

CONVENER: Pierre Hegy, Adelphi University ([pierre.hegy@gmail.com](mailto:pierre.hegy@gmail.com))

#### ***A Local Revival of Catholic Devotionalism***

Pierre Hegy, Adelphi University, Garden City, NY ([pierre.hegy@gmail.com](mailto:pierre.hegy@gmail.com))

#### ***Understanding and Addressing the Intersection of Spiritual Struggles and Clergy Sexual Abuse in the Roman Catholic Church in Baltimore***

Joseph Stewart-Sicking, Loyola University Maryland  
([jastewartsicking@loyola.edu](mailto:jastewartsicking@loyola.edu))

CO-AUTHOR 1: Gina Magyar-Russell, Loyola University Maryland

CO-AUTHOR 2: Jill Snodgrass, Loyola University Maryland



**FRIDAY, NOVEMBER 11**

1:10PM - 2:40PM

***Analysis of worries: changes and challenges for Catholic Urban Parishes in Latin America***

Jesús Antonio Serrano, Universidad Católica Lumen Gentium (México)  
([info@pastoralurbana.info](mailto:info@pastoralurbana.info))

**C-6 SSSR: CHURCHES AND THE COVID-19 PANDEMIC**

► **Room: Gibson**

CONVENER: Amanda Wilson Harper, Baylor University  
([amandawilsonharper@gmail.com](mailto:amandawilsonharper@gmail.com))

***Changes in Coping Among US Congregations and Houses of Worship During the COVID-19 Pandemic***

Amanda Wilson Harper, Tarleton State University  
([amandawilsonharper@gmail.com](mailto:amandawilsonharper@gmail.com))

CO-AUTHOR: Aynsley Sheffert, Baylor University

***Christian Identity Construction amid Covid-19: A Case Study of the Evangelical Lutheran Church in Jerusalem***

Felicity Apaah, University of Ghana ([feliabraham@yahoo.com](mailto:feliabraham@yahoo.com))

CO-AUTHOR: E. Okelloh Ogera, St. Paul's University, Kenya

***US Megachurch Response to COVID-19 Pandemic***

George Soroka, Harvard University ([soroka@fas.harvard.edu](mailto:soroka@fas.harvard.edu))

***A New Context for Congregational Change due to the COVID-19 Pandemic***

Tim Snyder, Wesley Seminary ([tsnyder@wesleyseminary.edu](mailto:tsnyder@wesleyseminary.edu))

CO-AUTHOR: Deborah Coe, Wesley Theological Seminary

**C-7 RRA: HOW RELIGIOUS LEADERS ARE RESPONDING TO COVID-19 AND INCREASED CALLS FOR RACIAL JUSTICE (\*CLERGY DAY SESSION)**

► **Room: Federal Hill**

ORGANIZER: Elaine Ecklund, Rice University ([ehe@rice.edu](mailto:ehe@rice.edu))

***Religious Neutrality:***

***How Churches (fail to) Address COVID-19 and Racism***

Oneya Okuwobi, Rice University ([of@rice.edu](mailto:of@rice.edu))

CO-AUTHOR 1: Brenton Kalinowski, Rice University

CO-AUTHOR 2: Denise Daniels, Wheaton College

***The Effects of the COVID-19 Pandemic on Religious Meanings of Work***

Brenton Kalinowski, Rice University ([bkalinowski@rice.edu](mailto:bkalinowski@rice.edu))

CO-AUTHOR 1: Elaine Ecklund, Rice University

CO-AUTHOR 2: Denise Daniels, Wheaton College

***Pastor Burnout, Wellbeing, and Authority during COVID-19***

Brenton Kalinowski, Rice University ([bkalinowski@rice.edu](mailto:bkalinowski@rice.edu))

CO-AUTHOR: Elaine Ecklund, Rice University

**C-8 SSSR: LOSING RELIGION**

► **Room: Baltimore B**

CONVENER: David Campbell, University of Notre Dame ([dave\\_campbell@nd.edu](mailto:dave_campbell@nd.edu))

***Broadened Horizons, Disillusionment, and the***

***Skeptic's Triad: A Fluid Model of Transitions to Atheism Based on Confirmatory Coding***

Joseph Langston, Ohio University ([langston1029@gmail.com](mailto:langston1029@gmail.com))

***Becoming Non-believers: Understanding Atheism in Childhood***

Anna Strhan, University of York ([anna.strhan@york.ac.uk](mailto:anna.strhan@york.ac.uk))

CO-AUTHOR 1: Rachael Shillitoe, University of Birmingham

CO-AUTHOR 2: Lois Lee, University of Kent

***Lost Lutherans: Updates on the Apostates after Covid***

Christopher Suehr, Catholic University/ELCA ([cjsuehr@gmail.com](mailto:cjsuehr@gmail.com))

***The Secular Surge Continues:***

***How COVID Has Amplified The Growth of Secularism in America***

David Campbell, University of Notre Dame ([dave\\_campbell@nd.edu](mailto:dave_campbell@nd.edu))

CO-AUTHOR 1: Geoffrey Layman, University of Notre Dame

CO-AUTHOR 2: John Green, University of Akron

**C-9 SSSR: CHURCHES IN SOCIETY**

► **Room: Pride of Baltimore**

CONVENER: Janel Kragt Bakker, Memphis Seminary

([jbakker@memphisseminary.edu](mailto:jbakker@memphisseminary.edu))

***Faith at the Intersection of Ferguson and Racial Justice***

Leah Gunning Francis, Vice President for Academic Affairs,

Christian Theological Seminary ([lgunningfrancis@cts.edu](mailto:lgunningfrancis@cts.edu))

***Moral foundations in congregation-community partnerships***

Katherine R. Cooper, DePaul University ([kcooperm@depaul.edu](mailto:kcooperm@depaul.edu))

CO-AUTHOR: Lynn O. Cooper, Wheaton College

***Repairing Harm: Cross-Case Analysis of Efforts Among Dutch and American Christians to Reckon with Sullied Legacies***

Janel Kragt Bakker, Memphis Theological Seminary

([jbakker@memphisseminary.edu](mailto:jbakker@memphisseminary.edu))

**C-10 SSSR: CATHOLICS AND POLITICS**

► **Room: Homeland**

CONVENER: James Guth, Furman University ([jim.guth@furman.edu](mailto:jim.guth@furman.edu))

***The Catholic Archdiocese of San Antonio and Desegregation, 1941-1969***

Mark Newman, University of Edinburgh ([m.newman@ed.ac.uk](mailto:m.newman@ed.ac.uk))

***The Economic and Cultural Basis of Catholic Partisanship***

James Guth, Furman University ([jim.guth@furman.edu](mailto:jim.guth@furman.edu))

***Pro-immigrant or anti-immigrant: Political party holds more influence than religious teaching for Catholics***

Diane Beckman, University of Massachusetts Boston

([diane.beckman001@umb.edu](mailto:diane.beckman001@umb.edu))

***Catholic Church Elites and Political Cues in American Politics***

James Kirk, University of Notre Dame ([jameskirk.14.14@gmail.com](mailto:jameskirk.14.14@gmail.com))

**FRIDAY, NOVEMBER 11**

1:10PM - 2:40PM

**C-11 SSSR: HEALTH AND SPIRITUALITY:  
RECIPROCAL AND MODERATING RELATIONSHIPS**

► **Room: Maryland B**

CONVENER: Blake Kent, Westmont College ([bkent@westmont.edu](mailto:bkent@westmont.edu))

***Do Religious/Spiritual Factors Moderate the Effect of Suffering on Religious/Spiritual Struggles? A Prospective Longitudinal Study***

Blake Kent, Westmont College ([bkent@westmont.edu](mailto:bkent@westmont.edu))

CO-AUTHOR 1: Richard Cowden, Harvard University

CO-AUTHOR 2: Victor Counted, Western Sydney University

***Moderating Effect of Religious Problem Solving in the Relationship between Religious Orientation and the Mental Health of Marriage Immigrant Christian Women in Korea***

Changhoon Seog, Sunmoon University, Republic of Korea

([chseog@sunmoon.ac.kr](mailto:chseog@sunmoon.ac.kr))

***Religious Service Attendance and Depressive Symptoms: Exploring the Reciprocal and Gendered Relationship from Adolescence to Early Adulthood***

Johannah Palomo, University of North Carolina at Chapel Hill

([johannah@email.unc.edu](mailto:johannah@email.unc.edu))

***The stress-moderating effect of religious/spiritual beliefs in retirement: A pro-health effect that is not readily 'modelled away'***

Gerard Rainville, AARP ([chuck.rainville@gmail.com](mailto:chuck.rainville@gmail.com))

CO-AUTHOR: Laura Mehegan, AARP

**C-12 SSSR: IT'S THE END OF THE WORLD AS WE KNOW IT:  
RELIGIOUS BELIEFS AND PRACTICES OF ADVENTIST CHURCH MEMBERS**

► **Room: Mount Washington**

ORGANIZER: Karl Bailey, Andrews University ([kgbailey@andrews.edu](mailto:kgbailey@andrews.edu))

CONVENER: Duane McBride, Andrews University ([mcbride@andrews.edu](mailto:mcbride@andrews.edu))

***Here and Hereafter: An Overview of the Beliefs and Religious Practices in a Global Sample of Adventist Church Members***

Karl Bailey, Andrews University ([kgbailey@andrews.edu](mailto:kgbailey@andrews.edu))

CO-AUTHOR 1: Duane McBride, Andrews University

CO-AUTHOR 2: Shannon Trecartin, Andrews University

CO-AUTHOR 3: David Trim, General Conference of Seventh-day

Adventists--Archives, Statistics, and Research

***Are We Justified by the Means?***

***Seventh-day Adventist Eschatology and Health Beliefs***

René Drumm, University of Southern Mississippi ([rene.drumm@usm.edu](mailto:rene.drumm@usm.edu))

CO-AUTHOR: Petr Cincala, Andrews University

***Correlates of Legalism in a Global Sample of Seventh-day Adventists***

Duane McBride, Andrews University ([mcbride@andrews.edu](mailto:mcbride@andrews.edu))

CO-AUTHOR 1: Alina Baltazar, Andrews University

CO-AUTHOR 2: David Trim, General Conference of Seventh-day

Adventists--Archives, Statistics, and Research

CO-AUTHOR 3: Shannon Trecartin, Andrews University

CO-AUTHOR 4: Karl Bailey, Andrews University

***Not a Needy Person Among Them:***

***A Network Analysis of Prosocial and Religious Behaviors***

Karl Bailey, Andrews University ([kgbailey@andrews.edu](mailto:kgbailey@andrews.edu))

CO-AUTHOR 1: Duane McBride, Andrews University

CO-AUTHOR 2: Zoe Shiu, Andrews University

CO-AUTHOR 3: Shannon Trecartin, Andrews University

**C-13 SSSR: RELIGIOUS EXPERIENCE AND SPIRITUALITY**

► **Room: James**

CONVENER: James Spickard, University of Redlands

([jim\\_spickard@redlands.edu](mailto:jim_spickard@redlands.edu))

***Three Phenomenologies of Ritual Experience: Time, Play, Embodiment***

James Spickard, University of Redlands ([jim\\_spickard@redlands.edu](mailto:jim_spickard@redlands.edu))

***"Tech Us How to Pray": The Power of Christian Prayer Apps***

Rory Jones, Baylor ([rory\\_jones@baylor.edu](mailto:rory_jones@baylor.edu))

***Associations of beliefs about meditation with response to mindfulness-based cognitive therapy***

Roman Palitsky, Brown University ([roman\\_palitsky@brown.edu](mailto:roman_palitsky@brown.edu))

CO-AUTHOR 1: Holly Levin-Aspenson, Brown University

CO-AUTHOR 2: Willoughby Britton, Brown University

***On Religious Experience: Bridging Death and Awe***

Kendra Holt Moore, Bethany College ([holtmoorekm@bethanylb.edu](mailto:holtmoorekm@bethanylb.edu))

**C-14 SSSR: AUTHOR MEETS CRITICS - TAKING AMERICA BACK FOR GOD: CHRISTIAN NATIONALISM IN THE UNITED STATES**

► **Room: Kent**

ORGANIZER/CONVENER: Kelsy Burke, University of Nebraska-Lincoln

([kburke@unl.edu](mailto:kburke@unl.edu))

AUTHOR: Andrew Whitehead,

Indiana University-Purdue University Indianapolis ([aw122@iu.edu](mailto:aw122@iu.edu))

CO-AUTHOR: Samuel Perry, University of Oklahoma

PANELISTS:

Damon Mayrl, Colby College ([dwmayrl@colby.edu](mailto:dwmayrl@colby.edu))

Jack Delehanty, Clark University ([jdelehanty@clarku.edu](mailto:jdelehanty@clarku.edu))

Evan Stewart, University of Massachusetts Boston ([evan.stewart@umb.edu](mailto:evan.stewart@umb.edu))

Ruth Braunstein, University of Connecticut ([ruth.braunstein@uconn.edu](mailto:ruth.braunstein@uconn.edu))

**C-15 RRA: CHALLENGES AT ALL LEVELS:  
RELIGIOUS INSTITUTIONS RESPOND AND ADAPT**

► **Room: Guilford**

CONVENER: Lisa Oakley, University of Chester ([l.oakley@chester.ac.uk](mailto:l.oakley@chester.ac.uk))

***Chameleon church: Challenges faced and solutions created in response to COVID-19 in the UK***

Lisa Oakley, University of Chester ([l.oakley@chester.ac.uk](mailto:l.oakley@chester.ac.uk))

CO-AUTHOR: Moira Lafferty, University of Chester

**FRIDAY, NOVEMBER 11**

1:10PM - 2:40PM

***Alternative Models to Finance Catholic School Education in the U.S.: An Empirical Analysis***

Stephen Porth, Saint Joseph's University,  
Villanova Center for Church Management ([sporth@sju.edu](mailto:sporth@sju.edu))

***How Did Church Planting Change During the Pandemic (Based on More than 2100 Churches Studied)?***

Warren Bird, ECFA (Evangelical Council for Financial Accountability)  
([warren@ecfa.org](mailto:warren@ecfa.org))

***Leading Innovation for Adaptive Challenges in the Church***

Joshua Orndorff, James Madison University ([orndorjr@dukes.jmu.edu](mailto:orndorjr@dukes.jmu.edu))

**C-16 SSSR: MORMONS CONFRONTING MODERNITY: UNDERSTANDING MEMBERS AND FORMER MEMBERS OF THE CHURCH OF JESUS CHRIST OF LATTER-DAY SAINTS**

► **Room: Maryland E**

ORGANIZER: Jana Riess, Religion News Service ([riess.jana@gmail.com](mailto:riess.jana@gmail.com))

***What Can Big Data Tell Us About Latter-day Saints?***

John Hoffmann, BYU ([john\\_hoffmann@byu.edu](mailto:john_hoffmann@byu.edu))

***The Role of Ex-Mormon Online Communities in the Disaffiliation Process***

Jana Riess, Religion News Service ([riess.jana@gmail.com](mailto:riess.jana@gmail.com))

CO-AUTHOR: Benjamin Knoll, Senior Survey Strategist, APQC

***Canceling Taco Tuesday?: Reactionary Mormons' Struggle with the Scope of Religious Authority***

Spencer Greenhalgh, School of Information Science, University of Kentucky  
([spencer.greenhalgh@uky.edu](mailto:spencer.greenhalgh@uky.edu))

CO-AUTHOR: Amy L. Chapman, Teachers College, Columbia University

**C-17 SSSR: MIXED-METHODS STUDY OF CHANGE IN RELIGIOSITY, SPIRITUALITY AND WORLDVIEW**

► **Room: Maryland A**

ORGANIZER/CONVENER: Zhuo Job Chen, University of North Carolina, Charlotte  
([job.chen@unc.edu](mailto:job.chen@unc.edu))

***A Common Core? Ideographic and Nomothetic Evidence for Mystical Experience in Relationship to Religious Styles & Type***

Ralph W. Hood, Jr., University of Tennessee at Chattanooga  
([ralph-hood@utc.edu](mailto:ralph-hood@utc.edu))

***Mystical Experiences and Self-identified Spirituality—Longitudinal Perspective on Mutual Effects***

Heinz Streib, Bielefeld University ([hstreib@online.de](mailto:hstreib@online.de))

CO-AUTHOR: Zhuo Job Chen, University of North Carolina, Charlotte

***Autobiographical Reasoning as a Means to Capture (Religious) Narrative Identity over the Lifespan***

Ramona Bullik, Bielefeld University ([ramona.bullik@uni-bielefeld.de](mailto:ramona.bullik@uni-bielefeld.de))

CO-AUTHOR 1: Anika Steppacher, Bielefeld University

CO-AUTHOR 2: Matthew Durham, University of Tennessee at Chattanooga

***Framing subjective religiosities and worldviews in Faith Development Interviews in Germany and the US: Master- and alternative narratives and what does Oprah say?***

Barbara Keller, Bielefeld University ([barbara.keller@uni-bielefeld.de](mailto:barbara.keller@uni-bielefeld.de))

CO-AUTHOR 1: Anika Steppacher, Bielefeld University

CO-AUTHOR 2: William Andrews, University of Tennessee at Chattanooga

# FRIDAY, NOVEMBER 11

2:50PM - 4:20PM

## PAPER SESSION D

### **D-1 SSSR: NOVEL DATASETS AND METHODS FOR STUDYING SECULARIZATION AND RELIGIOUS CHANGE**

► **Room: Maryland A**

ORGANIZER: Rachel Bacon, Center for Mind and Culture  
([rbacon@mindandculture.org](mailto:rbacon@mindandculture.org))

***The harmonization method in the study of religiosity and secularization. Presentation of Dataset of Integrated Measures of Religion (DIM-R). Possible applications and analyses.***

Łukasz Kiszkiel, Society & Cognition Unit, University of Białystok  
([lukaszkiziel@gmail.com](mailto:lukaszkiziel@gmail.com))

CO-AUTHOR 1: Piotr Laskowski, Society & Cognition Unit, University of Białystok  
CO-AUTHOR 2: David Voas, University College London

***Modelling fuzzy fidelity: using agent-based modelling to identify the causal factors underlying secularisation***

Konrad Talmont-Kaminski, Society & Cognition Unit, University of Białystok  
([k.talmontkaminski@gmail.com](mailto:k.talmontkaminski@gmail.com))

***Building a Multiple-Dimension Database of Religiosity Measures for the Modeling Religious Change Project***

Rachel Bacon, Center for Mind and Culture ([rbacon@mindandculture.org](mailto:rbacon@mindandculture.org))  
CO-AUTHOR 1: Wesley Wildman, Boston University  
CO-AUTHOR 2: Gina Zurlo, Gordon Conwell

***Dynamics of Sects and Secularization: An agent-based approach***

Annetta Burger, Agent-Based Modeling Lab, New York University  
([agb9206@nyu.edu](mailto:agb9206@nyu.edu))

CO-AUTHOR 1: Erez Hatna, Agent-Based Modeling Lab, New York University  
CO-AUTHOR 2: Joshua Epstein, Agent-Based Modeling Lab, New York University

### **D-2 SSSR: VIRAL POLITICS: AFRICAN MEGACHURCHES IN THE YEAR 2020**

► **Room: St. George**

ORGANIZER: Abimbola Adelakun, University of Texas, Austin  
([adelakun@austin.utexas.edu](mailto:adelakun@austin.utexas.edu))  
CONVENER: Afe Adogame, Princeton Seminary ([afe.adogame@ptsem.edu](mailto:afe.adogame@ptsem.edu))

***The Politics of Faith in Ghanaian Megachurches: Pandemic Response and Social Action in the Public Sphere***

Felicity Apaah, University of Ghana, Legon ([feliabraham44@yahoo.com](mailto:feliabraham44@yahoo.com))  
CO-AUTHOR: Allison Norton, Hartford Institute for Religion Research at Hartford International University

***Powered by Conviction: Women of Faith and Public Theologians Navigating Ministry and the Quest for Social Justice During the Covid 19 Pandemic in Kenya***

Damaris Parsitau, Egerton University ([dparsitau@yahoo.com](mailto:dparsitau@yahoo.com))  
CO-AUTHOR: Okello Okera, Egerton University

***Transnational Politics of Power: Nigerian Megachurches and the Quest for Sacred-Secular Politics***

Abimbola Adelakun, University of Texas at Austin ([adelakun@austin.utexas.edu](mailto:adelakun@austin.utexas.edu))  
CO-AUTHOR 1: Dodeye Williams, University of Calabar, Nigeria  
CO-AUTHOR 2: Olannike Ogunnowo, University of Ibadan

***Religion and patriarchy: A case of female subjugation in Africa***

Hannah Taylor-Abdulai, University of Cape Coast  
([hannah.taylor-abdulai@ucc.edu.gh](mailto:hannah.taylor-abdulai@ucc.edu.gh))  
CO-AUTHOR 1: Stella Owusu Afari, Church of Pentecost and Ghana Education Service  
CO-AUTHOR 2: Eric Koka, University of Cape Coast

### **D-3 SSSR: PANDEMIC, POWER, AND RACE**

► **Room: Baltimore A**

CONVENER: Andrew Franklin, Norfolk State University ([asfranklin@nsu.edu](mailto:asfranklin@nsu.edu))

***Trusted Partnerships: Religious Leaders and Public Health Experts Together Address Racial Inequities in Covid-19 Vaccine Trials and Distribution***

Lawrence Whitney, National Museum of American History, Smithsonian Institution; Center for Mind & Culture ([lawrence.whitney.lc@gmail.com](mailto:lawrence.whitney.lc@gmail.com))

***How We Got Over: Black Churches and Resiliency during the Covid-19 Pandemic***

Monika Gosin, College of William & Mary ([mngosin@wm.edu](mailto:mngosin@wm.edu))

***Ways to Give: Black Church Giving During the Pandemic***

Stephanie Boddie, Baylor University ([stephanie\\_boddie@baylor.edu](mailto:stephanie_boddie@baylor.edu))

***Assessing Religious Differences During A Pandemic***

Andrew Franklin, Norfolk State University ([asfranklin@nsu.edu](mailto:asfranklin@nsu.edu))

### **D-4 SPIRITUALITY, RELIGION, AND THE COVID-19 PANDEMIC**

► **Room: Gibson**

CONVENER: Tatsushi Hirono, Austin Peay State University  
([hironot@apsu.edu](mailto:hironot@apsu.edu))

***How did COVID-19 change peoples' spirituality and religiosity among Japanese American, Japanese, and Japanese Religious Leaders?***

Tatsushi Hirono, Austin Peay State University ([hironot@apsu.edu](mailto:hironot@apsu.edu))  
CO-AUTHOR 1: Yukan Ogawa, Taisho University  
CO-AUTHOR 2: Akinori Takase, Taisho University

***Coping with the Pandemic: A Comparative Analysis of Different Faith Groups in Bangladesh***

Shantanu Majumder, Professor, Department of Political Science, University of Dhaka, Bangladesh ([shantanu.m@du.ac.bd](mailto:shantanu.m@du.ac.bd))

**FRIDAY, NOVEMBER 11**

2:50PM - 4:20PM

***Religious affiliation and support for inclusive COVID-19 policies:  
The importance of broader social context***

Christopher Seto, The Pennsylvania State University ([chs37@psu.edu](mailto:chs37@psu.edu))  
CO-AUTHOR: Selena Ortiz, The Pennsylvania State University

**D-5 RRA: READY OR NOT, RELIGIOUS DEVOTEES  
CONFRONT BIG PICTURE PROBLEMS**

► **Room: Federal Hill**

CONVENER: Albert Herzog, Retired ([herzoga3@gmail.com](mailto:herzoga3@gmail.com))

***Putin's War and the Vatican's Dilemma: Another Chapter  
in the Contours of Christianity and Secularization***

Albert Herzog, Retired ([herzoga3@gmail.com](mailto:herzoga3@gmail.com))

***Sunday Morning Social Constructions of  
Racial Problems and Solutions***

Lisa Pearce, University of North Carolina at Chapel Hill ([ldpearce@unc.edu](mailto:ldpearce@unc.edu))  
CO-AUTHOR: Korie Edwards, Ohio State University

***Domestic and Family Violence:***

***Responses and Approaches across the Australian Churches***

Ruth Powell, NCLS Research/Charles Sturt University ([rpowell@ncls.org.au](mailto:rpowell@ncls.org.au))  
CO-AUTHOR: Miriam Pepper, NCLS Research/Charles Sturt University

***Ready or Not: White Mainline Congregations Confess  
Wide Spectrum of Readiness to Discuss and Challenge  
Race and Racism***

Anthony Scott, Rocky Mountain Conference of the United Church of Christ  
([anthony@rmcucc.org](mailto:anthony@rmcucc.org))

**D-6 SSSR: SOCIAL CONTEXT, SOCIAL RELATIONSHIPS,  
AND THE SOCIOLOGY OF RELIGION AND SCIENCE**

► **Room: Baltimore B**

ORGANIZER: Elaine Ecklund, Rice University ([ehel@rice.edu](mailto:ehel@rice.edu))

***Discussions about Science and Religion on Social Media***

Eszter Hargittai, University of Zurich ([eszter.hargittai@uzh.ch](mailto:eszter.hargittai@uzh.ch))  
CO-AUTHOR: Will Marler, University of Zurich

***Religious Identities, Perceptions of Scientists' Moral Values, and  
Appreciation of Science in the United States***

Timothy O'Brien, University of Wisconsin Milwaukee ([obrien34@uwm.edu](mailto:obrien34@uwm.edu))  
CO-AUTHOR: Shiri Noy, Denison University

***Questions of Truth, Questions of Trust: Specifying Connections  
between Religiosity, Christian Nationalism, Political Ideology,  
and Views on Science and Scientists***

Christopher Scheitle, West Virginia University ([cpscheitle@mail.wvu.edu](mailto:cpscheitle@mail.wvu.edu))  
CO-AUTHOR 1: Katie Corcoran, West Virginia University  
CO-AUTHOR 2: Bernard DiGregorio, West Virginia University

***Remaking Networks, Re-establishing Authority: Negotiating  
Islam and Science within a Western Muslim-Minority Context***

Stephen Jones, University of Birmingham ([s.h.jones@bham.ac.uk](mailto:s.h.jones@bham.ac.uk))  
CO-AUTHOR 1: Saleema Burney, University of Birmingham  
CO-AUTHOR 2: Riyaz Timol, Cardiff University

***The Roots of Mental Health: Interrogating the Intersections  
Between Perceptions of Religion and Science, Race-ethnicity,  
and Gender in Explaining Mental Illness***

Bianca Mabute-Louie, Rice University ([bml@rice.edu](mailto:bml@rice.edu))  
CO-AUTHOR 1: Daniel Bolger, Rice University  
CO-AUTHOR 2: Andrea Henderson, University of South Carolina  
CO-AUTHOR 3: Elaine Ecklund, Rice University

**D-7 SSSR+RRA: JIM DAVIDSON'S LIFE  
AND LEGACY AT RRA/SSSR**

► **Room: Pride of Baltimore**

ORGANIZER/CONVENER: Mary Gautier, Center for Applied Research  
in the Apostolate ([gautierm@georgetown.edu](mailto:gautierm@georgetown.edu))

***Jim's Catholic Generational Categories***

Patricia Wittberg, Center for Applied Research in the Apostolate  
([pwittber@iupui.edu](mailto:pwittber@iupui.edu))

***Jim Davidson as a Mentor***

Anthony Pogorelc, U. S. Province of Sulpician Fathers ([ajppss04@gmail.com](mailto:ajppss04@gmail.com))

***Jim's Development of the Sociology of Religion  
Program at Purdue University***

Roger Finke, Penn State University ([rfinke@psu.edu](mailto:rfinke@psu.edu))

***Jim's Emphasis of the Importance of "Both/And" in Research***

Rachel Kraus, Ball State University ([rmkraus@bsu.edu](mailto:rmkraus@bsu.edu))

***Jim's Emphasis of the Micro, Meso, and  
Macro Theoretical Approach***

Deborah Coe, Compass Consulting and Research ([debcoe619@gmail.com](mailto:debcoe619@gmail.com))

***Jim's Care for His Subject and His Students***

Kevin Dougherty, Baylor University ([kevin\\_dougherty@baylor.edu](mailto:kevin_dougherty@baylor.edu))

**D-8 SSSR: RELIGIOUS LEADERS AND POLITICS**

► **Room: Homeland**

CONVENER: Joseph Roso, Duke University ([joseph.roso@duke.edu](mailto:joseph.roso@duke.edu))

***Preaching Hot Topics During the Pandemic: Abortion, Gun  
Violence, Environment***

Leah Schade, Lexington Theological Seminary ([lschade@lextheo.edu](mailto:lschade@lextheo.edu))  
CO-AUTHOR 1: Amanda Wilson Harper, Tarleton State University  
CO-AUTHOR 2: Wayne Thompson, Carthage College

***Theological Differences and Clergy Activism***

Joseph Roso, Duke University ([joseph.roso@duke.edu](mailto:joseph.roso@duke.edu))  
CO-AUTHOR: Mark Chaves, Duke University

***Strategic Talk in Religious Contexts:***

***Evidence from Protestant Pastors in North Carolina***

Stephanie Shady, The University of North Carolina at Chapel Hill  
([stephns@live.unc.edu](mailto:stephns@live.unc.edu))

**FRIDAY, NOVEMBER 11**

2:50PM - 4:20PM

***Women's Ordination, LGBTQ+ Inclusion, and White Supremacy: How Oppositional Shifts Shaped the Southern Baptist Convention and the Alliance of Baptists in the United States***

Andrew Gardner, Hartford Institute for Religion Research  
([andrew.b.gardner@alumni.wfu.edu](mailto:andrew.b.gardner@alumni.wfu.edu))

CO-AUTHOR: Gerardo Marti, Davidson College

**D-9 SSSR: SEXUALITY, RELATIONSHIPS, AND RELIGIOSITY**

► **Room: Watertable B**

CONVENER: Samuel Perry, University of Oklahoma ([samperry@ou.edu](mailto:samperry@ou.edu))

***"Desperate Times Call for Desperate Measures": The Role of Pornography in the Negotiation of Christians' Sexual and Religious Identities***

Cindy Mays, University of Nebraska - Lincoln ([cmays5@huskers.unl.edu](mailto:cmays5@huskers.unl.edu))

***Differential links between relational attachment, religiosity & spirituality, and psychological well-being by race and gender***

Meredith Hope, College of Wooster ([mhope@wooster.edu](mailto:mhope@wooster.edu))

CO-AUTHOR: Logan Kochendorfer, Rockhurst University

***Sacred Submissives?***

***Complementarianism in Sexual Behaviors and Outcomes***

Elizabeth McElroy, University of Oklahoma ([elizabeth.mcelroy@ou.edu](mailto:elizabeth.mcelroy@ou.edu))

CO-AUTHOR: Samuel Perry, University of Oklahoma

***"I can go off and then pray later about that:"***

***The relationship between spirituality and racism in Black same-gender-loving men's lives***

Jonathan Mathias Lassiter, Rowan University ([lassiter@rowan.edu](mailto:lassiter@rowan.edu))

CO-AUTHOR 1: Kaina Anwar, Rowan University

CO-AUTHOR 2: Ashley Foye, Rowan University

**D-10 SSSR: DISCRIMINATION AGAINST RELIGIOUS MINORITIES**

► **Room: James**

CONVENER: Dane Mataic, North Dakota State University ([dane.mataic@ndsu.edu](mailto:dane.mataic@ndsu.edu))

***The Making of Christian Persecution: Quantifying and Amplifying Religious Persecution in International Religious Freedom Advocacy***

Miray Philips, University of Minnesota ([phili191@umn.edu](mailto:phili191@umn.edu))

***Beyond labour market status: How do religious minorities fare in the British labour market once job quality is taken into account?***

Samir Sweida-Metwally, University of Bristol

([samir.sweida-metwally@bristol.ac.uk](mailto:samir.sweida-metwally@bristol.ac.uk))

***Threat and Global Religious Violence: Cultural Threat and the Rise of Societal Discrimination Targeting Religious Minorities***

Dane Mataic, North Dakota State University ([dane.mataic@ndsu.edu](mailto:dane.mataic@ndsu.edu))

CO-AUTHOR: Roger Finke, The Pennsylvania State University

***The partial secularisms of Singapore's Muslim minorities: Arbitrating model citizenship and (in)complete selves at the margins***

Orlando Woods, Singapore Management University  
([orlandowoods@smu.edu.sg](mailto:orlandowoods@smu.edu.sg))

CO-AUTHOR: Lily Kong, Singapore Management University

**D-11 RRA: INTO THE MINDS OF RELIGIOUS MASTERS: WHAT ARE OUR LEADERS THINKING?**

► **Room: Guilford**

CONVENER: Kati Tervo-Niemelä, University of Eastern Finland  
([kati.tervo-niemela@uef.fi](mailto:kati.tervo-niemela@uef.fi))

***The Value of Organisational Culture to Understanding Church Life***

Sam Sterland, NCLS Research, Australia ([sssterland@ncls.org.au](mailto:sssterland@ncls.org.au))

***PC(USA) Minister Study***

Susan Barnett, PCUSA ([susan.barnett@pcusa.org](mailto:susan.barnett@pcusa.org))

CO-AUTHOR: Jashalund Royston, PC(USA) Research Services

***COVID-19 and Clergy Work Wellbeing under Pressure: A Longitudinal Study of Work Wellbeing Among the Clergy in Evangelical Lutheran Church of Finland***

Kati Tervo-Niemelä, University of Eastern Finland ([kati.tervo-niemela@uef.fi](mailto:kati.tervo-niemela@uef.fi))

**D-12 RRA: THE 2020 U.S. RELIGION CENSUS: BROAD IMPLICATIONS FOR CLERGY (\*CLERGY DAY SESSION)**

► **Room: Maryland C**

ORGANIZER/CONVENER: Clifford Grammich, U.S. Religion Census  
([usreligioncensus@gmail.com](mailto:usreligioncensus@gmail.com))

***Evangelical and Mainline Protestants in the U.S. Religion Census***

Rich Houseal, Church of the Nazarene Research Center  
([rhouseal@nazarene.org](mailto:rhouseal@nazarene.org))

***Catholics in the U.S. Religion Census***

Clifford Grammich, USReligionCensus@gmail.com  
([usreligioncensus@gmail.com](mailto:usreligioncensus@gmail.com))

***Interpreting USRC Data on Adherents***

Erica Dollhopf, United Church of Christ Center for Analytics, Research & Development, and Data ([dollhopfe@ucc.org](mailto:dollhopfe@ucc.org))

***What Do My Neighbors Believe? Using the U.S. Religion Census to Better Understand My Community***

Dale Jones, U.S. Religion Census ([megalodaleia@gmail.com](mailto:megalodaleia@gmail.com))

# NEW BOOKS RECEPTION

FRIDAY, NOVEMBER 11 : 4:30 PM - 5:30 PM

Maryland D

The New Books Reception is an opportunity to showcase new work in the scientific study of religion.

## AUTHORS

**ABIMBOLA A. ADELAKUN**

*Powerful Devices: Prayer and the Political Praxis of Spiritual Warfare*  
(Rutgers University Press, 2022)

**THAD AUSTIN**

*Caring for Clergy: Understanding a Disconnected Network of Providers*  
(Wipf & Stock Publishers, 2022)

**JOSEPH BLANKHOLM**

*The Secular Paradox*  
(NYU Press, 2022)

**SABRI CIFTCI**

*Islam, Justice, and Democracy*  
(Temple University Press, 2021)

**PETR CINCALA**

*Mending Ministries on Their Wellness Journey*  
(AdventSource in collaboration with the Institute of Church Ministry, 2022)

**VIRGINIA GARRARD**

*New Faces of God in Latin America: Emerging Forms of Vernacular Christianity*  
(Oxford University Press, 2020)

**ERIKA GAULT**

*Networking the Black Church*  
(NYU Press, 2022)

**ILANA M. HORWITZ**

*God, Grades, and Graduation: Religion's Surprising Impact on Academic Success*  
(Oxford University Press, 2021)

**JIM KUCHER**

*Social Entrepreneurship: A Practice-Based Approach to Social Innovation*  
(Edward Elgar Publishing, 2022)

**RICHARD N. PITT**

*Church Planters: Inside the World of Religion Entrepreneurs*  
(Oxford University Press, 2021)

**KATARZYNA SKRZYPIŃSKA**

*I Believe, So I Am: Reflections on the Psychology of Spirituality*  
(Brill, 2022)

**BRIAN STEENSLAND, JAIME KUCINSKAS, AND ANNA SUN**

*Situating Spirituality: Context, Practice, and Power*  
(Oxford University Press, 2021)

**HEINZ STREIB**

*Deconversion Revisited: Biographical Studies and Psychometric Analyses Ten Years Later*  
(V&R Academic, 2021)

**LISA WEAVER SWARTZ**

*Stained Glass Ceilings: How Evangelicals Do Gender and Practice Power*  
(Rutgers University Press, 2022)

**JOEL THIESSEN**

*None of the Above*  
(NYU Press, 2020)

**JAMES WATSON**

*Tentmakers - Multivocational Ministry in Western Society*  
(Wipf & Stock Publishers, 2022)

**GINA ZURLO**

*Global Christianity: A Guide to the World's Largest Religion from Afghanistan to Zimbabwe*  
(Zondervan Academic, 2022)

---

## NEW BOOKS RECEPTION SPONSORS

---

**BRILL ACADEMIC PUBLISHERS**

**NEW YORK UNIVERSITY PRESS**

**OXFORD UNIVERSITY PRESS**

# GRADUATE STUDENT SESSION

FRIDAY, NOVEMBER 11, 4:30 PM – 5:30 PM  
Room : Maryland E

Check out the New Books Reception and then  
join your fellow graduate students for  
*Life (and Employment?) After Graduate School:  
A Discussion with Recent Ph.Ds*

PANELISTS:

Katie Corcoran, Associate Professor, West Virginia University  
Jacqui Frost, Associate Professor, Purdue University  
Patricia Tevington, Pew Research Center

ORGANIZED BY 2022  
SSSR GRADUATE STUDENT  
AMBASSADOR:

**ALICIA CHANDLER**  
Wayne State University  
and **Bernard DiGregorio**,  
West Virginia University

## RRA PRESIDENTIAL PANEL

SPONSORED BY :  
 Louisville  
Institute

FRIDAY, NOVEMBER 11 | 6:00 PM – 7:00 PM | Maryland C

*Connecting scholarship and application:  
A conversation between academics and practitioners*

**Melinda Lundquist Denton**

*Professor of Sociology at The University of Texas at San Antonio*

PANELISTS:

**Richard W. Johnson**

*Founding Pastor, Sanctuary Columbus Church, Co-host of The Elusive Dream Podcast*

**Korie Little Edwards**

*Professor of Sociology, Interim Associate Dean, Diversity, Equity & Inclusion and  
Chief Diversity Officer at The Ohio State University, Co-host of The Elusive Dream Podcast*

## RRA RECEPTION

FRIDAY, NOVEMBER 11  
7:00 PM – 8:00 PM  
Maryland Foyer



# AFFINITY GROUP AND RESEARCH NETWORK MEETINGS

FRIDAY, NOVEMBER 11, 2022 | 8:45 PM – 10:00 PM

## CATHOLIC RESEARCH NETWORK

► **Room: St. George**

The meeting of the Catholic Research Network will include a discussion of the topics of interest to those attending.

CONTACT: Pierre Hégy (*pierre.hegy@gmail.com*)

## NON-RELIGION GROUP

► **Room: Gibson**

This is a group for those interested in the myriad ways that non-religion shows up in the United States and globally.

CONTACT: Ryan Cragun (*ryantcragun@gmail.com*)

## ISLAM RESEARCH NETWORK

► **Room: Federal Hill**

This is an informal discussion and networking opportunity for researchers who study Islam.

CONTACT: Besheer Mohamed (*BMohamed@PewResearch.org*)

## MORMON SOCIAL SCIENCE ASSOCIATION (MSSA)

► **Room: Pride of Baltimore**

MSSA exists for the purpose of promoting and sharing the scholarly study of Mormon life. We provide contact and association among researchers and educators working in both academic and applied settings, and are both interdisciplinary and international in scope and purpose.

CONTACT: Carrie Miles (*CarrieM@fastmail.com*)

## SCHOLARS OF COLOR NETWORK

► **Room: Fells Point**

This networking event is for Scholars of Color within the SSSR. We believe the more robust and vibrant connections are made when genuine relationship is the foundation; therefore, we seek to provide an environment where Scholars of Color can discuss and enhance the visibility of their work, receive support, and unwind.

CONTACT: Aida Ramos (*aida.ramos@gmail.edu*)

## CONGREGATIONAL SCHOLARS NETWORK

► **Room: Homeland**

This is an opportunity for those interested in congregational research to meet and get acquainted.

CONTACTS: Kevin Dougherty (*Kevin\_Dougherty@baylor.edu*) and Gerardo Marti (*gemarti@davidson.edu*)

## SOCIAL SCIENCE OF SCIENCE AND RELIGION GROUP

► **Room: Kent**

This group promotes empirical social science research on the relationship between science and religion.

CONTACT: Elaine Howard Ecklund (*ehe@rice.edu*)

## RELIGION AND CIVIC LIFE

► **Room: Guilford**

This is a group for scholars interested in the intersection of religion with politics, voluntarism, and other forms of civic life.

CONTACT: Paul A. Djupe (*pdjupe@gmail.edu*)

# SATURDAY

NOVEMBER 12

8:00 am – 8:50 am	SSSR Business Meeting	Homeland
8:00 am – 9:00 am	Morning Coffee, Sponsored by RRA	Maryland Foyer
8:30 am – 4:00 pm	Registration Open	Maryland Foyer D
9:00 am – 10:30 am	Paper Session E	
9:00 am – 3:00 pm	Book Exhibit	Maryland D
10:40 am – 12:10 pm	Paper Session F	
12:15 pm – 1:10 pm	Networking Lunch	Maryland Foyer
1:15 pm – 2:15 pm	SSSR Presidential Panel	Maryland C
2:20 pm – 3:50 pm	Paper Session G	
4:00 pm – 5:30 pm	Paper Session H	
5:45 pm – 7:00 pm	SSSR Awards & Presidential Address	Maryland C
7:00 pm – 9:00 pm	SSSR Presidential Reception	Maryland Foyer

## SSSR BUSINESS MEETING **AGENDA**

Homeland Room | Saturday, November 12, 8:00 AM – 8:50 AM

**WELCOME AND INTRODUCTION OF OFFICERS**

**STRATEGIC PLAN OVERVIEW AND PROGRESS REPORT**

**TREASURER'S REPORT**

**EXECUTIVE OFFICER'S REPORT**

**JOURNAL EDITOR'S REPORT**

# SATURDAY, NOVEMBER 12

9:00AM - 10:30AM

## PAPER SESSION E

### E-1 SSSR: SSSR PROFESSIONAL DEVELOPMENT COMMITTEE SESSION: GRANTS

► **Room: Watertable A**

ORGANIZER/CONVENER: Michael Nielsen, Georgia Southern University  
([mnielsen@georgiasouthern.edu](mailto:mnielsen@georgiasouthern.edu))

PARTICIPANTS:

Penny Edgell, University of Minnesota ([edgell@umn.edu](mailto:edgell@umn.edu))  
Elaine Howard-Ecklund, Rice University ([eh@rice.edu](mailto:eh@rice.edu))  
Tricia Bruce, University of Notre Dame ([tbruce@nd.edu](mailto:tbruce@nd.edu))  
Mark Chaves, Duke University ([mac58@duke.edu](mailto:mac58@duke.edu))

### E-2 SSSR: INTEGRATING THE SOCIAL SCIENTIFIC STUDY OF RELIGION AND CRITICAL RACE THEORY

► **Room: Baltimore A**

ORGANIZER: Aida Isela Ramos, John Brown University ([aramos@jbu.edu](mailto:aramos@jbu.edu))  
CONVENER: Jonathan Calvillo, Boston University ([calvillo@bu.edu](mailto:calvillo@bu.edu))

#### *Storefront and Black Megachurches as Microcommunities*

Hans Tokke, CUNY ([hans.tokke@gmail.com](mailto:hans.tokke@gmail.com))  
CO-AUTHOR: Richard Cimino, SUNY-Old Westbury

#### *Evangelical Christian Discourse Around Critical Race Theory (CRT)*

Andrea Henderson, University of South Carolina ([akhender@mailbox.sc.edu](mailto:akhender@mailbox.sc.edu))  
CO-AUTHOR 1: Mia Brantley, The Ohio State University  
CO-AUTHOR 2: Aida Isela Ramos, John Brown University

#### *Faith on the Frontera: Religion, Racialization, and Identity in Texas-Mexico Borderlands*

Aida Isela Ramos, John Brown University ([aramos@jbu.edu](mailto:aramos@jbu.edu))

#### *Can Christian Churches Save Latinidad?:*

#### *Latinx Churches and Racialized Panethnicity*

Jonathan Calvillo, Boston University ([calvillo@bu.edu](mailto:calvillo@bu.edu))

### E-3 SSSR: EASTERN ORTHODOXY AND THE CHALLENGES OF THE RUSSIA-UKRAINE WAR

► **Room: Watertable C**

ORGANIZER/CONVENER: Jerry Pankhurst, Wittenberg University  
([jpankhurst@wittenberg.edu](mailto:jpankhurst@wittenberg.edu))

#### *The patriarch, the general, and the icon:*

#### *Russia's official Orthodoxy at war*

Vyacheslav Karpov, Western Michigan University ([v.karpov@wmich.edu](mailto:v.karpov@wmich.edu))

#### *The dynamics of the relations between the Ukrainian Orthodox Church of the Moscow Patriarchate and the Ukrainian government in 2014-2022: Legal perspective*

Dmytro Vovk, Yaroslav Mudryi National Law University, Kharkiv, Ukraine  
([dmtr.vovk@gmail.com](mailto:dmtr.vovk@gmail.com))

#### *30 Days Before and 30 Days After: The Moscow Patriarchate as an Agent of Soft Power Becoming "Hard Power" in the 2022 Invasion of Ukraine by Russia*

Jerry Pankhurst, Wittenberg University (emeritus)  
([jpankhurst@wittenberg.edu](mailto:jpankhurst@wittenberg.edu))  
CO-AUTHOR: Alar Kilp, University of Tartu, Estonia

### E-4 SSSR: RELIGIOUS RESPONSES TO COVID-19 IN NIGERIA

► **Room: Gibson**

CONVENER: Edlyne Anugwom, University of Nigeria Nsukka  
([akommiri@gmail.com](mailto:akommiri@gmail.com))

#### *From the Pulpit to the Street: Assessing the Church's Response in the Fight Against COVID- 19 in Nigeria*

Ojo Joseph Rapheal, Adekunle Ajasin University, Akungba-Akoko, Nigeria.  
Doctoral Student at the Department for the Study of Religions,  
University of Ghana, Accra, Ghana ([ojrappel@st.ug.edu.gh](mailto:ojrappel@st.ug.edu.gh))  
CO-AUTHOR: Bùsáyò Ọ̀láníyí Ọ̀gúnàjọ, Department of Religions, Osun State  
University Ikire Campus, Nigeria

#### *God in all things: Small congregations and surviving the COVID-19 pandemic in Nigeria*

Edlyne Anugwom, University of Nigeria ([akommiri@gmail.com](mailto:akommiri@gmail.com))  
CO-AUTHOR: Kenechukwu Anugwom, University of Nigeria

#### *The Bane of COVID19 Dystopia:*

#### *Responses of Nigerian Christian and Moslem Communities.*

Bolaji Bateye, Department of Religious Studies, Obafemi Awolowo  
University, Ile-Ife ([bolaji66@yahoo.com](mailto:bolaji66@yahoo.com))  
CO-AUTHOR 1: Olukemi Bateye, Dept. of Medical Rehabilitation,  
Obafemi Awolowo University, Ile-Ife  
CO-AUTHOR 2: Temidayo Olayinka, Adult Education and Community  
Development, University of Ibadan

#### *The Role of the Church in Health Promotion During the COVID-19 Pandemic: A Case Study of RCCG Region 20, Lagos, Nigeria*

Comfort Jinadu, The Redeemed Christian Church of God  
([jinaduccomfort@gmail.com](mailto:jinaduccomfort@gmail.com))

### E-5 RRA: RELIGION COUNTS: CHALLENGES OF MEASURING RELIGIOUS CHANGE FACED BY PEW RESEARCH CENTER AND THE CENTER FOR THE STUDY OF GLOBAL CHRISTIANITY

► **Room: Federal Hill**

ORGANIZER: Conrad Hackett, Pew Research Center ([conradhackett@gmail.com](mailto:conradhackett@gmail.com))

#### *Challenges facing Pew Research Center as we measure religious change between 2010 and 2020*

Conrad Hackett, Pew Research Center ([conradhackett@gmail.com](mailto:conradhackett@gmail.com))

#### *Challenges of measuring change in the World Christian Encyclopedia/Database and World Religion Database*

Gina Zurlo, Center for the Study of Global Christianity ([gzurlo@bu.edu](mailto:gzurlo@bu.edu))

**SATURDAY, NOVEMBER 12**

9:00AM - 10:30AM

**Response to presentations by Conrad and Gina**

David Voas, University College London ([d.voas@ucl.ac.uk](mailto:d.voas@ucl.ac.uk))

**E-6 SSSR: GLOBAL CHRISTIANITY**

► **Room: Baltimore B**

CONVENER: Carsten Vala, Loyola University ([cvala@loyola.edu](mailto:cvala@loyola.edu))

**"Modernizing" small town Christianity:  
exploring majority Protestant Christianity in China today**

Carsten Vala, Loyola University Maryland ([cvala@loyola.edu](mailto:cvala@loyola.edu))

CO-AUTHOR 1: Jianbo Huang, East China Normal University

CO-AUTHOR 2: Yunze Xiao, Zhejiang University of Technology

**Belonging Among Church Members with Disabilities:  
The Seventh-day Adventist Global Church Case Study**

Shannon Trecartin, Andrews University ([trecarts@andrews.edu](mailto:trecarts@andrews.edu))

CO-AUTHOR: Petr Cincala, Andrews University

**Step into God's Global Timeline:**

**Missionary Timescapes and the Making of "World Christians"**

Daniel Winchester, Purdue University ([dwinches@purdue.edu](mailto:dwinches@purdue.edu))

**Korean Christian Missionaries in High-risk Countries: Interaction  
with International Religious Networks and Domestic Response**

Jihye Jung, Arizona State University ([jjung60@asu.edu](mailto:jjung60@asu.edu))

**E-7 SSSR: RELIGION IN AFRICA**

► **Room: Pride of Baltimore**

CONVENER: Nicolette Manglos-Weber, Boston University ([nmw1@bu.edu](mailto:nmw1@bu.edu))

**Engaging the Nexus between Religious activism  
and Spirituality in nation's development:**

**A critical Analysis of Religious activism in Nigeria**

Danoye Ogunbola Laguda, Lagos State University

([danoye.oguntola-laguda@lasu.edu.ng](mailto:danoye.oguntola-laguda@lasu.edu.ng))

**The speaking objects and bodies: A preliminary account  
of semiotics of inculturation in Nigerian churches**

Ngozi U. Emeka-Nwobia, Ebonyi State University, Abakaliki - Nigeria

([ngozinwobia@gmail.com](mailto:ngozinwobia@gmail.com))

CO-AUTHOR: Grace Umezurike, Ebonyi State University, Abakaliki - Nigeria

**Contesting the Digital Space: Televangelism and the  
Changing Habits of worship among Nigerian churches**

Grace Umezurike, Ebonyi State University, Abakaliki - Nigeria

([graceumez@yahoo.com](mailto:graceumez@yahoo.com))

**The Pastoral-neur:**

**Material Explanations for Religious Transformation in Uganda**

Nicolette Manglos-Weber, Boston University ([nmw1@bu.edu](mailto:nmw1@bu.edu))

**E-8 SSSR: RELIGION AND POLITICAL PARTICIPATION**

► **Room: Homeland**

CONVENER: Kraig Beyerlein, University of Notre Dame ([kbeyerl1@nd.edu](mailto:kbeyerl1@nd.edu))

**Thinking again about Community:**

**Contemporary Pagans, Spirituality, and Political Action.**

Helen A. Berger, WSRC, Brandeis University ([haberger@brandeis.edu](mailto:haberger@brandeis.edu))

**Civil resistance, obedience/disobedience, and religion**

Tomas Lindgren, Umea University ([tomas.lindgren@umu.se](mailto:tomas.lindgren@umu.se))

CO-AUTHOR: Hannes Sonnenschein, Umea University

**Faithful Dissent?: How Protestors' Religion Affects  
Public Support for Social Activism**

Kraig Beyerlein, University of Notre Dame ([kbeyerl1@nd.edu](mailto:kbeyerl1@nd.edu))

CO-AUTHOR: Jason Klocek, University of Nottingham

**Faithful and (A)political:**

**Religion, Ideology, and Political Participation**

Enrique Quezada, Rice University ([enrique.quezada@rice.edu](mailto:enrique.quezada@rice.edu))

**E-9 SSSR: HEALTH, SPIRITUALITY, AND COPING WITH STRESS**

► **Room: Maryland B**

CONVENER: Brandon Vaidyanathan, Catholic University ([brandonv@cua.edu](mailto:brandonv@cua.edu))

**Religion, Spirituality, and Mental Health Among Scientists  
During the Pandemic: A Four- Country Study**

Brandon Vaidyanathan, The Catholic University of America

([brandonv@cua.edu](mailto:brandonv@cua.edu))

CO-AUTHOR 1: Caitlin Fitzgerald, The Catholic University of America

CO-AUTHOR 2: Stephen Cranney, The Catholic University of America

**Making the ordinary extraordinary:**

**Religious and Spiritual Practice in the everyday  
lives of women with metastatic breast cancer**

Rachel Kraus, Ball State University ([rmkraus@bsu.edu](mailto:rmkraus@bsu.edu))

**The role of spiritual intelligence in times of existential crisis**

Katarzyna Skrzypiąska, University of Gdańsk ([katarzyna.skrzypinska@ug.edu.pl](mailto:katarzyna.skrzypinska@ug.edu.pl))

**Financial Strain and Physical Health:**

**Exploring the Moderating Role of Religion**

Metin Guven, Florida State University ([mguven@fsu.edu](mailto:mguven@fsu.edu))

**E-10 SSSR: INCLUSION AND EXCLUSION:  
LGBTQ ISSUES AND THE CHURCH**

► **Room: Watertable B**

CONVENER: Luther Young, The Ohio State University ([young.2734@osu.edu](mailto:young.2734@osu.edu))

**Queer Blindness in Welcoming & Affirming Congregations:  
An Investigation of Heterosexism in Inclusive Organizations**

Timothy Lauve-Moon, Baylor University ([tim\\_moon@baylor.edu](mailto:tim_moon@baylor.edu))

CO-AUTHOR: Katie Lauve-Moon, Texas Christian University

**Information Ecologies that Promote Radical Belonging for  
Christians with Diverse Gender, Sexual, and Relationship  
Identities and Practices**

Wes King, University of Washington ([mxwe@uw.edu](mailto:mxwe@uw.edu))

CO-AUTHOR 1: Carrie E. Neal, The New School

CO-AUTHOR 2: Luther Young, The Ohio State University

**SATURDAY, NOVEMBER 12**

9:00AM - 10:30AM

**"Who Said So?":**

**Perceived Rationales for Non-Affirming Black Churches**

Luther Young, The Ohio State University ([young.2734@osu.edu](mailto:young.2734@osu.edu))

**Faithfully Queer:**

**Pathways to Religious Leadership among LGBTQ People of Faith**

Jonathan Coley, Department of Sociology, Oklahoma State University ([jonathan.s.coley@okstate.edu](mailto:jonathan.s.coley@okstate.edu))

CO-AUTHOR: Joseph Anthony, Department of Political Science, SUNY Cortland

**E-11 SSSR: ENGAGED SPIRITUALITY: THE ROLE OF RELIGION IN THE LIVES OF 100 GLOBAL HUMANITARIANS**

► **Room: Mount Washington**

ORGANIZER/CONVENER: Donald Miller, University of Southern California ([demiller@usc.edu](mailto:demiller@usc.edu))

**Who are Spiritual Exemplars? A cross-sectional exploration of 100 spiritually engaged humanitarians**

Hebah Farrag, University of Southern California ([farrag@usc.edu](mailto:farrag@usc.edu))

**A journalist and an ethnographer walk into the same research project...**

Ken Chitwood, Freie Universität Berlin, Germany ([ken.chitwood@hotmail.com](mailto:ken.chitwood@hotmail.com))

**The Paradoxes of Spiritual Exemplars:**

**The Coexistence of Radical Resistance and Radical Acceptance**

Arpi Miller, Center for Religion and Civic Culture, USC ([arpimiller@gmail.com](mailto:arpimiller@gmail.com))

**The Role of Spiritual Practices for Exemplary Humanitarians**

Donald Miller, University of Southern California ([demiller@usc.edu](mailto:demiller@usc.edu))

**E-12 SSSR: REFLECTING ON THE SOCIOLOGY OF RELIGION**

► **Room: James**

CONVENER: Gary Adler, Penn State ([gary.adler@psu.edu](mailto:gary.adler@psu.edu))

**Lived and Practiced: Two Paradigms for the Future of the Sociology of Religion**

Patrick Gilger, SJ, Loyola University Chicago ([pgilger@luc.edu](mailto:pgilger@luc.edu))

**City in Nature:**

**The Possibilities of Postsecular Governance in Singapore**

Justin Tse, Singapore Management University ([justintse@smu.edu.sg](mailto:justintse@smu.edu.sg))

**Fantasies about "Science" and "Religion"**

Benjamin Beit-Hallahmi, University of Haifa ([zmirahe@yahoo.com](mailto:zmirahe@yahoo.com))

**Religious Capacities in Words, Deeds, and Institutions: Adapting French Pragmatism for the Sociology of Religion**

Gary Adler, Penn State University ([gary.adler@psu.edu](mailto:gary.adler@psu.edu))

CO-AUTHOR 1: Shai Dromi, Harvard University

CO-AUTHOR 2: Samuel Stabler, Hunter College

**E-13 RRA: THE INFLUENCE OF COVID-19 ON HOME-CENTERED PRACTICES AND RELATIONAL WELL- BEING**

► **Room: Maryland F**

ORGANIZER: Heather Kelley, Utah State University ([heather.kelley@usu.edu](mailto:heather.kelley@usu.edu))

**Changes in Home-centered Religious Practices and Relational Well-being during the COVID- 19 Pandemic**

David Dollahite, Brigham Young University ([david\\_dollahite@byu.edu](mailto:david_dollahite@byu.edu))

CO-AUTHOR 1: Spencer James, Brigham Young University

CO-AUTHOR 2: Loren Marks, Brigham Young University

**Changes in Spiritual Practices and Relational Well-Being During the COVID-19 Pandemic**

Heather Kelley, Utah State University ([heather.kelley@usu.edu](mailto:heather.kelley@usu.edu))

CO-AUTHOR 1: David Dollahite, Brigham Young University

CO-AUTHOR 2: Spencer James, Brigham Young University

**Family Dinner During the COVID-19 Pandemic: Does the Family that Eats Together Stay Together?**

Loren Marks, Brigham Young University ([loren\\_marks@byu.edu](mailto:loren_marks@byu.edu))

CO-AUTHOR 1: David Dollahite, Brigham Young University

CO-AUTHOR 2: Spencer James, Brigham Young University

**E-14 RRA: BELIEVERS' SENSE OF THEIR RELIGIOUS HOME**

► **Room: Guilford**

CONVENER: Jennifer McClure, Samford University ([jmclure@samford.edu](mailto:jmclure@samford.edu))

**Is Together Better? Investigating the Relationship between Network Dynamics and Congregations' Vitality and Sustainability**

Jennifer McClure, Samford University ([jmclure@samford.edu](mailto:jmclure@samford.edu))

**A Research on the Impact of the 500 Years of Christianity in the Philippines**

Emmanuel Sogah, Center for Ministry and Leadership Development ([esogah@center4ministry.us](mailto:esogah@center4ministry.us))

**It's Where I Feel at Home':**

**An Investigation of Young Adult Catholic Members of an Australian Traditional Latin Mass Community**

Richard Rymarz, BBI-TAITE ([rrymarz@bbi.catholic.edu.au](mailto:rrymarz@bbi.catholic.edu.au))

**Virtual Pilgrimage to Lough Derg: A Response to Covid**

Stephen Glazier, Yale University ([stephen.glazier@yale.edu](mailto:stephen.glazier@yale.edu))

**E-15 SSSR: AUTHOR MEETS CRITICS - CIVIL RELIGION TODAY: RELIGION AND THE AMERICAN NATION IN THE TWENTY-FIRST CENTURY**

► **Room: Maryland E**

ORGANIZER/CONVENER: Ruth Braunstein, University of Connecticut ([ruth.braunstein@uconn.edu](mailto:ruth.braunstein@uconn.edu))

AUTHOR: Rhys Williams, Loyola University Chicago ([rwilliams7@luc.edu](mailto:rwilliams7@luc.edu))

CO-AUTHOR 1: Raymond J. Haberski, Jr.,

Indiana University-Purdue University Indianapolis

CO-AUTHOR 2: Philip Goff, Indiana University-Purdue University Indianapolis

PARTICIPANTS

Andrew Whitehead, Indiana University-Purdue University Indianapolis ([aw122@iu.edu](mailto:aw122@iu.edu))

Gerardo Marti, Davidson College ([gemarti@davidson.edu](mailto:gemarti@davidson.edu))

Paul Djupe, Denison University ([djupe@denison.edu](mailto:djupe@denison.edu))

Cheryl Townsend Gilkes, Colby College ([ctgilkes@colby.edu](mailto:ctgilkes@colby.edu))

**SATURDAY, NOVEMBER 12**

9:00AM - 10:30AM

**E-16 SSSR: EXPLORING TRENDS IN RELIGIOUS AFFILIATION**

► **Room: Maryland A**

ORGANIZER: David Eagle, Duke University ([david.eagle@duke.edu](mailto:david.eagle@duke.edu))

***How "Religion" Became Polluted in Canada, 1960-2020: A Cultural Sociological Account of Secularization***

Galen Watts, KU Leuven ([galen.watts@kuleuven.be](mailto:galen.watts@kuleuven.be))

CO-AUTHOR: Sam Reimer, Crandall University

***Age, Period, or Cohort?***

***Re-Examining Trends in Religious Affiliation in the United States***

Sarah Wilkins-Laflamme, University of Waterloo

([sarah.wilkins-laflamme@uwaterloo.ca](mailto:sarah.wilkins-laflamme@uwaterloo.ca))

CO-AUTHOR 1: David Eagle, Duke University

CO-AUTHOR 2: Josh Gaghan, Duke University

***Reconsidering the Classification of Nondenominational Christians***

Josh Gaghan, Duke University ([joshua.gaghan@duke.edu](mailto:joshua.gaghan@duke.edu))

CO-AUTHOR: David Eagle, Duke University

**E-17 SSSR: THEOLOGICAL EDUCATION: STUDENT FORMATION FROM MATRICULATION TO GRADUATION**

► **Room: St. George**

ORGANIZER: Erin Johnston, Duke University ([erin.johnston1@duke.edu](mailto:erin.johnston1@duke.edu))

***Spiritual practices and character formation among seminary students: Longitudinal implications on mental health and human flourishing during the COVID-19 pandemic***

David Wang, Biola University ([david.wang@biola.edu](mailto:david.wang@biola.edu))

***Intellectual Formation or Obfuscation?***

***The Impact of Theological Education on Views of Sexuality (Insights from the Seminary-to-Early Ministry Study)***

Erin Johnston, Duke University ([erin.johnston1@duke.edu](mailto:erin.johnston1@duke.edu))

CO-AUTHOR 1: Laura Krull, St. Norbert College

CO-AUTHOR 2: Anna Holleman, Duke University

***Vocational Formation in Theological Field Education***

Kristina Lizardy-Hajbi, Iliff School of Theology ([klizardy@iliff.edu](mailto:klizardy@iliff.edu))

***COVID Effects on ATS Graduates:***

***Lessons from the Graduating Student Questionnaire***

Christopher M. The, The Association of Theological Schools  
In the United States and Canada ([the@ats.edu](mailto:the@ats.edu))

CO-AUTHOR: Deborah Gin, The Association of Theological Schools  
In the United States and Canada

# SATURDAY, NOVEMBER 12

10:40AM - 12:10PM

## PAPER SESSION F

### **F-1 SSSR: TALKING ABOUT RACE: FAITH AND JUSTICE IN THE US**

► **Room: Baltimore A**

CONVENER: Esther Chan, University of Wisconsin-Milwaukee ([chane@uwm.edu](mailto:chane@uwm.edu))

#### ***White Mainline Protestant Preachers Addressing Racial Issues: 2017 v. 2021***

Leah Schade, Lexington Theological Seminary ([lschade@lextheo.edu](mailto:lschade@lextheo.edu))

CO-AUTHOR 1: Amanda Wilson Harper, Tarleton State University

CO-AUTHOR 2: Wayne Thompson, Carthage College

#### ***Racial Differences and the Campus Racial Climate: Reasons for Avoiding Discussions of Race on Christian Colleges***

Esther Chan, University of Wisconsin-Milwaukee ([chane@uwm.edu](mailto:chane@uwm.edu))

CO-AUTHOR 1: Victoria Isaac, University of Wisconsin-Milwaukee

CO-AUTHOR 2: Elijah Jeong, Baylor University

#### ***Religious Approaches to DEI***

Amy Reynolds, Wheaton College ([amy.reynolds@wheaton.edu](mailto:amy.reynolds@wheaton.edu))

#### ***Black or Blue: Examining Racial Differences in the Evaluation of Black Lives Matter and Blue Lives Matter among Conservative Christians***

Robert Thomson, University of Alabama in Huntsville

([robert.thomson@uah.edu](mailto:robert.thomson@uah.edu))

CO-AUTHOR 1: Rachel Schneider, Rice University

CO-AUTHOR 2: Cleve Tinsley, Virginia Union University

### **F-2 SSSR: CHANGES AND CONTINUITIES IN ISLAM**

► **Room: Watertable C**

CONVENER: Sabri Ciftci, Kansas State University ([ciftci@ksu.edu](mailto:ciftci@ksu.edu))

#### ***Clerical Authority, Technicity and the Everyday Life***

Babak Rahimi, UC San Diego ([brahimi@ucsd.edu](mailto:brahimi@ucsd.edu))

#### ***Religious Outlooks, Islamic Organizations, and Distributive Preferences***

Sabri Ciftci, Kansas State University ([ciftci@ksu.edu](mailto:ciftci@ksu.edu))

CO-AUTHOR 1: Ammar Shamaileh, Doha Institute for Graduate Studies

CO-AUTHOR 2: Michael Wuthrich, University of Kansas

#### ***The Middle East in the Age of Divine Decadence: From the 1979 Iranian Revolution to the 2017 Destruction of ISIS***

Mansoor Moaddel, University of Maryland ([mmoaddel@gmail.com](mailto:mmoaddel@gmail.com))

#### ***Islam in a Natural Light: its evolution and stability over time.***

Andrew Atkinson, University of Bialystok, University of Agder

([logistikon@protonmail.com](mailto:logistikon@protonmail.com))

CO-AUTHOR: Kenan Sevinc, Canakkale Onsekiz Mart University

### **F-3 RRA: RELIGIOUS INSTITUTIONS AS ROUNDHOUSES FOR PEOPLE AND IDEAS**

► **Room: Federal Hill**

CONVENER: Patricia Wittberg, Center for Applied Research in the Apostolate  
Georgetown University ([pwittber@iupui.edu](mailto:pwittber@iupui.edu))

#### ***Barriers and Bridges between Congregations with Different Racial Compositions***

Jennifer McClure, Samford University ([jmccclure@samford.edu](mailto:jmccclure@samford.edu))

#### ***The "Scared Nave" for Politically Liberal Evangelical Protestants***

Jesse DeDeyne, Baylor University ([jesse\\_dedeyne2@baylor.edu](mailto:jesse_dedeyne2@baylor.edu))

#### ***Internally Constrained: The Importance of Theology for the Political Mission of the Catholic Church***

Dawid Tatarczyk, Albion College ([dtatarczyk@albion.edu](mailto:dtatarczyk@albion.edu))

#### ***Generational and Cross-National Differences Among Newer Entrants to Catholic Religious Orders***

Patricia Wittberg, Center for Applied Research in the  
Apostolate Georgetown University ([pwittber@iupui.edu](mailto:pwittber@iupui.edu))

### **F-4 SSSR: SPIRITUALITY IN ASIA**

► **Room: Baltimore B**

CONVENER: Becky Hsu, Georgetown University ([becky.hsu@georgetown.edu](mailto:becky.hsu@georgetown.edu))

#### ***Encompassing marvel of form and spirit: Social network analysis of mystical experiences among Chinese Daoist monks and nuns***

Zhuo Job Chen, University of North Carolina, Charlotte ([job.chen@unc.edu](mailto:job.chen@unc.edu))

#### ***Gratitude, Religious Beliefs, and Spiritual Practices: The Case of Indigenous Asian Religion***

Chang-ho Ji, La Sierra University ([cji@lasierra.edu](mailto:cji@lasierra.edu))

CO-AUTHOR: Vy Cao, La Sierra University

#### ***Ritual and Bereavement:***

#### ***Dual Process Model and Grave Sweeping in China***

Becky Hsu, Georgetown University ([becky.hsu@georgetown.edu](mailto:becky.hsu@georgetown.edu))

CO-AUTHOR: Roman Palitsky, Emory University

#### ***Religiosity in India***

Samuel Stroope, Louisiana State University ([sstroope@lsu.edu](mailto:sstroope@lsu.edu))

CO-AUTHOR 1: Nathaniel Porter, Virginia Tech

CO-AUTHOR 2: Ajay Verghese, Middlebury College

### **F-5 SSSR: THINKING ABOUT GOD, TOLERANCE, AND MORALITY**

► **Room: Pride of Baltimore**

CONVENER: Youssef Chouhoud, Christopher Newport University  
([youssef.chouhoud@cnu.edu](mailto:youssef.chouhoud@cnu.edu))

**SATURDAY, NOVEMBER 12**

10:40AM - 12:10PM

***What Do People Think about God? Investigating a Mental Representation of God as Effective Priming Stimuli***

Michael B. Kitchens, Lebanon Valley College ([kitchens@lvc.edu](mailto:kitchens@lvc.edu))

CO-AUTHOR 1: Isabella M. Lang, Lebanon Valley College

CO-AUTHOR 2: Sydney E. Petrasic, Lebanon Valley College

***Religious judgment predicts religious tolerance: a re-imagining of the dimensions of religious judgment***

Katheryn Kelley, University of Notre Dame ([kkelley5@nd.edu](mailto:kkelley5@nd.edu))

Co-Author 1: William Ostergard, University of Notre Dame Co-Author 2:

Katherine Machado, University of Notre Dame

***On the Relationships Between Prejudice and Value Orientations of Turkish University Students***

Mustafa Ulu, Erciyes University ([mustafaulu@erciyes.edu.tr](mailto:mustafaulu@erciyes.edu.tr))

CO-AUTHOR: Michael Nielsen, Georgia Southern University

***To Hell with Tolerance: Salvific Exclusivity and Political Attitudes***

Youssef Chouhoud, Christopher Newport University

([youssef.chouhoud@cnu.edu](mailto:youssef.chouhoud@cnu.edu))

**F-6 SSSR: RELIGION & POLITICS IN EUROPE**

► **Room: Homeland**

CONVENER: Marko Vekovic, University of Belgrade ([marko.vekovic@fpn.bg.ac.rs](mailto:marko.vekovic@fpn.bg.ac.rs))

***Belonging without Attending?***

***National identity and Contemporary Religious Pattern in Serbia***

Marko Vekovic, University of Belgrade ([marko.vekovic@fpn.bg.ac.rs](mailto:marko.vekovic@fpn.bg.ac.rs))

***The revival of the sacred? Religion and values among young people - in Poland, Italy and Ukraine - under conditions of threat***

Ewa Stachowska, The University of Warsaw ([ewa.stachowska@uw.edu.pl](mailto:ewa.stachowska@uw.edu.pl))

***Governance of religious diversity in Germany***

Anna Körs, University of Hamburg ([anna.koers@uni-hamburg.de](mailto:anna.koers@uni-hamburg.de))

***Can We Identify a Distinctive British Christian Democracy?***

Siobhan McAndrew, Sheffield Methods Institute, University of Sheffield

([s.mcandrew@sheffield.ac.uk](mailto:s.mcandrew@sheffield.ac.uk))

**F-7 SSSR: SPIRITUAL AND MENTAL HEALTH**

► **Room: Maryland B**

CONVENER: Laura Upenieks, Baylor University ([laura.upenieks@gmail.com](mailto:laura.upenieks@gmail.com))

***Matters of the Heart: Childhood Abuse, Religious Transitions, and Cardiovascular Risk over the Life Course***

Laura Upenieks, Baylor University ([laura.upenieks@gmail.com](mailto:laura.upenieks@gmail.com))

CO-AUTHOR: Patricia Thomas, Purdue University

***Effect of being religious on wellbeing in a predominantly atheist country: Explorative study on wellbeing, fitness, physical and mental health***

Robin Kopecky, Institute of Philosophy, Czech Academy of Sciences

([robin.kopecky@icloud.com](mailto:robin.kopecky@icloud.com))

CO-AUTHOR 1: Lenka Příplatová, Institute of Philosophy,

Czech Academy of Sciences

CO-AUTHOR 2: Silvia Boschetti, Institute of Philosophy,

Czech Academy of Sciences

***Causal attributions and mental illness treatment recommendations in religious populations***

Christopher Jacobi, University of Oxford ([jacobi@cua.edu](mailto:jacobi@cua.edu))

CO-AUTHOR: Bailey Haraburda, The Catholic University of America

***Development of the Spiritual Harm & Abuse Scale***

Daniel Koch, Northwest University ([daniel.koch19@northwestu.edu](mailto:daniel.koch19@northwestu.edu))

CO-AUTHOR: Leihua Edstrom, Northwest University

**F-8 SSSR: WHAT DOES SPIRITUALITY MEAN TO US? - THE FUNDING, FINDINGS, AND FUTURE OF SPIRITUALITY RESEARCH**

► **Room: Gibson**

ORGANIZER/CONVENER: Gillian Gonda, Fetzer Institute ([ggonda@fetzer.org](mailto:ggonda@fetzer.org))

PANELISTS

Mohammed Mohammed, Fetzer Institute ([mmohammed@fetzer.org](mailto:mmohammed@fetzer.org))

Brian Steensland, Indiana University School of Liberal Arts at IUPUI

([bsttens@iupui.edu](mailto:bsttens@iupui.edu))

Adam Russell Taylor, Sojourners ([ataylor@sojo.net](mailto:ataylor@sojo.net))

**F-9 SSSR: RELIGIOUS AND CIVIC ENGAGEMENT**

► **Room: James**

CONVENER: Joshua Orndorff, James Madison University

([orndorjr@dukes.jmu.edu](mailto:orndorjr@dukes.jmu.edu))

***Extending Bounded Affinity Theory:***

***Religion and the Paranormal in the U.K.***

Joseph Baker, East Tennessee State University ([bakerjo@etsu.edu](mailto:bakerjo@etsu.edu))

CO-AUTHOR 1: Christopher Bader, Chapman University

CO-AUTHOR 2: Tom Clark, University of Sheffield

***Interfaith Engagement for Civil Religion***

Song Chong Lee, Seoul National University ([songchonglee@snu.ac.kr](mailto:songchonglee@snu.ac.kr))

***Religion as a Factor in Social Origins Theory***

Joshua Orndorff, James Madison University ([orndorjr@dukes.jmu.edu](mailto:orndorjr@dukes.jmu.edu))

***Machiavellism and Religious Involvement:***

***An Empirical Study on Demographics***

Ibrahim Furkan Guven, Ordu University ([ibrahimfurkanguven@hotmail.com](mailto:ibrahimfurkanguven@hotmail.com))

**F-10 SSSR: WHITENESS AND RELIGION IN THE US**

► **Room: Watertable B**

CONVENER: Gerardo Marti, Davidson College ([gemarti@davidson.edu](mailto:gemarti@davidson.edu))

***Antiracism, Congregational Ministry, and Progressive Christianity: An Analysis of the Challenge of Addressing Whiteness in American Christianity***

Gerardo Marti, Davidson College ([gemarti@davidson.edu](mailto:gemarti@davidson.edu))

CO-AUTHOR 1: Mark T. Mulder, Calvin University

CO-AUTHOR 2: Kevin Dougherty, Baylor University

***Christian Nationalism as A Racial Reaction Within the White Evangelical Church***

Marina Rivera Ramos, University of Central Florida

([riveramarina9928@knights.ucf.edu](mailto:riveramarina9928@knights.ucf.edu))



**SATURDAY, NOVEMBER 12**

10:40AM - 12:10PM

***Making Sense of Diversity:***

***How Congregants of Color's Use of Diversity Ideology Reproduces White Hegemony in the Multiracial Church***

Joshua Underwood, The Ohio State University ([underwood.274@osu.edu](mailto:underwood.274@osu.edu))

CO-AUTHOR: Korie Little Edwards, The Ohio State University

***The White Moral Standard: How Race, Religion, and Morality Shape The Value Hierarchy in Deep White Religious Spaces***

Tryce Prince, University of Illinois at Chicago ([tprinc2@uic.edu](mailto:tprinc2@uic.edu))

**F-11 SSSR: EXPLORING THE PANDEMIC IMPACT ON CONGREGATIONS: WORSHIP MODALITIES, MENTAL HEALTH, AND RACE ACROSS THREE US CITIES**

► **Room: St. George**

ORGANIZER/CONVENER: Allison Norton, Hartford Institute for Religion Research @ Hartford International University ([anorton@hartfordinternational.edu](mailto:anorton@hartfordinternational.edu))

***Solidarity at Six Feet Away? Congregant Experiences in Different Worship Modalities and Gatherings in Hartford, Connecticut***

Allison Norton, Hartford Institute for Religion Research

([anorton@hartfordinternational.edu](mailto:anorton@hartfordinternational.edu))

CO-AUTHOR 1: Patricia Tevington, Pew Research Center

CO-AUTHOR 2: Hannah Evans, Hartford Institute for Religion Research

***The mental health toll of the pandemic on congregations in Washington DC***

Brandon Vaidyanathan, The Catholic University of America

([brandonv@cua.edu](mailto:brandonv@cua.edu))

CO-AUTHOR 1: Kathryn Middleton, The Catholic University of America

CO-AUTHOR 2: Mackenzie Cox, The Catholic University of America

***Adaption and transition: The Church of God (Cleveland, Tennessee) and the COVID-19 Pandemic***

Arlie Tagayuna, Lee University ([atagayuna@leeuniversity.edu](mailto:atagayuna@leeuniversity.edu))

CO-AUTHOR: Ruthie Wienk, Lee University

**F-12 RRA: APPLIED RESEARCH IN THE SPOTLIGHT: CONSTANT H. JACQUET RESEARCH AWARD WINNERS**

► **Room: Maryland F**

ORGANIZER: Gina Zurlo, Gordon-Conwell Theological Seminary

([gzurlo@gordonconwell.edu](mailto:gzurlo@gordonconwell.edu))

***Structural Problems, Interpersonal Solutions:***

***How Clergy Respond to Racial Protests***

Claire Chipman Gilliland, Furman University ([claire.gilliland@furman.edu](mailto:claire.gilliland@furman.edu))

CO-AUTHOR 1: Sabrina Strickland-Harris, Furman University

CO-AUTHOR 2: Virginia Wayt, Furman University

***Gendered Logics in Field Emergence: The American Woman's Missionary Movement of the 19th Century***

Kerby Goff, Penn State University ([kerby.goff@psu.edu](mailto:kerby.goff@psu.edu))

***Polarization and the Production and Reception of Liturgical Change in the U.S. Catholic Church after the Second Vatican Council***

Audra Dugandzic, University of Notre Dame ([anakas@nd.edu](mailto:anakas@nd.edu))

***"The Bad Girls" of Evangelical Twitter: Two Historians Deconstruct Patriarchy and Construct Religious Authority***

Kelsey Woodruff, Harvard University ([khwoodruff@g.harvard.edu](mailto:khwoodruff@g.harvard.edu))

**F-13 SSSR: WHAT ACCOUNTS FOR RELIGIOUS CHANGE IN THE UNITED STATES? UNANSWERED QUESTIONS AND A PROMISING DIRECTIONS**

► **Room: Maryland A**

ORGANIZER/CONVENER: David Eagle, Duke University ([david.eagle@duke.edu](mailto:david.eagle@duke.edu))

***The demographic mechanisms that do and do not seem to be driving a lot of religious change, with new attention to religious transmission and changing patterns of religious switching***

Conrad Hackett, Pew Research Center ([CHackett@PewResearch.org](mailto:CHackett@PewResearch.org))

***Exceptional Inequality, Exceptional Religiosity***

Landon Schnabel, Cornell University ([schnabel@cornell.edu](mailto:schnabel@cornell.edu))

***Insights on the Peculiarities of Religious Change in the US, based on Canada-US Comparisons***

Sarah Wilkins-Laflamme, University of Waterloo

([sarah.wilkins-laflamme@uwaterloo.ca](mailto:sarah.wilkins-laflamme@uwaterloo.ca))

***Crypto-nones and invisible secularity***

David Voas, University College London ([d.voas@ucl.ac.uk](mailto:d.voas@ucl.ac.uk))

**F-14 SSSR AUTHOR MEETS CRITICS - RELIGION IN REBELLIONS, REVOLUTIONS, AND SOCIAL MOVEMENTS**

► **Room: Maryland E**

ORGANIZER/CONVENER: Warren Goldstein, Center for Critical Research on Religion ([goldstein@criticaltheoryofreligion.org](mailto:goldstein@criticaltheoryofreligion.org))

AUTHORS: Warren Goldstein, Center for Critical Research on Religion

([goldstein@criticaltheoryofreligion.org](mailto:goldstein@criticaltheoryofreligion.org)), and Jean-Pierre Reed, Southern Illinois

University Carbondale ([reedjp@siu.edu](mailto:reedjp@siu.edu))

CO-AUTHOR 1: Rhys Williams, Loyola University Chicago

CO-AUTHOR 2: Anna Peterson, University of Florida

CO-AUTHOR 3: Babak Rahimi, University of California, San Diego

PARTICIPANTS:

Richard Wood, University of New Mexico ([rlwood@unm.edu](mailto:rlwood@unm.edu))

Ryan Cragun, University of Tampa ([ryancragun@gmail.com](mailto:ryancragun@gmail.com))

Tricia Bruce, Notre Dame University ([tbruce@nd.edu](mailto:tbruce@nd.edu))

**F-15 RRA: WHAT'S THE TREND? FROM JUDAISM TO EPISCOPALIANISM, FROM THE U.S. TO AUSTRALIA**

► **Room: Guilford**

CONVENER: Angie Andriot, Presbyterian Church (USA) ([angie.andriot@pcusa.org](mailto:angie.andriot@pcusa.org))

***Jewish Denominations—***

***What we know and what we need to know***

Bruce Phillips, Hebrew Union College ([bphillips@huc.edu](mailto:bphillips@huc.edu))

***New Insights on Episcopal Clergy:***

***Race, Gender Identity, Sexual Orientation and Compensation***

Matthew Price, Church Pension Group - Episcopal Church ([mprice@cpg.org](mailto:mprice@cpg.org))

CO-AUTHOR: Alistair So-Schoos

**SATURDAY, NOVEMBER 12**

10:40AM - 12:10PM

***Congregational Vitality in a Pandemic***

Angie Andriot, Presbyterian Church (U.S.A.) ([angie.andriot@pcusa.org](mailto:angie.andriot@pcusa.org))

***Local church leaders and attenders evaluate the impact of COVID on wellbeing, faith and local church life.***

Ruth Powell, NCLS Research/Charles Sturt University ([rpowell@ncls.org.au](mailto:rpowell@ncls.org.au))

**F-16 SSSR: WOMEN IN THE PROFESSION: STRATEGIES FOR LIVING IN A POST-PANDEMIC WORLD**

► **Room: Watertable A**

ORGANIZER: Andrea Henderson, University of South Carolina ([ahenderson@sc.edu](mailto:ahenderson@sc.edu))

CONVENER: Lisa Pearce, University of North Carolina at Chapel Hill ([ldpearce@unc.edu](mailto:ldpearce@unc.edu))

PARTICIPANTS:

Amy Erica Smith, Iowa State University ([aesmith2@iastate.edu](mailto:aesmith2@iastate.edu))

Penny Edgell, University of Minnesota ([edgell@umn.edu](mailto:edgell@umn.edu))

Jacqui Frost, Purdue University ([jlfrost@purdue.edu](mailto:jlfrost@purdue.edu))

**F-17 SSSR: THE WORK LIFE OF RELIGION 1**

► **Room: Mount Washington**

CONVENER: Thad Austin, Duke University ([taustin@div.duke.edu](mailto:taustin@div.duke.edu))

***Clergy as Frontline Mental Health Care Workers: Variations in their Experiences and Views***

Anna Holleman, Duke University ([alh93@duke.edu](mailto:alh93@duke.edu))

CO-AUTHOR: Mark Chaves, Duke University

***Gender and Workplace Harassment of Mennonite and Episcopal Clergy***

Elizabeth Johnson, Duke University ([eaj12@duke.edu](mailto:eaj12@duke.edu))

CO-AUTHOR: Amy Zimbelman, Mennonite Church USA

***From "Civilian Clergy to Officer": Hiring and Training Chaplains for Federal Government Positions***

Grace Tien, Brandeis University ([gracetien@brandeis.edu](mailto:gracetien@brandeis.edu))

CO-AUTHOR 1: Wendy Cadge, [wcadge@brandeis.edu](mailto:wcadge@brandeis.edu)

***The Formation of Clergy Caregivers: An Exploratory Analysis***

Thad Austin, Duke University ([taustin@div.duke.edu](mailto:taustin@div.duke.edu))

CO-AUTHOR: Katherine Comeau, Duke University

**SSSR**  
NETWORKING LUNCH

**Saturday, November 12**  
**12:15 PM - 1:10 PM**

Maryland Foyer

**TICKETED  
EVENT**

## **SSSR PRESIDENTIAL PANEL**

Maryland C | Saturday, November 12, 1:15 PM - 2:15 PM

*Discussion of the Obligation of  
Religion Scholars to the Communities They Study*

ORGANIZER

**R. Khari Brown**

Wayne State University  
([kharib@wayne.edu](mailto:kharib@wayne.edu))

CONVENER

**Jason Shelton**

University of Texas at Arlington  
([jeshelton@uta.edu](mailto:jeshelton@uta.edu))

PANELISTS

**Tricia Bruce**

Affiliate of the University of Notre Dame and the University of Texas at San Antonio  
([tbruce@nd.edu](mailto:tbruce@nd.edu))

**Besheer Mohamed**

Pew Research Center  
([bmohamed@pewresearch.org](mailto:bmohamed@pewresearch.org))

**Rev. Charles Williams**

Historic King Solomon Baptist Church, National Action Network, University of Michigan  
([cewii@umich.edu](mailto:cewii@umich.edu))

**Richard Wood**

University of New Mexico  
([rlwood@unm.edu](mailto:rlwood@unm.edu))

# SATURDAY, NOVEMBER 12

2:20PM - 3:50PM

## PAPER SESSION G

### G-1 SSSR: EXPERIENCES OF FAITH IN THE US

► **Room: Fells Point**

CONVENER: Corey Colyer, West Virginia University ([corey.colyer@mail.wvu.edu](mailto:corey.colyer@mail.wvu.edu))

#### *New Movements in the Old Order:*

##### ***A Case Study of an Amish Separatist Movement***

Corey Colyer, West Virginia University ([corey.colyer@mail.wvu.edu](mailto:corey.colyer@mail.wvu.edu))

CO-AUTHOR 1: Rachel Stein, West Virginia University

CO-AUTHOR 2: Katie Corcoran, West Virginia University

##### ***Faith in a Nationally-Representative Sample of Farmworkers with Young Children***

Sandra Barrueco, The Catholic University of America ([barrueco@cua.edu](mailto:barrueco@cua.edu))

CO-AUTHOR: Michael Lopez, NORC at the University of Chicago

##### ***Understanding Parent-Child Relationship in Chinese Immigrant Families in the U.S.***

Joyce Chang, Baylor University ([joyce\\_chang1@baylor.edu](mailto:joyce_chang1@baylor.edu))

CO-AUTHOR: Xi Zhu, Baylor University

##### ***U.S. Adult Interactions with Chaplains***

Jessica Hamar Martinez, University of Arizona ([jhamar@arizona.edu](mailto:jhamar@arizona.edu))

CO-AUTHOR 1: Wendy Cadge, Brandeis University

CO-AUTHOR 2: Amy Lawton, Brandeis University

### G-2 SSSR: AUTHOR MEETS CRITICS - THE PORNOGRAPHY WARS: THE PAST, PRESENT, AND FUTURE OF AMERICA'S OBSCENE OBSESSION

► **Room: Maryland E**

ORGANIZER/CONVENER: Amy McDowell, University of Mississippi ([mcdowell@olemiss.edu](mailto:mcdowell@olemiss.edu))

AUTHOR: Kelsy Burke, University of Nebraska-Lincoln ([kburke@unl.edu](mailto:kburke@unl.edu))

#### PARTICIPANTS

Samuel Perry, University of Oklahoma ([samperry@ou.edu](mailto:samperry@ou.edu))

Kathryn Lofton, Yale University ([kathryn.lofton@yale.edu](mailto:kathryn.lofton@yale.edu))

Whitney Strub, Rutgers University ([wstrub@rutgers.edu](mailto:wstrub@rutgers.edu))

Bernadette Barton, Morehead State University ([b.barton@moreheadstate.edu](mailto:b.barton@moreheadstate.edu))

### G-3 RRA: RESULTS FROM THE 2022 NATIONAL SURVEY OF CATHOLIC PRIESTS (AND BISHOPS)

► **Room: Maryland C**

ORGANIZER: Tricia Bruce, University of Notre Dame ([tbruce@nd.edu](mailto:tbruce@nd.edu))

CONVENER: Brandon Vaidyanathan, Catholic University of America ([brandonv@cua.edu](mailto:brandonv@cua.edu))

#### ***Crisis, Zero-tolerance, and Mutual Trust:***

##### ***Comparing Responses from Catholic Bishops and Priests***

Christopher Jacobi, Catholic University of America ([jacobi@cua.edu](mailto:jacobi@cua.edu))

#### ***From Burnout to Flourishing:***

##### ***Well-Being Among Priests Amidst Crisis in the Church crisis.***

Brandon Vaidyanathan, Catholic University of America ([brandonv@cua.edu](mailto:brandonv@cua.edu))

CO-AUTHOR: Cella Masso-Rivetti, New York University

#### ***"These Kids Have Never Experienced That":***

##### ***Narrating the Crisis through Different Generations of Priests***

Tricia Bruce, University of Notre Dame ([tbruce@nd.edu](mailto:tbruce@nd.edu))

### G-4 SSSR: OPEN DISCUSSION WITH JOURNAL EDITORS ABOUT STANDARDS IN SOCIAL SCIENCE RESEARCH

► **Room: Watertable A**

ORGANIZER: Conrad Hackett, Pew Research Center ([chackett@pewresearch.org](mailto:chackett@pewresearch.org))

CONVENER: Andrew Whitehead,

Indiana University-Purdue University Indianapolis ([aw122@iu.edu](mailto:aw122@iu.edu))

#### ***Editor-in-Chief for the Journal for the Scientific Study of Religion***

Korie Edwards, The Ohio State University ([edwards.623@osu.edu](mailto:edwards.623@osu.edu))

#### ***Editor-in-Chief, Review of Religious Research***

Kevin J. Flannelly, Center for Psychosocial Research ([kjflannelly@gmail.com](mailto:kjflannelly@gmail.com))

#### ***Editor-in-Chief, Sociology of Religion***

Joseph O. Baker, East Tennessee State University ([bakerjo@mail.etsu.edu](mailto:bakerjo@mail.etsu.edu))

### G-5 SSSR+RRA: WHEN AND HOW RELIGIOUS CULTURE IMPACTS SOCIETY

► **Room: Gibson**

CONVENER: Paul Djupe, Denison University ([djupe@denison.edu](mailto:djupe@denison.edu))

#### ***"I took a huge risk to talk to them that thankfully was the best thing I could have done": Responding to disclosures of domestic violence in the Christian faith community***

Lisa Oakley, University of Chester ([l.oakley@chester.ac.uk](mailto:l.oakley@chester.ac.uk))

CO-AUTHOR: Clea Wright, University of Chester

#### ***Pulpits, Protests, and Prayer:***

##### ***Religious Responses to the George Floyd Murder in Minneapolis***

Jeffrey Brand, University of Northern Iowa ([jeffrey.brand@uni.edu](mailto:jeffrey.brand@uni.edu))

#### ***Don't Stop Believin':***

##### ***The Political Effects of Prosperity Gospel Perspectives***

Brian Calfano, University of Cincinnati ([brian.calfano@uc.edu](mailto:brian.calfano@uc.edu))

CO-AUTHOR 1: Paul Djupe, Denison University

CO-AUTHOR 2: Tony Carey, University of North Texas

#### ***Religious Crimping and Quipping: How Tour Guides Represent Faith and Spirituality at Sacred Destinations***

John Bartkowski, University of Texas at San Antonio

([john.bartkowski@utsa.edu](mailto:john.bartkowski@utsa.edu))

**SATURDAY, NOVEMBER 12**

2:20PM - 3:50PM

**G-6 RRA: LIVING RELIGIOUS LIFE: IT'S COMPLICATED**

► **Room: Federal Hill**

CONVENER: Mary Gautier, CARA at Georgetown University  
([gautierm@georgetown.edu](mailto:gautierm@georgetown.edu))

**"Which rite, is right?":**

**Sociological Dimensions of Catholic Ritual Contesting**

William Dinges, The Catholic University of America ([dinges@cua.edu](mailto:dinges@cua.edu))

**Local Church Leader Wellbeing and**

**Resilience in Australia During the Pandemic**

Sam Sterland, NCLS Research, Australia ([ssterland@ncls.org.au](mailto:ssterland@ncls.org.au))

**Levels and Correlates of Religiousness and  
Changes in Religiousness Among College Students**

Craig Rivera, Niagara University ([cjr@niagara.edu](mailto:cjr@niagara.edu))

**Cross-National Comparisons of Institutes of Women  
Religious and Their Newer Members: Quantitative Data  
from Four Countries**

Mary Gautier, CARA at Georgetown University ([gautierm@georgetown.edu](mailto:gautierm@georgetown.edu))

**G-7 SSSR: SECULARIZATION AND BELONGING**

► **Room: Baltimore B**

CONVENER: David Voas, University College London ([d.voas@ucl.ac.uk](mailto:d.voas@ucl.ac.uk))

**Moving away from religion: age or cohort effect?**

**Evidence from a longitudinal survey in Switzerland.**

Christophe Monnot, University of Strasbourg & University of Lausanne  
([cmmonnot@unistra.fr](mailto:cmmonnot@unistra.fr))

CO-AUTHOR: Boris Wernli, FORS, University of Lausanne

**Longing to Belong? Nonreligious**

**Belonging and Politics in the United States**

Hilary Zedlitz, University of Michigan ([zedlitz@umich.edu](mailto:zedlitz@umich.edu))

**Culture Wars and Secularization in the USA and the World**

Benjamin Beit-Hallahmi, University of Haifa ([zmirahe@yahoo.com](mailto:zmirahe@yahoo.com))

**The God we don't believe in: A proximate cause of secularization**

David Voas, University College London ([d.voas@ucl.ac.uk](mailto:d.voas@ucl.ac.uk))

**G-8 SSSR: RELIGIOUS INSTITUTIONS AND LOCAL STATE  
SECURITY: COOPERATION AND CONTESTATION**

► **Room: Homeland**

ORGANIZER: David Buckley, University of Louisville ([david.buckley@louisville.edu](mailto:david.buckley@louisville.edu))

CO-ORGANIZER: Damon Mayrl, Colby College

**Policing the Wall: How Religious Leaders and Local Law  
Enforcement Officials Interact in Eight American Communities**

Damon Mayrl, Colby College ([dwmayrl@colby.edu](mailto:dwmayrl@colby.edu))

CO-AUTHOR 1: Jonathan Coley, Oklahoma State University

CO-AUTHOR 2: Rebecca Sager, Loyola Marymount University

CO-AUTHOR 3: Gary Adler, Pennsylvania State University

**Parish-Based Responses to the Philippine Drug War**

David Buckley, University of Louisville ([david.buckley@louisville.edu](mailto:david.buckley@louisville.edu))

CO-AUTHOR: Steven Brooke, University of Wisconsin - Madison

**Evangelicals, Police & Gangs in El Salvador**

Steven Offutt, Asbury Seminary ([stephen.offutt@asburyseminary.edu](mailto:stephen.offutt@asburyseminary.edu))

**The Germ of Violence: Grant's Quaker Peace Policy  
and Legalized Securitization of Indian Country**

Bonny Cherry, University of California - Berkeley ([bonniecherry@berkeley.edu](mailto:bonniecherry@berkeley.edu))

**G-9 SSSR: POST-DENOMINATIONALISM IN A  
DENOMINATIONAL WORLD: REORGANIZING  
AMERICAN RELIGION**

► **Room: Maryland B**

ORGANIZER/CONVENER: John Melton, Baylor University

([jgordon\\_melton@baylor.edu](mailto:jgordon_melton@baylor.edu))

**Defining the "Denomination" in a Post-denominational World**

John Melton, Baylor University ([jgordon\\_melton@baylor.edu](mailto:jgordon_melton@baylor.edu))

**Nondenominational, Multidenominational, and  
Network Affiliations: the muddy reality of contemporary  
denominational identity**

Scott Thumma, Hartford Institute for Religion Research

([sthumma@hartfordinternational.edu](mailto:sthumma@hartfordinternational.edu))

**The Denomination: A Chameleon**

Russell Richey, Candler School of Theology ([richey@div.duke.edu](mailto:richey@div.duke.edu))

**The Denominational Ideal in Non-Christian Religions**

Holly Folk, Western Washington University ([folk@wwu.edu](mailto:folk@wwu.edu))

**G-10 SSSR: DECHRISTIANIZATION AND  
THE SOCIOLOGY OF AMERICAN RELIGION**

► **Room: Maryland A**

ORGANIZER/CONVENER: Dusty Hoesly, University of California, Santa Barbara

([hoesly@ucsb.edu](mailto:hoesly@ucsb.edu))

**Dechristianization, Decolonization, and Deconstruction:  
Challenges and Opportunities**

Joseph Blankholm, University of California, Santa Barbara

([blankholm@ucsb.edu](mailto:blankholm@ucsb.edu))

**Dechristianizing the Sociology of American (Ir)religion:  
Evidence from the Secular Communities Survey**

Dusty Hoesly, University of California, Santa Barbara ([hoesly@ucsb.edu](mailto:hoesly@ucsb.edu))

**Atheist Utopias: Cultivating Visions of the "Good Society"  
in Secular Congregations**

Jacqui Frost, Purdue University ([jlfrost@purdue.edu](mailto:jlfrost@purdue.edu))

**Queer, Spiritual, But Not Religious:**

**Spiritual Practice & Religious Switching Among LGB Respondents**

Evan Stewart, University of Massachusetts Boston ([evan.stewart@umb.edu](mailto:evan.stewart@umb.edu))

**SATURDAY, NOVEMBER 12**

2:20PM - 3:50PM

**G-11 SSSR: SEX, GENDER, AND THE FAMILY**

► **Room: Watertable B**

CONVENER: Carrie Miles, Baylor University, Empower International  
([carriem@fastmail.com](mailto:carriem@fastmail.com))

***Abstract: A Thematic Analysis of Gender Attitudes in a Conservative Religion***

Camilla Pracz, Georgia Southern University ([cp17859@georgiasouthern.edu](mailto:cp17859@georgiasouthern.edu))

CO-AUTHOR: Michael Nielsen, Georgia Southern University

***The Plight of Men, Culturally-Prescribed Narcissism, and Religious Extremism***

Carrie Miles, Baylor University, Empower International ([carriem@fastmail.com](mailto:carriem@fastmail.com))

***"I Refuse Immoral Work": The Influence of Religion on Sexual Practices of Brothel-based Sex Workers in India***

Popy Begum, Rutgers University-Newark ([popy.begum@rutgers.edu](mailto:popy.begum@rutgers.edu))

**G-12 SSSR: RELIGIOUS EXPERIENCES IN THE MIDDLE EAST**

► **Room: Watertable C**

CONVENER: Syed Eisar Haider, University of Notre Dame ([shaider1@nd.edu](mailto:shaider1@nd.edu))

***"The Garden of Faith is Under Threat": International Religious Freedom Advocacy on Middle East Christians***

Miray Philips, University of Minnesota ([phili191@umn.edu](mailto:phili191@umn.edu))

***Local Expressions, Global Arenas:***

***Ritual and Culture in Shia Muslim pilgrimages to Iraq***

Syed Eisar Haider, University of Notre Dame ([shaider1@nd.edu](mailto:shaider1@nd.edu))

**G-13 SSSR: THE WORK LIFE OF RELIGION 2**

► **Room: Mount Washington**

CONVENER: Thad Austin, Duke University ([taustin@div.duke.edu](mailto:taustin@div.duke.edu))

***The Cathedral as Working Capital***

J. Howard Kucher, University of Maryland, Baltimore ([jkucher@umaryland.edu](mailto:jkucher@umaryland.edu))

***Exploring the Meaning of Multivocational Ministry***

James Watson, Tyndale University ([jwatson@tyndale.ca](mailto:jwatson@tyndale.ca))

CO-AUTHOR: Mark Chapman, Tyndale University

***A Longitudinal Sociological View of American Catholic Priests (1972-2022)***

Christopher Jacobi, University of Oxford ([jacobi@cua.edu](mailto:jacobi@cua.edu))

***Money Funding Ministry:***

***The Distribution of Resources in the Field of Clergy Caregiving***

Thad Austin, Duke University ([taustin@div.duke.edu](mailto:taustin@div.duke.edu))

# SATURDAY, NOVEMBER 12

4:00PM - 5:30PM

## PAPER SESSION H

### H-1 SSSR: RELIGION AMONG AND SUPPORT FOR REFUGEES

► Room: Watertable C

CONVENER: Jaeun Kim, University of Michigan ([jaeun@umich.edu](mailto:jaeun@umich.edu))

***Precarity, permits and prayers: 'Working practices' of Congolese asylum-seeking women in Cape Town***

Henrietta Nyamnjoh, University of Cape Town ([hmambo@gmail.com](mailto:hmambo@gmail.com))

***Making Converts out of Asylum-Seekers: Korean Evangelicalism and Asylum Claims-Making on Religious Grounds***

Jaeun Kim, University of Michigan ([jaeun@umich.edu](mailto:jaeun@umich.edu))

***Faith Actors' strategies on behalf of LGBTQ+ Central American Refugees in the US: The case of the New Sanctuary Movement***

Ernesto Fiocchetto, Florida International University ([efioc001@fiu.edu](mailto:efioc001@fiu.edu))

***A Narrative Study of Chaldean Refugees and the Myth of Return***

Joseph Byle, Oakland University ([jbyle@oakland.edu](mailto:jbyle@oakland.edu))

### H-2 SSSR: RELIGION AND DEMOCRACY: BACKSLIDING AND RESILIENCE

► Room: Gibson

ORGANIZER: David Buckley, University of Louisville ([david.buckley@louisville.edu](mailto:david.buckley@louisville.edu))

CONVENER: Ruth Braunstein, University of Connecticut ([ruth.braunstein@uconn.edu](mailto:ruth.braunstein@uconn.edu))

***Regulating Public Morality:***

***State and Censorship in Authoritarian Regimes***

Sultan Tepe, University of Illinois Chicago ([sultant@uic.edu](mailto:sultant@uic.edu))

***Local Religious Leaders and Responding to Democratic***

***Backsliding: Survey Evidence from the Philippine Drug War***

David Buckley, University of Louisville ([david.buckley@louisville.edu](mailto:david.buckley@louisville.edu))

CO-AUTHOR: Steven Brooke, University of Wisconsin-Madison

***From Pastoral to Political Engagement:***

***(Re-)Evaluating the Role of African Catholic Churches in Democracy Promotion, 1990-present***

Elizabeth Sperber, University of Denver ([elizabeth.sperber@du.edu](mailto:elizabeth.sperber@du.edu))

***Curbing Christian Nationalism? A Series of Experiments***

Amy Erica Smith, Iowa State University ([aesmith2@iastate.edu](mailto:aesmith2@iastate.edu))

CO-AUTHOR 1: Paul Djupe, Denison University

CO-AUTHOR 2: Alex Tuckness, Iowa State University

### H-3 SSSR: YOUTH RELIGIOUS SOCIALIZATION

► Room: Baltimore B

CONVENER: Aida Isela Ramos, John Brown University ([aramos@jbu.edu](mailto:aramos@jbu.edu))

***Organized Religion and the Religiously Unorganized: Correlations between Student Religiosity and Chapel Experience at a Christian University***

Daniel Allen, Baylor University ([daniel\\_allen1@baylor.edu](mailto:daniel_allen1@baylor.edu))

***The Impact of Classroom Worship and Religious Programs in Developing a Relationship With God Among Students Attending Church Schools.***

Josue Anguiano-Vega, La Sierra University ([janguian@lasierra.edu](mailto:janguian@lasierra.edu))

***Rooted and Grounded in Faith: Latino Youth, Parents and Faith Leader Responses to Perceived Conflicts in Science Education***

Esmeralda Sánchez Salazar, Rice University ([esmeralda.salazar@rice.edu](mailto:esmeralda.salazar@rice.edu))

***Who Stays and Who Leaves?: First-Generation Student Retention in Religious Higher Education***

Aida Isela Ramos, John Brown University ([aramos@jbu.edu](mailto:aramos@jbu.edu))

CO-AUTHOR: Joshua Tom, Seattle Pacific University

### H-4 SSSR: MEASURING CONGREGATIONAL DIVERSITY

► Room: Pride of Baltimore

CONVENER: Jeremy Senn, Université de Lausanne ([jeremy.senn@unil.ch](mailto:jeremy.senn@unil.ch))

***Protestant Megachurch Growth: The Role of Congregant-Focused and Public-Focused Social Services***

Michael Belt, Pennsylvania State University ([mzb6133@psu.edu](mailto:mzb6133@psu.edu))

***Finding Faith in Urban Areas: The Chicago Congregations Project***

Kraig Beyerlein, University of Notre Dame ([kbeyer1@nd.edu](mailto:kbeyer1@nd.edu))

CO-AUTHOR 1: Ricardo Martínez-Schuldt, University of Notre Dame

CO-AUTHOR 2: Brie Loskota, University of Chicago

CO-AUTHOR 3: Michael Emerson, University of Illinois at Chicago

CO-AUTHOR 4: Matthew Sisk, University of Notre Dame

***Digitizing and Transcribing the 1926 Census of Religious Bodies***

Lincoln Mullen, Roy Rosenzweig Center for History and New Media,

George Mason University ([lincoln@lincolnmullen.com](mailto:lincoln@lincolnmullen.com))

CO-AUTHOR 1: John Turner, George Mason University

CO-AUTHOR 2: Caroline Greer, George Mason University

***Newcomers, stayers, and disappearances.***

***The evolution of religious diversity in the light of two National Congregations Censuses (2008 - 2021)***

Jeremy Senn, Université de Lausanne ([jeremy.senn@unil.ch](mailto:jeremy.senn@unil.ch))

CO-AUTHOR: Christophe Monnot, Université de Strasb5o7urg

**SATURDAY, NOVEMBER 12**

4:00PM - 5:30PM

### **H-5 SSSR: TEACHING THE SOCIOLOGY OF RELIGION**

#### ► Room: Mount Washington

ORGANIZER/CONVENER: Buster Smith, Catawba College ([bgsmith@catawba.edu](mailto:bgsmith@catawba.edu))

#### PANELISTS:

Nicolette Manglos-Weber, Boston University ([nmw1@bu.edu](mailto:nmw1@bu.edu))

Andrea Henderson, University of South Carolina ([akhender@mailbox.sc.edu](mailto:akhender@mailbox.sc.edu))

Patricia Tevington, Hartford Seminary ([ptevington@gmail.com](mailto:ptevington@gmail.com))

### **H-6 SSSR: MORMONISM, SCIENCE, AND AUTHORITY**

#### ► Room: St. George

ORGANIZER: Jana Riess, Religion News Service ([riess.jana@gmail.com](mailto:riess.jana@gmail.com))

CONVENER: Ryan Cragun, University of Tampa ([ryantcragun@gmail.com](mailto:ryantcragun@gmail.com))

#### ***God Is the Ultimate Scientist: LDS Conceptualizations of Science***

Ryan Cragun, University of Tampa ([ryantcragun@gmail.com](mailto:ryantcragun@gmail.com))

CO-AUTHOR: Bethany Gull, University of Utah

#### ***The Brain, Spirituality, and Mormon Claims to Authority***

Carrie Miles, Baylor University, Empower International Ministries

([carriem@fastmail.com](mailto:carriem@fastmail.com))

#### ***US Mormons and Covid***

Jana Riess, Religion News Service ([riess.jana@gmail.com](mailto:riess.jana@gmail.com))

CO-AUTHOR: Benjamin Knoll, Senior Survey Strategist, APQC

### **H-7 RRA: CARA RECENT RESEARCH ON CATHOLIC CHURCH**

#### ► Room: Maryland C

ORGANIZER: Thomas Gaunt, CARA @ Georgetown University

([tpg9@georgetown.edu](mailto:tpg9@georgetown.edu))

CONVENER: Jonathon Wiggins, CARA @ Georgetown University

([jlw8@georgetown.edu](mailto:jlw8@georgetown.edu))

#### ***Do Catholics Know What Their Church Teaches?***

#### ***A Challenge for Interpreting National Polls***

Thomas Gaunt, CARA @ Georgetown University ([tpg9@georgetown.edu](mailto:tpg9@georgetown.edu))

CO-AUTHOR: Benedict Reilly, CARA @ Georgetown University

#### ***Covid-19 Pandemic Impacts in Jesuit***

#### ***Schools Across the United States***

Maria Andronicou, CARA @ Georgetown University ([ma2111@georgetown.edu](mailto:ma2111@georgetown.edu))

#### ***Critical Issues to Elderly Care among***

#### ***Catholic Sisters Across the Globe***

Thu Do, CARA @ Georgetown University ([ttd9@georgetown.edu](mailto:ttd9@georgetown.edu))

#### ***Impacts of Vietnamese Eucharistic Youth***

#### ***Movement on the Faith Life of U.S. Catholic Youth***

Thu Do, CARA @ Georgetown University ([ttd9@georgetown.edu](mailto:ttd9@georgetown.edu))

CO-AUTHOR: Jonathon Wiggins, CARA @ Georgetown University

### **H-8 SSSR: JEWS, JUDAISM, AND ISRAEL**

#### ► Room: James

CONVENER: Becca Alper, Pew Research Center ([balper@pewresearch.org](mailto:balper@pewresearch.org))

#### ***The Radicalization of the Youths on the Hills: From Freire's Pedagogy of the Oppressed to Rabbi Ginzburgh's Messianic Soteriology***

Hannes Sonnenschein, Umeå University, Sweden

([hannes.sonnenschein@umu.se](mailto:hannes.sonnenschein@umu.se))

CO-AUTHOR: Tomas Lindgren, Umeå University, Sweden

#### ***U.S. Jews and Israel: Connections, caring, and critiques***

Justin Nortey, Pew Research Center ([jnortey@pewresearch.org](mailto:jnortey@pewresearch.org))

CO-AUTHOR: Becca Alper, Pew Research Center

#### ***Intermarriage, American Jewish, and Public Opinion: An Expert on the Impact of Experts and the Press***

Alicia Chandler, Wayne State University ([chandler@wayne.edu](mailto:chandler@wayne.edu))

#### ***H-9 SSSR: Author Meets Critics - None of the Above: Nonreligious Identity in the U.S. and Canada***

#### ► Room: Maryland E

ORGANIZER/CONVENER: Sarah Wilkins-Laflamme, University of Waterloo

([sarah.wilkins-laflamme@uwaterloo.ca](mailto:sarah.wilkins-laflamme@uwaterloo.ca))

AUTHOR: Joel Thiessen, Ambrose University ([jathiessen@ambrose.edu](mailto:jathiessen@ambrose.edu))

CO-AUTHOR: Sarah Wilkins-Laflamme, University of Waterloo

#### PARTICIPANTS

Nancy Ammerman, Boston University ([nta@bu.edu](mailto:nta@bu.edu))

Christel Manning, Sacred Heart University ([manningc@sacredheart.edu](mailto:manningc@sacredheart.edu))

David Voas, University College London ([d.voas@ucl.ac.uk](mailto:d.voas@ucl.ac.uk))

### **H-10 SSSR: RELIGION, RACE, AND HUMAN FLOURISHING**

#### ► Room: Baltimore A

CONVENER: Richard Pitt, UC San Diego ([rpitt@ucsd.edu](mailto:rpitt@ucsd.edu))

#### ***Religion Deserts: Congregational Resource Scarcity Experienced By Black Students At Predominately Undergraduate Institutions (PUI)***

Richard Pitt, University of California San Diego ([rpitt@ucsd.edu](mailto:rpitt@ucsd.edu))

#### ***Asian Hate, Minority Stress, and Religious Coping: A Study of Asian and Asian American Adults in the United States During the COVID-19 Pandemic***

Fanhao Nie, Valdosta State University ([fnie@valdosta.edu](mailto:fnie@valdosta.edu))

#### ***Religion, Race, and Self-rated Mental Health Among Retired NFL Athletes***

Evelyn Bush, Fordham University ([ebush@fordham.edu](mailto:ebush@fordham.edu))

CO-AUTHOR 1: Tim Cupery, California State, Fresno

CO-AUTHOR 2: Robert W. Turner, George Washington University

#### ***Ethnic identity and religiosity:***

#### ***Contributions to flourishing among Black emerging adults***

Meredith Hope, College of Wooster ([mhope@wooster.edu](mailto:mhope@wooster.edu))

CO-AUTHOR: Janelle Goodwill, University of Chicago



# SSSR AWARDS AND PRESIDENTIAL ADDRESS

SATURDAY, NOVEMBER 12, 5:45 PM - 7:00 PM  
Room : Maryland C

## *What's the Role of Social Science of Religion Scholars?*

R. KHARI BROWN  
Wayne State University

---

# SSSR PRESIDENTIAL RECEPTION

SPONSORED BY:  
 JOHN  
TEMPLETON  
FOUNDATION

*FOLLOWING THE PRESIDENTIAL ADDRESS*

7:00 PM - 9:00 PM  
Maryland Foyer

# SUNDAY

# NOVEMBER 13

8:00 am – 9:00 am	Morning Coffee, Sponsored by RRA	Maryland Foyer
8:00 am - 9:00 am	Coffee Hour for Interdisciplinary Researchers of Race and Religion	Guilford
8:30 am – 10:00 am	Registration Open	Maryland Foyer D
9:00 am – 10:30 am	Paper Session I	
10:40 am – 12:10 pm	Paper Session J	

## SUNDAY, NOVEMBER 13

9:00AM - 10:30AM

PAPER SESSION I

### I-1 SSSR: RELIGIOSITY AND THE LIVES OF YOUTH

► **Room: Baltimore B**

CONVENER: Patricia Herzog, IUPUI ([pshezog@iupui.edu](mailto:pshezog@iupui.edu))

***The Development of Religiosity & Generosity: Studying Youth & Emerging Adults Across Cultures***

Patricia Snell Herzog, Indiana University Lilly Family School of Philanthropy ([pshezog@iupui.edu](mailto:pshezog@iupui.edu))

CO-AUTHOR 1: Phuong Anh Nguyen, Sustainable Vietnam

CO-AUTHOR 2: Jin Ai, Indiana University Lilly Family School of Philanthropy

***"Revolutionary Love Has Freed Me More Times Than One": Liberation Praxis Imagined by Sikh Youth***

Harleen Kaur, UCLA Sociology ([harleenkaur@ucla.edu](mailto:harleenkaur@ucla.edu))

***It's all Relative: Adolescent Religiosity, Moral Beliefs, and Marijuana Use***

Scott Desmond, Indiana University Purdue University Columbus ([sadesmon@iupuc.edu](mailto:sadesmon@iupuc.edu))

***Religious Reformers: How Varied Beliefs in Eugenics Influenced Views of Juvenile Delinquency in the Post-Progressive Era***

Rachel Ellis, University of Maryland ([ellisr@umd.edu](mailto:ellisr@umd.edu))

CO-AUTHOR: Melissa Wilde, University of Pennsylvania

### I-2 SSSR: RELIGIOUS POPULISM & CHRISTIAN NATIONALISM IN THE US

► **Room: Homeland**

CONVENER: Levi Allen, University of Notre Dame ([lallen5@nd.edu](mailto:lallen5@nd.edu))

***Abortion or Race?: Experimental Evidence Towards Evangelicals' Preferences***

Levi Allen, University of Notre Dame ([lallen5@nd.edu](mailto:lallen5@nd.edu))

CO-AUTHOR: Shayla Olson, University of Michigan

***"It's Time for Some Splitting": Seeking the Conceptual Boundaries of Christian Nationalism***

Jesse Smith, Penn State University ([jus769@psu.edu](mailto:jus769@psu.edu))

***Mama Warriors: Examining the Cultural Battle Mindset Within White Evangelical Motherhood***

Laura Gilbertson, University of Minnesota ([mand0049@umn.edu](mailto:mand0049@umn.edu))

***Theosophical Influences in the Formation of North American Populism: Evidence from Discussion Forums***

Richard Rogers, Youngstown State University ([rlrogers02@ysu.edu](mailto:rlrogers02@ysu.edu))

### I-3 SSSR: RACE, RELIGION, AND THE AMERICAN SOUTH

► **Room: Baltimore A**

CONVENER: Amy McDowell, University of Mississippi ([mcdowell@olemiss.edu](mailto:mcdowell@olemiss.edu))

***Theodicy, Social Dislocation, and a Confederate Statue in Small-Town Kentucky***

David Swartz, Asbury University ([david.swartz@asbury.edu](mailto:david.swartz@asbury.edu))

***America is Divided, But the Church Cannot Be***

Amy McDowell, Associate Professor of Sociology, University of Mississippi ([mcdowell@olemiss.edu](mailto:mcdowell@olemiss.edu))

***Racially Motivated Bombings of Black Churches and Homes in Birmingham, AL during the Civil Rights Era***

Jason Wollschleger, Whitworth University ([jwollschleger@whitworth.edu](mailto:jwollschleger@whitworth.edu))

***Foundations of Mississippi: Slavery, Christianity, and Crisis***

Andrew (Drew) Gardner, Mississippi Department of Archives and History ([dgardner@mdah.ms.gov](mailto:dgardner@mdah.ms.gov))

**SUNDAY, NOVEMBER 13**

9:00AM - 10:30AM

**I-4 SSSR: RELIGIOUS CHANGE AMONG YOUTH AND  
YOUNG ADULTS: A LONGITUDINAL PERSPECTIVE**

► **Room: Pride of Baltimore**

ORGANIZER: Ariela Keysar, Trinity College ([akeysar@aol.com](mailto:akeysar@aol.com))

CONVENER: Heinz Streib, Bielefeld University, Germany ([hstreib@online.de](mailto:hstreib@online.de))

***Are Younger Americans Less Religious?***

***Unearthing Old Ground with Novel Methods***

Simon Brauer, University of Michigan ([sgbrauer@umich.edu](mailto:sgbrauer@umich.edu))

***The evolution of attitudes toward the authorship of the Torah:  
from adolescence to adulthood***

Ariela Keysar, Trinity College ([akeysar@aol.com](mailto:akeysar@aol.com))

***Psychological perspectives on developing identity and religiosity***

Benjamin Beit-Hallahmi, University of Haifa, Israel ([benny@psy.haifa.ac.il](mailto:benny@psy.haifa.ac.il))

***Losing Faith in Religion***

Ilana Horwitz, Tulane University ([ihorwitz@tulane.edu](mailto:ihorwitz@tulane.edu))

CO-AUTHOR: Landon Schnabel, Cornell University

**I-5 SSSR: RELIGION AND SPIRITUALITY IN LATIN AMERICA 1**

► **Room: Federal Hill**

ORGANIZER: Henri Gooren, Oakland University ([gooren@oakland.edu](mailto:gooren@oakland.edu))

CONVENER: Christopher Chiappari, St. Olaf College ([chiappar@stolaf.edu](mailto:chiappar@stolaf.edu))

***Longue Durée African Diaspora & Cuba's Mt. Sinai Congregation***

Jualynne Dodson, Michigan State University ([dodsonj2@msu.edu](mailto:dodsonj2@msu.edu))

***The Holistic Mission Narrative and Covid-19 in Argentina***

Geir Aasmundsen, University of Stavanger ([hans.g.aasmundsen@uis.no](mailto:hans.g.aasmundsen@uis.no))

***Images, idols and other media in Maya  
spirituality and Christianity in Guatemala***

Christopher Chiappari, St. Olaf College ([chiappar@stolaf.edu](mailto:chiappar@stolaf.edu))

***Lived Catholicisms and the "Tiempos Mixtos"  
of Latin America: First Attempt at a Model***

Jakob Egeris Thorsen, Aarhus University ([teojet@cas.au.dk](mailto:teojet@cas.au.dk))

join us for

**COFFEE HOUR**

for

**Interdisciplinary Researchers  
of Race and Religion**

---

**SUNDAY, JANUARY 13, 2022**

**8:00 AM - 9:00 AM**

**Guilford Room**

# SUNDAY, NOVEMBER 13

10:40AM - 12:10PM

## PAPER SESSION J

### J-1 SSSR: RELIGION & COVID IN CENTRAL EUROPE

► **Room: St. George**

ORGANIZER/CONVENER: Konrad Talmont-Kaminski, Society & Cognition Unit, University of Bialystok, Poland ([k.talmontkaminski@gmail.com](mailto:k.talmontkaminski@gmail.com))

***Do religious and superstitious beliefs predict conspiracy coronavirus beliefs? Findings from semi-secularized Czech society***

Alicja Zawistowska, Society & Cognition Unit, University of Bialystok, Poland ([zawistowska.alicja@gmail.com](mailto:zawistowska.alicja@gmail.com))

CO-AUTHOR 1: Radosław Poniak, Faculty of History & International Relations, University of Bialystok, Poland

CO-AUTHOR 2: Silvia Boschetti, Institute of Philosophy, Czech Academy of Science, Czech Republic

***Religiosity during the pandemic: Relief or burden? Multivariate analysis of the impact of religiosity on individual well-being in Poland***

Piotr Laskowski, Society & Cognition Unit, University of Bialystok, Poland ([pio.laskowski@gmail.com](mailto:pio.laskowski@gmail.com))

CO-AUTHOR: Łukasz Kiszkiel, Society & Cognition Unit, University of Bialystok, Poland

***Atheism and the plague: social behavior and well-being of Polish non-believers during the COVID-19 pandemic***

Paweł Łowicki, Department of Psychology, University of Warsaw, Poland ([pawel.lowicki@psych.uw.edu.pl](mailto:pawel.lowicki@psych.uw.edu.pl))

### J-2 SSSR: EXPLORING THE PANDEMIC IMPACT ON CONGREGATIONS: RACE, RESOURCES, AND RESTRUCTURING IN THREE US CITIES

► **Room: Pride of Baltimore**

ORGANIZER/CONVENER: Allison Norton, Hartford Institute for Religion Research @ Hartford International University ([anorton@hartfordinternational.edu](mailto:anorton@hartfordinternational.edu))

***Religious Congregations' Adaptation to Change in Indianapolis, IN***

Arthur E. Farnsley, The Center for the Study of Religion & American Culture, IUPUI ([afarnsle@iupui.edu](mailto:afarnsle@iupui.edu))

***Race, Resources, and Restructuring in Denver Area Congregations***

Kristina Lizardy-Hajbi, ILIFF School of Theology ([klizardy@iliff.edu](mailto:klizardy@iliff.edu))

***Withdrawal, Introspection, and Mobilization: How Twin Cities Churches Respond to Crisis***

Penny Edgell, University of Minnesota-Twin Cities ([edgell@umn.edu](mailto:edgell@umn.edu))

CO-AUTHOR 1: Laura Gilbertson, University of Minnesota-Twin Cities

CO-AUTHOR 2: Daniel Cueto-Villalobos, University of Minnesota-Twin Cities

### J-3 SSSR: RELIGION AND VIEWS ON RACE AND ETHNICITY IN THE US

► **Room: Baltimore A**

CONVENER: Anna Klie, TU Dortmund University, Germany ([anna.klie@tu-dortmund.de](mailto:anna.klie@tu-dortmund.de))

***Differentiated Threat:***

***Islamophobia and Xenophobia in the United States***

Anthony Albanese, Pennsylvania State University ([aka5972@psu.edu](mailto:aka5972@psu.edu))

CO-AUTHOR: Allison Kurpiel, Pennsylvania State University

***Christian Nationalism and Resistance to Humanitarian Appeals: The Case of Refugee Resettlement***

Stephanie Shady, The University of North Carolina at Chapel Hill ([stephns@live.unc.edu](mailto:stephns@live.unc.edu))

***Religious Orientations and Assessments of Refugee Immigration in Europe - Relations to Consider***

Anna Wiebke Klie, TU Dortmund University, Germany ([anna.klie@tu-dortmund.de](mailto:anna.klie@tu-dortmund.de))

CO-AUTHOR 1: Jonas Bonke, TU Dortmund University, Germany

CO-AUTHOR 2: Alexander Unser, TU Dortmund University, Germany

***Entanglements of Religion, Politics, and Forced Migration: The ambivalent role of Christianity in the migratory crises in Central America***

Ernesto Fiocchetto, Florida International University ([efioc001@fiu.edu](mailto:efioc001@fiu.edu))

### J-4 SSSR: RELIGION, VOTING, AND IDEOLOGY

► **Room: Homeland**

CONVENER: Gerard Rainville, AARP ([chuck.rainville@gmail.com](mailto:chuck.rainville@gmail.com))

***Religiousness Measures and the Latent Demand for Strongarm Leaders in Brazil***

Gerard Rainville, AARP ([chuck.rainville@gmail.com](mailto:chuck.rainville@gmail.com))

CO-AUTHOR: Cheryl Lampkin, AARP

***Political Heretics?:***

***Why Voters Act in Defiance of their Social Identities***

Levi Allen, University of Notre Dame ([lallen5@nd.edu](mailto:lallen5@nd.edu))

***Ideology Revisited:***

***Capitalism, Social Structure, and Evangelical Congregations***

Dawson Vosburg, The Ohio State University ([vosburg.4@osu.edu](mailto:vosburg.4@osu.edu))

***What Kind of Victims are Trump supporters?***

Ruiqian (Richie) Li, Baylor University ([richie\\_li1@baylor.edu](mailto:richie_li1@baylor.edu))

**SUNDAY, NOVEMBER 13**

**10:40AM - 12:10PM**

**PAPER SESSION J**

**J-5 SSSR: RELIGION AND SPIRITUALITY IN LATIN AMERICA 2**

► **Room: Federal Hill**

ORGANIZER: Henri Gooren, Oakland University ([gooren@oakland.edu](mailto:gooren@oakland.edu))

CONVENER: Christopher Chiappari, St. Olaf College ([chiappari@stolaf.edu](mailto:chiappari@stolaf.edu))

***Religion and the Pueblo in the Wake of Crisis***

Julianne Bryant, Biola University ([julianne.bryant@biola.edu](mailto:julianne.bryant@biola.edu))

CO-AUTHOR: Melanie Nyhof, Carthage College

***Pentecostalism, Calvinism, and Politics in Latin America***

Henri Gooren, Oakland University ([gooren@oakland.edu](mailto:gooren@oakland.edu))

***Bread Babies: Play among Religion, Culture, and Society in Cusco, Peru during All Saints and All Souls***

David Knowlton, Utah Valley University ([davidknowlton@yahoo.com](mailto:davidknowlton@yahoo.com))

**J-6 SSSR: THE LOGIC OF RELIGIOUS ORGANIZATIONS**

► **Room: Baltimore B**

CONVENER: Jared Bok, University of Nevada, Reno ([jbok@unr.edu](mailto:jbok@unr.edu))

***An Economic Model with Other Worldly Goods, Punishing Gods, the Divine Factor and Religious Rules with Regard to the Economy***

Resit Ergener, Bosphorus University ([resit.ergener@gmail.com](mailto:resit.ergener@gmail.com))

***Controversy and Image Management in 3HO/Sikh Dharma***

Simranjit Khalsa, The University of Memphis ([skhalsa@memphis.edu](mailto:skhalsa@memphis.edu))

***Jehovah's Witnesses in Armenia: Maintaining Commitment and Facilitating Growth During the Pandemic***

Anatolii Tokmantcev, University of California Los Angeles

([atokmantcev@ucla.edu](mailto:atokmantcev@ucla.edu))

***The Costs of Exist Costs: A Theoretical Framework in Conversation with Strictness Theory***

Jared Bok, University of Nevada, Reno ([jbok@unr.edu](mailto:jbok@unr.edu))

# SSSR + RRA

SOCIETY FOR THE SCIENTIFIC STUDY OF RELIGION + RELIGIOUS RESEARCH ASSOCIATION **CALL FOR PAPERS**  
2023 Annual Meeting | October 20-22, 2023 | Salt Lake Marriott Downtown at City Creek, Salt Lake City, Utah, USA

## *Religion, Empowering or Oppressing People and Communities?*

Under what conditions are religion and religious communities forces for good and under what conditions are they forces for bad in society? In what ways do religious groups, informal gatherings, networks, and organizations empower and support as well as oppress and harm those currently and previously attached to them and the broader community? How should we theoretically and empirically approach this topic? What factors—for example differences in theology, power dynamics, and social environments—explain why certain religious groups empower while others oppress those within and outside of their faith communities? What are the consequences of religious-based support and harm? To what extent does the former affect continuity in people's religious and spiritual beliefs, commitments, and practices as well as how community residents view and relate to faith-based institutions? What types of religious-based harm cause people to leave their spiritual homes and origins, sometimes forever, and create conflict with the larger community?

The role of religion in fostering social cohesion and alleviation of inequalities as well as its role in fostering violence and societal disintegration are longstanding and still relevant topics today, for the social sciences as well as for faith communities and the broader public.

The 2023 joint SSSR+RRA call for papers encourages proposals that address one or more of these questions. We are interested in proposals building on basic research (SSSR) that employ a range of methodologies as well as draw on established and novel data. We also seek proposals on this topic that are not only relevant for the scholarly community, but also those that have an applied research focus (RRA). And we welcome proposals on any topic within the social scientific study of religion that examines how religious denominations, groups, or traditions relate to these topics.

The SSSR+RRA annual meeting will feature paper sessions and book panels (formerly known as “author-meets-critics” sessions). Submit complete paper sessions—consisting of three to four presentations—or individual proposals (which the program chairs will thematically organize). Proposals for book panels should contain the author of a recent book and three to four panelists.

All submissions will be made through the online portal at [www.sssreligion.org](http://www.sssreligion.org). Please indicate the type of submission (e.g., individual paper or book panel) and whether it is a better fit for SSSR or RRA. Please contact SSSR programs chairs, Shaonta' Allen ([Shaonta.Allen@Dartmouth.edu](mailto:Shaonta.Allen@Dartmouth.edu)) and Jason Klocek ([Jason.Klocek@nottingham.ac.uk](mailto:Jason.Klocek@nottingham.ac.uk)) or RRA program chair Brenton Kalinowski ([bdk6@rice.edu](mailto:bdk6@rice.edu)) with any questions.

Submissions open: February 1, 2023

Submissions close: March 31, 2023

Decisions made: April 30, 2023

# THANK YOU

## **Our sincere thanks goes to . . .**

The **Religious Research Association** for sponsoring coffee each morning.

**Paul Djupe** and **Amy Erica Smith** for serving as the SSSR Program Co-Chairs

**Cory Anderson** for serving as the RRA Program Chair and partner with Paul and Amy on this year's program journey.

**Alicia Chandler** for serving as the Graduate Student Ambassador, and **Bernard DiGregorio**, who assisted Alicia in organizing the Graduate Student Session.

All of our session conveners, who kept everyone on time.

**Harve Horowitz** and **Kelly Marshall** from Exhibit Promotion Plus, who coordinated our book exhibit and annual meeting site selection.

**Mel Hagen** and the entire team from the Renaissance Baltimore Harborplace Hotel for their professionalism and support during the annual meeting.

# INDEX

## A

Aasmundsen, Geir: I-5  
Abdelhadi, Eman: B-6  
Adelakun, Abimbola: D-2  
Adler, Gary: E-12, G-8  
Adogame, Afe: D-2  
Ai, Jin: I-1  
Albanese, Anthony: J-3  
Allen, Daniel: A-9, H-3  
Allen, Levi: B-11, I-2, J-4  
Allen, Shaonta: B-12  
Allington, Daniel: A-7  
Alper, Becka: A-11, H-8  
Alvarado, Joshua: A-11  
Ammerman, Nancy: H-9  
Anderson, Cory: A-8, C-1  
Andrews, William: C-17  
Andriot, Angie: F-15  
Andronicou, Maria: H-7  
Anguiano-Vega, Josue: H-3  
Anthony, Joseph: E-10  
Anugwom, Edlyne: E-4  
Anugwom, Kenechukwu: E-4  
Anwar, Kainaat: D-9  
Apaah, Felicity: C-6, D-2  
Arandjelovic, Dunja: B-14  
Arias, Fabian: A-10  
Ariel, Yaakov: B-8  
Arnold, Lena: A-7  
Atkinson, Andrew: F-2  
Austin, Thad: C-2, F-17, G-13

## B

Bacon, Rachel: D-1  
Bader, Christopher: F-9  
Bailey, Karl: C-12  
Baker, Christine: B-9  
Baker, Joseph: C-3, F-9, G-4  
Baker, Spencer: A-6  
Bakker, Janel Kragt: C-9  
Baltazar, Alina: C-12  
Barnett, Susan: B-2, D-11  
Barrueco, Sandra: G-1  
Bartkowski, John: G-5  
Barton, Bernadette: G-2  
Bateye, Bolaji: E-4  
Bateye, Olukemi: E-4  
Baumann, Roger: B-5  
Beckman, Diane: C-10  
Begum, Popy: G-11  
Beider, Nadia: B-10  
Beit-Hallahmi, Benjamin: E-12, G-7, I-4

Belt, Michael: H-4  
Berger, Helen A.: E-8  
Beyer, Peter: B-1  
Beyerlein, Kraig: A-10, E-8, H-4  
Biolcati-Rinaldi, Ferruccio: B-1  
Bird, Warren: B-2, C-15  
Blankholm, Joseph: A-2, G-10  
Boddie, Stephanie: B-5, D-3  
Bok, Jared: J-6  
Bolger, Daniel: D-6  
Bonke, Jonas: J-3  
Boschetti, Silvia: F-7, J-1  
Bossi, Luca: B-1  
Brand, Jeffrey: G-5  
Brantley, Mia: E-2  
Brauer, Simon: I-4  
Braunstein, Ruth: C-14, E-15, H-2  
Britton, Willoughby: C-13  
Brooke, Steven: G-8, H-2  
Brown, Maria: A-2  
Brown, R. Khari:  
    SSSR Awards and Presidential Address  
    SSSR Presidential Panel  
Bruce, Tricia: A-12, E-1, F-14, G-3  
    SSSR Presidential Panel  
Bryant, Julianne: J-5  
Buckley, David: G-8, H-2  
Bullik, Ramona: C-17  
Bunnell, Andy: B-14  
Burger, Annetta: D-1  
Burke, Kelsy: C-14, G-2  
Burney, Saleema: D-6  
Burt, Jason: A-9, B-15  
Bush, Evelyn: H-10  
Byle, Joseph: H-1

## C

Cabria, Marcello: B-1  
Cadge, Wendy: F-17, G-1  
Calfano, Brian: G-5  
Calvillo, Jonathan: E-2  
Campbell, David: C-8  
Cantori, Valentina: B-6  
Cao, Vy: F-4  
Caplan, Lee: B-8  
Carey, Tony: G-5  
Carriero, Renzo: B-1  
Chalfoun, Andrew: B-11  
Chan, Esther: C-3, F-1  
Chandler, Alicia: H-8  
Chang, Joyce: G-1  
Chapman, Amy L.: C-16  
Chapman, Mark: A-13, G-13

Chaves, Mark: D-8, E-1, F-17  
Chen, Zhuo Job: C-17, F-4  
Cherry, Bonny: G-8  
Chiappari, Christopher: I-5, J-5  
Chipman Gilliland, Claire: F-12  
Chitwood, Ken: E-11  
Chouhoud, Youssef: F-5  
Ciftci, Sabri: F-2  
Cimino, Richard: E-2  
Cincala, Petr: A-3, C-12, E-6  
Clark, Tom: F-9  
Clydesdale, Tim: B-16  
Cobb, Ryon: A-5  
Coe, Deborah: C-6, D-7  
Coley, Jonathan: E-10, G-8  
Colyer, Corey: A-4, G-1  
Comeau, Katherine: C-2, F-17  
Cooper, Katherine R.: C-9  
Cooper, Lynn O.: C-9  
Corcoran, Katie: A-4, D-6, G-1  
Counted, Victor: C-11  
Cowden, Richard: C-11  
Cox, Mackenzie: F-11  
Cragun, Ryan: F-14, H-6  
Cranney, Stephen: E-9  
Cueto-Villalobos, Daniel: J-2  
Cupery, Tim: H-10

## D

Daniels, Denise: C-7  
Danielsen, Sabrina: A-11  
Davis, Ward: B-9  
DeDeyne, Jesse: F-3  
Dejean, Frédéric: A-13  
Delehanty, Jack: C-14  
Desmond, Scott: I-1  
Dhali, Helal Hossain: B-6  
Dhingra, Swati: B-6  
DiGregorio, Bernard: A-4, D-6  
Dilimulati, Maihemuti: B-6  
Dinges, William: G-6  
Dinsmore, Jonathan: A-6  
Djupe, Paul: E-15, G-5, H-2  
Do, Thu: H-7  
Dodson, Jualynne: I-5  
Dollahite, David: E-13  
Dollhopf, Erica: A-3, D-12  
Dollmann, Jörg: A-7  
Dougherty, Kevin: A-8, D-7, F-10  
Dromi, Shai: E-12  
Drumm, René: A-3, C-12  
Dugandzic, Audra: F-12  
Durham, Matthew: A-6, C-17



# INDEX

## E

Eagle, David: B-13, C-2, E-16, F-13  
Ecklund, Elaine: C-7, D-6, E-1  
Edgell, Penny: E-1, F-16, J-2  
Edstrom, Leihua: F-7  
Edwards, Korie: B-4, C-3, D-5, F-10, G-4,  
RRA Presidential Panel  
Ellis, Rachel: I-1  
Emeka-Nwobia, Ngozi U.: E-7  
Epstein, Joshua: D-1  
Ergener, Resit: J-6  
Evans, Hannah: B-12, F-11

## F

Farnsley, Arthur E.: J-2  
Farrag, Hebah: E-11  
Finke, Roger: D-7, D-10  
Fiocchetto, Ernesto: H-1, J-3  
Fitzgerald, Caitlin: E-9  
Flannelly, Kevin J.: G-4  
Folk, Holly: G-9  
Foye, Ashley: D-9  
Frame, Nic: B-10  
Franklin, Andrew: D-3  
Frost, Jacqui: A-1, C-3, F-16, G-10

## G

Gaghan, Josh: B-13, E-16  
Gardner, Andrew: D-8  
Gardner, Andrew (Drew): I-3  
Gault, Erika: A-5  
Gaunt, Thomas: H-7  
Gautier, Mary: D-7, G-6  
Ghosh, Ratna: B-6  
Gilbertson, Laura: I-2, J-2  
Gilger, SJ, Patrick: E-12  
Gilkes, Cheryl Townsend: E-15  
Gin, Deborah: E-17  
Glazier, Stephen: E-14  
Goatley, David Emmanuel: C-2  
Goff, Kerby: F-12  
Goff, Philip: E-15  
Goldstein, Warren: F-14  
Gonda, Gillian: F-8  
Goodwill, Janelle: H-10  
Gooren, Henri: I-5, J-5  
Gosin, Monika: D-3  
Grammich, Clifford: C-1, D-12  
Green, John: C-8  
Greenhalgh, Spencer: C-16  
Greer, Caroline: H-4  
Guardado, Leo: A-10

Gugushvili, Alexi: E-16  
Gull, Bethany: H-6  
Gunning Francis, Leah: C-9  
Guth, James: C-10  
Guthrie, Sara: A-4  
Guven, Ibrahim Furkan: F-9  
Guven, Metin: E-9  
Gärtner, Christel: A-2

## H

Haberski, Jr., Raymond J.: E-15  
Hackett, Conrad: E-5, G-4  
Haider, Syed Eisar: G-12  
Hamar Martinez, Jessica: G-1  
Haraburda, Bailey: F-7  
Hargittai, Eszter: D-6  
Haskins, Natoya: A-5  
Hatna, Erez: D-1  
Headley, Jennifer: B-13  
Hegy, Pierre: A-9, B-3, C-5  
Henderson, Andrea: B-4, D-6, E-2, F-15, H-5  
Hernandez, Amanda: B-12  
Herzog, Albert: D-5  
Herzog, Patricia Snell: I-1  
Hickman, Jared: B-7  
Hirono, Tatsushi: D-4  
Hoesly, Dusty: A-2, G-10  
Hoffmann, John: C-16  
Holleman, Anna: B-13, E-17, F-17  
Holt Moore, Kendra: C-13  
Holtmann, Catherine: A-13, B-15  
Hood, Jr., Ralph W.: A-6, C-17  
Hope, Meredith: A-5, D-9, H-10  
Hopson, Ronald: B-8  
Horwitz, Ilana: B-16, I-4  
Houseal, Rich: C-1, D-12  
Hsu, Becky: F-4  
Huang, Jianbo: E-6  
Humphreys, Justin: A-8  
Hwang, Woosang: A-2

## I

Isaac, Victoria: F-1  
Ishak, Christian: A-6

## J

Jacobi, Christopher: F-7, G-13  
Jamal, Aamir: B-6  
James, Molly: A-3  
James, Spencer: E-13  
Jeong, Elijah: F-1  
Ji, Chang-ho: B-11, F-4  
Jinadu, Comfort: E-4

Johnson, Andre E.: B-5  
Johnson, Elizabeth: F-17  
Johnston, Erin: A-1, B-13, E-17  
Jones, Dale: D-12  
Jones, Rory: C-13  
Jones, Stephen: D-6  
Jung, Jihye: E-6

## K

Kalinowski, Brenton: C-7  
Kallatsa, Laura: A-2  
Karpov, Vyacheslav: E-3  
Kasun, Paul: B-3  
Kaur, Harleen: I-1  
Keller, Barbara: C-17  
Kelley, Heather: E-13  
Kelley, Katheryn: F-5  
Kent, Blake: C-11  
Keysar, Ariela: I-4  
Khalsa, Simranjit: J-6  
Kilp, Alar: E-3  
Kim, Jaeun: H-1  
King, Wes: E-10  
Kirk, James: B-11, C-10  
Kisziel, Łukasz: D-1, J-1  
Kitchens, Michael B.: F-5  
Klie, Anna: J-3  
Klocek, Jason: E-8  
Knoll, Benjamin: C-16, H-6  
Knowlton, David: J-5  
Koch, Daniel: F-7  
Koch, Jerome: A-8  
Kochendorfer, Logan: D-9  
Koka, Eric: D-2  
Kong, Lily: D-10  
Kopecky, Robin: F-7  
Kraus, Rachel: D-7, E-9  
Krindatch, Alexei: B-2, C-1  
Krull, Laura: E-17  
Kucher, J. Howard: G-13  
Kucinkas, Jaime: A-1  
Kurien, Prema: C-4  
Kurpiel, Allison: J-3  
Körs, Anna: F-6

## L

Ladd, Kevin: B-9  
Lafferty, Moira: C-15  
Lampkin, Cheryl: J-4  
Lang, Isabella M.: F-5  
Langston, Joseph: C-8  
Laskowski, Piotr: D-1, J-1  
Lassiter, Jonathan Mathias: D-9

# INDEX

Lauve-Moon, Katie: E-10  
Lauve-Moon, Timothy: C-4, E-10  
Lawton, Amy: G-1  
Layman, Geoffrey: C-8  
Laymon, Barbara: B-9  
Lee, Lois: C-8  
Lee, Song Chong: F-9  
Levin-Aspenson, Holly: C-13  
Li, Ruiqian (Richie): J-4  
Lindgren, Tomas: E-8, H-8  
Liu, Yan: B-14  
Lizardy-Hajbi, Kristina: E-17, J-2  
Lofton, Kathryn: G-2  
Lopez, Michael: G-1

## M

Mabute-Louie, Bianca: D-6  
MacGregor, Carol Ann: B-16  
Machado, Katherine: F-5  
Mackay, Annette: A-4  
Madison-McCreary, Jacqueline: C-2  
Magyar-Russell, Gina: C-5  
Majumder, Shantanu: D-4  
Malone, Joanna: B-10  
Manglos-Weber, Nicolette: A-1, E-7, H-5  
Manning, Christel: H-9  
Marks, Loren: E-13  
Marler, Will: D-6  
Marroccoli, Giulia: B-1  
Marti, Gerardo: C-4, D-8, E-15, F-10  
Martinez, Brandon C.: C-4  
Martínez-Schuldt, Ricardo: H-4  
Masso-Rivetti, Cella: G-3  
Mataic, Dane: D-10  
Mayrl, Damon: C-14, G-8  
Mays, Cindy: D-9  
McAndrew, Siobhan: A-7, F-6  
McBride, Duane: C-12  
McClure, Jennifer: E-14, F-3  
McClure, Paul: A-9  
McDowell, Amy: G-2, I-3  
McElroy, Elizabeth: D-9  
McMullin, Stephen: A-13  
Mehegan, Laura: C-11  
Melton, John: G-9  
Meulenberg, Michal: C-2  
Michalka, Karen: A-12  
Middleton, Kathryn: F-11  
Miles, Carrie: G-11, H-6  
Miller, Arpi: E-11  
Miller, Brian: A-8  
Miller, Donald: E-11  
Moaddel, Mansoor: F-2

Mohamed, Besheer:  
    SSSR Presidential Panel  
Mohammed, Mohammed: F-8  
Mok, Chit Wai John: B-3  
Molteni, Francesco: B-1, E-16  
Monnot, Christophe: G-7, H-4  
Moxham-Hall, Vivienne: A-7  
Mulder, Mark T.: F-10  
Mullen, Lincoln: H-4  
Murphy, Thomas: B-7

## N

Neal, Carrie E.: E-10  
Newman, Mark: C-10  
Newton, Taylor: A-7  
Nguyen, Phuong Anh: I-1  
Nie, Fanhao: H-10  
Nielsen, Michael: E-1, F-5, G-11  
Nortey, Justin: H-8  
Norton, Allison: D-2, F-11, J-2  
Nourelidin, Laila: A-5  
Noy, Shiri: D-6  
Nyamnjoh, Henrietta: H-1  
Nyhof, Melanie: J-5

## O

O'Brien, Timothy: C-3, D-6  
Oakley, Lisa: A-8, C-15, G-5  
Offutt, Steven: G-8  
Ogawa, Yukan: D-4  
Ogera, E. Okelloh: C-6  
Ogunnowo, Olannike: D-2  
Oguntola Laguda, Danoye: E-7  
Okera, Okello: D-2  
Okuwobi, Oneya: C-7  
Olayinka, Temidayo: E-4  
Olson, Laura: B-14  
Olson, Shayla: I-2  
Orndorff, Joshua: C-15, F-9  
Ortiz, Selena: D-4  
Ostergard, William: F-5  
Owusu Afari, Stella: D-2

## P

Palitsky, Roman: C-13, F-4  
Palomo, Johannah: C-12  
Pankhurst, Jerry: E-3  
Park, Jerry: C-4  
Parker, Janise: A-5  
Parsitau, Damaris: D-2  
Pearce, Lisa: D-5, F-16  
Pepper, Miriam: D-5  
Perry, Samuel: C-14, D-9, G-2

Peterson, Anna: F-14  
Petrasic, Sydney E.: F-5  
Philips, Miray: D-10, G-12  
Phillips, Bruce: F-15  
Pieper, Christopher: C-4  
Pitt, Richard: B-16, H-10  
Pogorelc, Anthony: B-3, D-7  
Poniat, Radosław: J-1  
Porter, Nathaniel: F-4  
Porth, Stephen: C-15  
Powell, Ruth: D-5, F-15  
Pracz, Camilla: G-11  
Pratt, Tia Noelle: B-5  
Price, Matthew: F-15  
Prince, Tryce: F-10  
Proeschold-Bell, Rae Jean: B-13, C-2  
Pudlo, Jason: A-11  
Příplatová, Lenka: F-7

## Q

Quezada, Enrique: E-8

## R

Racine, Kathryn: B-9  
Rahimi, Babak: F-2  
Rainville, Gerard: C-11, J-4  
Ramos, Aida Isela: B-4, E-2, H-3  
Rapheal, Ojo Joseph: E-4  
Reed, Jean-Pierre: F-14  
Reilly, Benedict: H-7  
Reimer, Sam: A-13, E-16  
Reynolds, Amy: F-1  
Richey, Russell: G-9  
Ricucci, Roberta: A-2, B-1  
Riess, Jana: C-16, H-6  
Rivera Ramos, Marina: F-10  
Rivera, Craig: G-6  
Rogers, Richard: I-2  
Roso, Joseph: D-8  
Rosta, Gergely: B-1  
Royston, Jashalund: D-11  
Russell Taylor, Adam: F-8  
Rymarz, Richard: E-14

## S

Sachs-Kohen, Rabbi Elissa: A-10  
Sager, Rebecca: G-8  
Saiya, Nilay: B-8  
Salazar, Esmeralda Sánchez: H-3  
Scarbeck, Nathan: A-6  
Schade, Leah: D-8, F-1  
Scheitle, Christopher: A-4, D-6  
Schnabel, Landon: F-13, I-4

# INDEX

Schneider, Rachel: F-1  
Scott, Anthony: D-5  
Scott, Marquisha: A-11  
Senn, Jeremy: H-4  
Seog, Changhoon: C-11  
Serrano, Jesús Antonio: C-5  
Seto, Christopher: D-4  
Sevinc, Kenan: F-2  
Shady, Stephanie: D-8, J-3  
Shamaileh, Ammar: F-2  
Shapiro, Ephraim: B-8  
Sheffert, Aynsley: C-6  
Shelton, Jason:  
    SSSR Presidential Panel  
Sherman, Jennifer: A-12  
Shillitoe, Rachael: C-8  
Shiu, Zoe: C-12  
Silverstein, Merrill: A-2, B-1  
Simmons, Ellie: A-11  
Singer, Mendel: B-8  
Sisk, Matthew: H-4  
Skrzypińska, Katarzyna: E-9  
Smith, Amy Erica: F-16, H-2  
Smith, Buster: H-5  
Smith, Jesse: I-2  
Snodgrass, Jill: C-5  
Snyder, Tim: C-6  
So-Schoos, Alistair – F-15  
Sogah, Emmanuel: E-14  
Sonnenschein, Hannes: E-8, H-8  
Soroka, George: C-6  
Sperber, Elizabeth: H-2  
Spickard, James: C-13  
Spännäri, Jenni: A-2 St.  
Sume, Je: B-10  
Stabler, Samuel: E-12  
Stachowska, Ewa: F-6  
Starman, Tess: B-8  
Steensland, Brian: A-1, F-8  
Steeves, Katie: B-15  
Stein, Rachel: A-4, G-1  
Steppacher, Anika: C-17  
Sterland, Sam: D-11, G-6  
Stewart, Evan: A-1, C-14, G-10  
Stewart-Sicking, Joseph: B-9, C-5  
Stolz, Jörg: E-16  
Streib, Heinz: C-17, I-4  
Strhan, Anna: C-8  
Strickland-Harris, Sabrina: F-12  
Stroope, Samuel: F-4  
Strub, Whitney: G-2  
Suehr, Christopher: B-3, C-8  
Sun, Anna: A-1

Swanson, Zachary: A-6  
Swartz, David: I-3  
Sweida-Metwally, Samir: D-10  
Szetelszky, Zsuzsanna: B-1

## T

Tagayuna, Arlie: F-11  
Takase, Akinori: D-4  
Talmont-Kaminski, Konrad: D-1, J-1  
Tatarczyk, Dawid: F-3  
Taylor-Abdulai, Hannah: A-7, D-2  
Tepe, Sultan: H-2  
Tervo-Niemelä, Kati: A-2, B-1, D-11  
Tevington, Patricia: F-11, H-5  
The, Christopher M.: E-17  
Thiessen, Joel: A-13, B-15, H-9  
Thomas, Patricia: F-7  
Thomas, Shirley-Ann: B-11  
Thompson, Wayne: D-8, F-1  
Thomson, Robert: F-1  
Thorsen, Jakob Egeris: I-5  
Thumma, Scott: A-3, B-2, G-9  
Tice, Logan: B-13, C-2  
Tien, Grace: F-17  
Timol, Riyaz: D-6  
Tinsley, Cleve: F-1  
Tokke, Hans: E-2  
Tokmantcev, Anatolii: J-6  
Tom, Joshua: H-3  
Trecartin, Shannon: C-12, E-6  
Trim, David: C-12  
Tse, Justin: E-12  
Tuckness, Alex: H-2  
Turner, John: H-4  
Turner, Robert W.: H-10

## U

Uecker, Jeremy: A-9  
Ulu, Mustafa: F-5  
Umezurike, Grace: E-7  
Underwood, Joshua: F-10  
Unser, Alexander: J-3  
Upenieks, Laura: F-7

## V

Vaidyanathan, Brandon: E-9, F-11, G-3  
Vala, Carsten: E-6  
Vaughan, Kenneth: C-4  
Vekovic, Marko: B-14, F-6  
Verghese, Ajay: F-4  
Voas, David: D-1, E-5, F-13, G-7, H-9  
Vosburg, Dawson: J-4  
Vovk, Dmytro: E-3

## W

Wang, David: E-17  
Watson, James: A-13  
Watts, Galen: G-13  
Wayt, Virginia: F-12  
Weaver-Swartz, Lisa: A-12  
Wernli, Boris: G-7  
Whitehead, Andrew: C-13, E-15, G-4  
Whitnah, Meredith: A-12  
Whitney, Lawrence: D-3  
Wienk, Ruthie: F-11  
Wiggins, Jonathon: H-7  
Wilde, Melissa: I-1  
Wildman, Wesley: D-1  
Wilkins-Laflamme, Sarah: E-16, F-13, H-9  
Wilkinson, Michael: B-15  
Williams, Dodeye: D-2  
Williams, Rev. Charles:  
    SSSR Presidential Panel  
Williams, Rhys: B-16, E-15, F-14  
Wilson Harper, Amanda: C-6, D-8, F-1  
Winchester, Daniel: E-6  
Wittberg, Patricia: D-7, F-3  
Wollschleger, Jason: I-3  
Wong, Arch: B-15  
Wong, Janelle: B-10  
Wood, Richard: F-14  
    SSSR Presidential Panel  
Woodruff, Kelsey: F-12  
Woods, Orlando: D-10  
Wright, Clea: G-5  
Wuthrich, Michael: F-2

## X

Xiao, Yunze: E-6

## Y

Yao, Jia: C-2  
Young, Luther: B-4, E-10

## Z

Zawistowska, Alicja: J-1  
Zedlitz, Hilary: G-7  
Zhang, Enze: B-11  
Zhu, Xi: G-1  
Zimbelman, Amy: F-17  
Zurlo, Gina: D-1, E-5, F-12

Ògúnàjò, Bùsáyò Ọláníyì: E-4  
łowicki, Paweł: J-1

# PAST PRESIDENTS

## PRESIDENTS OF SSSR

1949 Walter H. Clark  
1952 Talcott Parsons  
1954 Prentiss Pemberton  
1956 Richard V. McCann  
1958 James Luther Adams  
1960 Horace Kallen  
1962 Horace L. Friess  
1964 Walter H. Clark  
1966 Peter L. Berger  
1968 Charles Y. Glock  
1970 Joseph H. Fichter  
1974 Paul W. Pruyser  
1976 Allan W. Eister  
1978 William V. D'Antonio  
1980 Benton Johnson  
1982 Marie Augusta Neal  
1984 Jeffrey K. Hadden  
1986 Phillip E. Hammond  
1988 Meredith McGuire  
1990 Donald Capps  
1992 Eileen Barker  
1994 Ruth Wallace  
1996 Wade Clark Roof  
1998 Jay Demerath  
2000 Helen Rose Ebaugh  
2002 Robert Wuthnow  
2003 Rodney Stark  
2004 Nancy Ammerman  
2005 Donald Miller  
2006 R. Stephen Warner  
2007 Dean Hoge  
2008 Mark Chaves  
2009 Katherine Meyer  
2010 James Beckford  
2011 Rhys H. Williams  
2012 Michele Dillon  
2013 James Richardson  
2014 Fenggang Yang  
2015 Corwin Smidt  
2016 Nancy Nason-Clark  
2017 Korie L. Edwards  
2018 Elaine Howard Ecklund  
2019 Laura Olson  
2020 Prema Kurien  
2021 R. Khari Brown

## PRESIDENTS OF RRA

1959 Lauris B. Whitman  
1962 Walter Kloetzli  
1965 Paul Mundy  
1967 George W. Kaslow, Jr.  
1971 Thomas G. Gannon  
1972 James E. Dittes  
1974 Earl D. Brewer  
1976 Ross P. Scherer  
1978 Barbara J.W. Hargrove  
1980 Dean Hoge  
1981 G. Douglass Lewis  
1982 David O. Moberg  
1983 Jackson W. Carroll  
1984 William McKinney  
1985 Constant H. Jacquet  
1987 Hart M. Nelson  
1989 James D. Davidson, Jr.  
1991 Wade Clark Roof  
1993 Peggy L. Shriver  
1995 Benton Johnson  
1997 Carl S. Dudley  
1999 Edward C. Lehman, Jr.  
2000 D. Paul Johnson  
2002 Nancy Nason-Clark  
2004 Daniel V.A. Olson  
2006 Kirk Hadaway  
2008 Keith Wulff  
2010 John P. Bartkowski  
2012 Joy Charlton  
2014 Jack Marcum  
2016 Scott Thumma  
2018 Patricia A. Wittberg  
2020 Melinda Denton

# SPONSORS

**THE SSSR AND RRA ARE GRATEFUL TO  
OUR ANNUAL MEETING SPONSORS!**

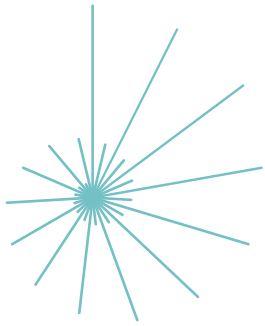

## JOHN TEMPLETON FOUNDATION

Founded in 1987, the John Templeton Foundation supports research and catalyzes conversations that inspire people with awe and wonder. We fund work on subjects ranging from black holes and evolution to creativity, forgiveness, and free will. We also encourage civil, informed dialogue among scientists, philosophers, theologians, and the public at large. Our aspiration is to help people create lives of meaning and purpose and to become a global catalyst for discoveries that contribute to human flourishing.



## Fetzer Institute

The Fetzer Institute's mission is to help build the spiritual foundation for a loving world. Learn more at [fetzer.org](http://fetzer.org). To learn more about the national spirituality study, visit [spiritualitystudy.org](http://spiritualitystudy.org)



## Louisville Institute

The Louisville Institute's mission is to bridge Church and academy through awarding grants and fellowships to those who lead and study North American religious institutions, practices, and movements, and thereby promoting scholarship that strengthens Church, academy, and society, and ultimately contributes to the flourishing of the Church.

## WILEY

Global Leader in Publishing Education and Research



# SSSR + RRA

**OCTOBER 20-22, 2023**

**Salt Lake Marriott Downtown at City Creek**

**SALT LAKE CITY, UTAH**